



AFTEC

2013

World Class Products,

For Safety, Quality & Reliability



	INTRODUCTION	01
	CU LUGS	02
	TERMINALS	20
	HEAT SHRINKABLES	40
	PVC TAPES	43
	CABLE TIES	44
	CABLE MARKERS	70
	GLANDS	72
	CLEATS	86



Aftec Electrical Solutions

Aftec international with its registered office in the British virgin Islands develops, manufactures and markets high quality products used in the electrical industry and are distributed worldwide. Aftec international is a leading manufacturer of heavy duty copper cable lugs, cable glands and other products designed under a quality system complying with the latest international standards and catering to a vast clientele worldwide and is committed to ensuring that it remains a number one choice in its markets. Aftec is a new generation company which strives for greater precision and perfection to maintain the highest standards and is committed to develop innovative features which sustain safety, versatility, reliability and ease of use of its products. Aftec is striving to develop a strategic alliance with distributors and end users across the globe in order to provide products that are accessible to a world class global distribution network. Its major aim is to maintain the technical excellence of existing products along with new product innovations and it is a symbol of AFTEC core competence that we continue to provide competitive solutions to our customers across the globe.

AFTEC's range of products embrace a wide and diverse variety of market sectors in conjunction with virtually every kind of electrical industrial applications. Aftec continues to grow through product and market diversification, innovation in technology and establishment of a strong international market presence.

Aftec ensures the highest quality standards are maintained with regular and rigorous in house testing for every product manufactured. At Aftec give the highest priority to safety and service quality, which has enhanced its reputation as a reliable provider in the market sectors. AFTEC have put in our best resources and efforts to make itself the best in the industry and we would be going to extraordinary levels to maintain the same efficiency and diligence in serving our clientele. To meet the challenges of our expanding networks and electrical markets worldwide aftec has invested extensively into manufacturing, logistics, sales and marketing operations world wide.

Aftec's product development strategy is **Safety, Quality, Versatility & Reliability**



CU LUGS

Aftec cu lugs solve your problem for difficult wire bending and terminating applications in confined power distribution panels and other enclosures. Aftec cu lugs are designed to obtain the highest electrical conductivity with maximum strength to resist vibration. Wide range of styles and sizes are available. Color coded lugs not only identify the correct installing die to be used for compressions, but also indicate the proper placement of the die on the lugs.

CU ONE HOLE LUGS

CU ONE HOLE LONG BARREL LUGS

CU BLANK LUGS

CU FOUR HOLE LUGS

CU ONE HOLE FLARED LUGS

CU PIN TYPE LUGS

CU ONE HOLE COLOR CODED LUGS

CU TWO HOLE COLOR CODED LUGS

CU TWO HOLE LONG BARREL COLOR CODED LUGS

CU FERRULES

Aftec cu ferrules are designed for joining conductors

CU FERRULES

CU LONG BARREL FERRULES

CU FLARED FERRULES

CU FERRULES COLOR CODED

CU LONG BARREL COLOR CODED FERRULES

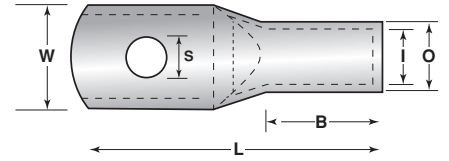

CU ONE HOLE LUGS

Aftec copper one hole lugs are manufactured from electrolytic copper tubes and are suitable for connection of copper conductors (section 1.5 mm² to 1000mm²) in power cable with the equipment. This are designed to obtain the highest electrical conductivity with maximum strength to resist vibration. The presence of an inspection hole assists the full insertion of the cable into the barrel.

Technical Data

- Application : For wire bending and terminating applications in confined power distribution panels and other enclosures.
- Material : 99.9% copper
- Plating : Electro tin plated
- Voltage : 600V to 1000 V

MODEL NO	DIMENSIONS						CABLE SIZE	
	S	L	B	W	I	O	mm ²	AWG
	MM	MM	MM	MM	MM	MM		
ACT 1.5-3	3	18	7	8.0	1.8	3.7	1.5	16
ACT 1.5-4	4	18	7	8.0	1.8	3.7	1.5	16
ACT 1.5-5*	5	18	7	8.0	1.8	3.7	1.5	16
ACT 1.5-6*	6	20	7	9.50	1.8	3.7	1.5	16
ACT 2.5-4*	4	18	7	8.50	2.4	4.0	2.5	14
ACT 2.5-5*	5	20	7	9.00	1.8	3.7	2.5	14
ACT 2.5-6*	6	20	7	9.50	1.8	3.7	2.5	14
ACT 2.5-8*	8	24	7	12.00	2.4	4.0	2.5	14
ACT 4-4	4	21	9	9.50	3.1	4.8	4	12
ACT 4-5*	5	22	9	9.50	3.1	4.8	4	12
ACT 4-6*	6	22	9	9.50	3.1	4.8	4	12
ACT 4-8*	8	26	9	12.00	3.1	4.8	4	12
ACT 6-5*	5	23	9	9.50	3.8	5.5	6	10
ACT 6-6*	6	27	9	11.00	3.8	5.5	6	10
ACT 6-8*	8	27	9	12.00	3.8	5.5	6	10
ACT 6-10*	10	32	9	15.00	3.8	5.5	6	10
ACT 10-5*	5	27	10	11.00	4.7	7.1	10	8
ACT 10-6*	6	27	10	11.00	4.7	7.1	10	8
ACT 10-8*	8	29	10	13.50	4.7	7.1	10	8
ACT 10-10*	10	32	10	15.00	4.7	7.1	10	8
ACT 10-12*	12	37	10	17.00	4.7	7.1	10	8
ACT 16-5	5	31	19	11.00	5.5	7.9	16	6
ACT 16-6*	6	37	19	11.00	5.5	7.9	16	6
ACT 16-8*	8	39	19	13.50	5.5	7.9	16	6
ACT 16-10*	10	41	19	15.00	5.5	7.9	16	6
ACT 16-12*	12	46	19	17.00	5.5	7.9	16	6
ACT 25-6*	6	41	21	13.50	7.1	9.5	25	4
ACT 25-8*	8	41	21	13.50	7.1	9.5	25	4

* UL LISTED

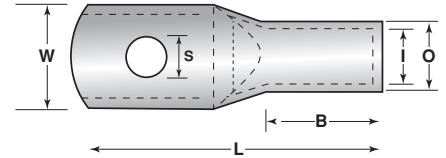

MODEL NO	DIMENSIONS						CABLE SIZE	
	S	L	B	W	I	O	mm ²	AWG
	MM	MM	MM	MM	MM	MM		
ACT 25-10*	10	44	21	15.50	7.1	9.5	25	4
ACT 25-12*	12	48	21	17.00	7.1	9.5	25	4
ACT 35-6*	6	44	21	15.50	8.2	11.2	35	2
ACT 35-8*	8	44	21	15.50	8.2	11.2	35	2
ACT 35-10*	10	46	21	16.00	8.2	11.2	35	2
ACT 35-12*	12	50	21	17.00	8.2	11.2	35	2
ACT 35-14	14	50	21	21.00	8.2	11.2	35	2
ACT 50-6*	6	48	22	18.00	9.5	12.8	50	1
ACT 50-8*	8	48	22	18.00	9.5	12.8	50	1
ACT 50-10*	10	48	22	18.00	9.5	12.8	50	1
ACT 50-12*	12	52	22	19.00	9.5	12.8	50	1
ACT 50-14	14	52	22	22.00	9.5	12.8	50	1
ACT 50-16	16	52	22	22.00	9.5	12.8	50	1
ACT 70-6*	6	54	24	21.00	11.2	14.7	70	2/0
ACT 70-8*	8	54	24	21.00	11.2	14.7	70	2/0
ACT 70-10*	10	54	24	21.00	11.2	14.7	70	2/0
ACT 70-12*	12	54	24	21.00	11.2	14.7	70	2/0
ACT 70-14	14	54	24	27.00	11.2	14.7	70	2/0
ACT 70-16*	16	64	24	27.00	11.2	14.7	70	2/0
ACT 70-20	20	64	20	27.00	11.2	14.7	70	2/0
ACT 95-6*	6	60	27	25.00	13.4	17.4	95	3/0
ACT 95-8*	8	60	27	25.00	13.4	17.4	95	3/0
ACT 95-10*	10	60	27	25.00	13.4	17.4	95	3/0
ACT 95-12*	12	60	27	25.00	13.4	17.4	95	3/0
ACT 95-14	14	60	27	26.00	13.4	17.4	95	3/0
ACT 95-16*	16	64	27	27.00	13.4	17.4	95	3/0
ACT 95-20	20	64	27	28.00	13.4	17.4	95	3/0
ACT 120-6*	6	64	30	29.00	15.6	20.6	120	4/0
ACT 120-8*	8	64	30	29.00	15.6	20.6	120	4/0
ACT 120-10*	10	64	30	29.00	15.6	20.6	120	4/0
ACT 120-12*	12	64	30	29.00	15.6	20.6	120	4/0
ACT 120-14	14	64	30	29.00	15.6	20.6	120	4/0
ACT 120-16*	16	68	30	29.00	15.6	20.6	120	4/0
ACT 120-20*	20	81	30	32.00	15.6	20.6	120	4/0
ACT 150-8	8	71	30	32.00	16.7	22.5	150	300 MCM
ACT 150-10*	10	71	30	32.00	16.7	22.5	150	300 MCM

* UL LISTED

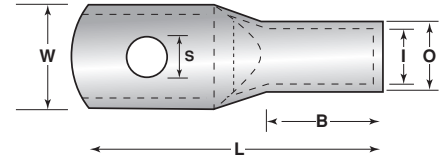

MODEL NO	DIMENSIONS						CABLE SIZE	
	S	L	B	W	I	O	mm ²	AWG
	MM	MM	MM	MM	MM	MM		
ACT 150-12*	12	80	30	32.00	16.7	22.5	150	300 MCM
ACT 150-14	14	80	30	32.00	16.7	22.5	150	300 MCM
ACT 150-16*	16	80	30	32.00	16.7	22.5	150	300 MCM
ACT 150-20*	20	80	30	32.00	16.7	22.5	150	300 MCM
ACT 185-10*	10	74	32	35.00	18.4	24.2	185	350 MCM
ACT 185-12*	12	83	32	35.00	18.4	24.2	185	350 MCM
ACT 185-14	14	83	32	35.00	18.4	24.2	185	350 MCM
ACT 185-16*	16	83	32	35.00	18.4	24.2	185	350 MCM
ACT 185-20*	20	84	32	38.00	18.4	24.2	185	350 MCM
ACT 240-10	10	92	38	40.00	21.2	28.2	240	500 MCM
ACT 240-12*	12	92	38	40.00	21.2	28.2	240	500 MCM
ACT 240-14	14	92	38	40.00	21.2	28.2	240	500 MCM
ACT 240-16	16	92	38	40.00	21.2	28.2	240	500 MCM
ACT 240-20	20	92	38	40.00	21.2	28.2	240	500 MCM
ACT-300-10	10	101	42	45.00	23.5	31.3	300	600 MCM
ACT-300-12*	12	101	42	45.00	23.5	31.3	300	600 MCM
ACT-300-14	14	101	42	45.00	23.5	31.3	300	600 MCM
ACT-300-16	16	101	42	45.00	23.5	31.3	300	600 MCM
ACT-300-20	20	101	42	45.00	23.5	31.3	300	600 MCM
ACT-400-10	10	116	44	50.00	26.8	34.8	400	750 MCM
ACT-400-12	12	116	44	50.00	26.8	34.8	400	750 MCM
ACT-400-14	14	116	44	50.00	26.8	34.8	400	750 MCM
ACT-400-16	16	116	44	50.00	26.8	34.8	400	750 MCM
ACT-400-20	20	116	44	50.00	26.8	34.8	400	750 MCM
ACT 500-12	12	126	50	55.50	30	39	500	1000 MCM
ACT 500-14	14	126	50	55.50	30	39	500	1000 MCM
ACT 500-16	16	126	50	55.50	30	39	500	1000 MCM
ACT 500-20	20	126	50	55.50	30	39	500	1000 MCM
ACT 630-14	14	146	51	63.50	30.5	44.7	630	1235 MCM
ACT 630-16	16	146	51	64.50	35	44.7	630	1235 MCM
ACT 630-20	20	146	51	64.50	35	44.7	630	1235 MCM
ACT 800-14	14	171	77	72.50	39	50.6	800	1580 MCM
ACT 800-18	18	171	77	70.90	39	50.6	800	1580 MCM
ACT 800-20	20	171	77	72.50	39	50.6	800	1580 MCM
ACT 1000-20	20	202	90	80.5	43	56.2	1000	1975 MCM

* UL LISTED

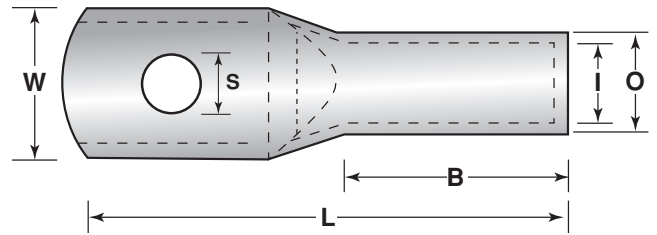

CU ONE HOLE LONG BARREL LUGS

Aftec copper one hole long barrel lugs are manufactured from high conductivity seamless copper tubing. Long barrel maximizes number of crimps for added mechanical strength and electrical performance which can be used for high voltage application up to 33 KV provided proper high voltage insulation methods are used. The absence of an inspection hole prevents the entry of water or moisture into the crimped barrel.

Technical Data.

Application : For wire bending and terminating applications, ideal for industrial oil rigs, welding and transportation.

Material : 99.9% Copper

Plating : Electro tin plated

Voltage : 0.6 KV to 33 KV

MODEL NO	DIMENSIONS						CABLE SIZE	
	S	L	B	W	I	O	mm ²	AWG
	MM	MM	MM	MM	MM	MM		
ACT 6- 5 HV*	5	30.5	10	9.00	3.8	5.5	6	8
ACT 6- 6 HV*	6	31.5	10	9.50	3.8	5.5	6	8
ACT 6- 8 HV*	8	34.0	10	12.00	3.8	5.5	6	8
ACT 10- 5 HV*	5	34.0	10	9.00	4.5	6.0	10	6
ACT 10- 6 HV*	6	34.5	10	9.50	4.5	6.0	10	6
ACT 10- 8 HV*	8	37.0	10	12.00	4.5	8.5	10	6
ACT 16- 6 HV*	6	43.5	20	12.00	5.5	8.5	16	6
ACT 16- 8 HV*	8	46.0	20	12.00	5.5	8.5	16	6
ACT 16- 10 HV*	10	48.0	20	15.00	5.5	8.5	16	6
ACT 16- 12 HV*	12	49.0	20	17.00	5.5	10.0	16	6
ACT 25- 6 HV*	6	45.5	20	14.00	7.0	10.0	25	4
ACT 25- 8 HV*	8	48.0	20	14.00	7.0	10.0	25	4
ACT 25- 10 HV*	10	50.0	20	16.00	7.0	10.0	25	4
ACT 25- 12 HV*	12	51.0	20	17.00	7.0	12.5	25	4
ACT 35- 6 HV*	6	49.5	20	17.00	8.2	12.5	35	2
ACT 35- 8 HV*	8	52.0	20	17.00	8.2	12.5	35	2
ACT 35- 10 HV*	10	54.0	20	17.00	8.2	12.5	35	2
ACT 35- 12 HV*	12	55.0	20	18.00	8.2	12.5	35	2
ACT 35 - 14 HV*	14	56.5	20	21.00	8.2	14.5	35	2
ACT 50 -8 HV*	8	62.0	28	20.00	10.0	14.5	50	1
ACT 50 -10 HV*	10	64.0	28	20.00	10.0	14.5	50	1
ACT 50 -12 HV*	12	65.0	28	20.00	10.0	14.5	50	1
ACT 50 -14 HV*	14	66.5	28	20.00	10.0	14.5	50	1
ACT 50 -16 HV*	16	68.0	28	25.00	10.0	16.5	50	1
ACT 70 -8 HV*	8	65.0	28	24.00	11.5	16.5	70	2/0
ACT 70 -10 HV*	10	67.0	28	24.00	11.5	16.5	70	2/0
ACT 70 - 12 HV*	12	68.0	28	24.00	11.5	16.5	70	2/0

* UL LISTED
HV- HIGH VOLTAGE

MODEL NO	DIMENSIONS						CABLE SIZE	
	S	L	B	W	I	O	mm ²	AWG
	MM	MM	MM	MM	MM	MM		
ACT 70 - 14 HV*	14	69.5	28	24.00	11.5	16.5	70	2/0
ACT 70 - 16 HV*	16	71.0	28	27.00	11.5	16.5	70	2/0
ACT 95 - 8 HV*	8	77.0	35	27.00	13.5	19.0	95	3/0
ACT 95 - 10 HV*	10	77.0	35	27.00	13.5	19.0	95	3/0
ACT 95 - 12 HV*	12	78.0	35	27.00	13.5	19.0	95	3/0
ACT 95 - 14 HV*	14	79.5	35	27.00	13.5	19.0	95	3/0
ACT 95 - 16 HV*	16	81.0	35	27.00	13.5	19.0	95	3/0
ACT 120 - 10 HV*	10	85.0	35	30.50	15.5	21.0	120	250 MCM
ACT 120 - 12 HV*	12	86.0	35	30.00	15.5	21.0	120	250 MCM
ACT 120 - 14 HV*	14	88.0	35	30.00	15.5	21.0	120	250 MCM
ACT 120 - 16 HV*	16	89.0	35	30.00	15.5	21.0	120	250 MCM
ACT 120 - 20 HV*	20	91.0	35	30.00	15.5	21.0	120	250 MCM
ACT 150 - 10 HV*	10	93.0	35	34.00	15.5	23.5	150	300 MCM
ACT 150 - 12 HV*	12	94.0	35	34.00	17.0	23.5	150	300 MCM
ACT 150 - 14 HV*	14	97.0	35	34.00	17.0	23.5	150	300 MCM
ACT 150 - 16 HV*	16	97.0	35	34.00	17.0	23.5	150	300 MCM
ACT 150 - 20 HV*	20	99.0	35	34.00	17.0	23.5	150	300 MCM
ACT 185 - 10 HV*	10	97.0	40	37.00	17.0	25.5	185	400 MCM
ACT 185 - 12 HV*	12	98.0	40	37.00	19.0	25.5	185	400 MCM
ACT 185 - 14 HV*	14	101.0	40	37.00	19.0	25.5	185	400 MCM
ACT 185 - 16 HV*	16	101.0	40	37.00	19.0	25.5	185	400 MCM
ACT 185 - 20 HV*	20	103.0	40	37.00	19.0	25.5	185	400 MCM
ACT 240 - 12 HV*	12	108.0	40	42.00	19.0	29.0	240	500 MCM
ACT 240 - 14 HV*	14	111.0	40	42.00	21.5	29.0	240	500 MCM
ACT 240 - 16 HV*	16	111.0	40	42.00	21.5	29.0	240	500 MCM
ACT 240 - 20 HV*	20	113.0	40	42.00	21.5	29.0	240	500 MCM
ACT 300 - 14 HV*	14	119.0	50	46.50	21.5	32.0	300	600 MCM
ACT 300 - 16 HV*	16	119.0	50	46.50	24.5	32.0	300	600 MCM
ACT 300 - 20 HV*	20	122.0	50	46.50	24.5	32.0	300	600 MCM
ACT 400 - 14 HV*	14	140.0	70	54.00	27.5	38.5	400	750 MCM
ACT 400 - 16 HV*	16	140.0	70	54.00	27.5	38.5	400	750 MCM
ACT 400 - 20 HV*	20	140.0	70	54.00	27.5	38.5	400	750 MCM
ACT 500 - 14 HV	14	150.0	70	60.00	31.0	42.0	500	1000 MCM
ACT 500 - 16 HV	16	150.0	70	60.00	31.0	42.0	500	1000 MCM
ACT 500 - 20 HV	20	150.0	70	60.00	31.0	42.0	500	1000 MCM
ACT 630 - 16 HV	16	160.0	80	60.00	34.5	44.0	630	1235 MCM
ACT 630 - 20 HV	20	160.0	80	60.00	34.5	44.0	630	1235 MCM
ACT 800 - 14 HV	14	195.0	100	75.00	40.0	52.0	800	1580 MCM
ACT 800 - 16 HV	16	195.0	100	75.00	40.0	52.0	800	1580 MCM
ACT 800 - 18 HV	18	195.0	100	75.00	40.0	52.0	800	1580 MCM
ACT 800 - 20 HV	20	195.0	100	75.00	40.0	52.0	800	1580 MCM
ACT 1000 - 16 HV	16	195.0	100	85.00	44.0	58.0	1000	1975 MCM
ACT 1000 - 20 HV	20	195.0	100	85.00	44.0	58.0	1000	1975 MCM

* UL LISTED
HV- HIGH VOLTAGE

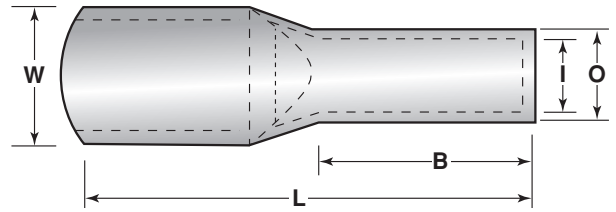

CU BLANK LUGS

Aftec copper blank lugs are manufactured from high voltage conductivity seamless copper tubing. Long barrel maximizes number of crimps for added mechanical strength and electrical performance which can be used for high and voltage application up to 1000 V provided proper high voltage insulation methods are used.

Technical Data

Application : For outdoor applications like industries oil rigs welding and transportation.

Material : 99.9% Copper

Plating : Electro tin plated

Voltage : 600V to 1000V & 33 KV available on request

MODEL NO	DIMENSIONS						CABLE SIZE	
	S	L	B	W	I	O	mm ²	AWG
	MM	MM	MM	MM	MM	MM		
ACT 10-BL	BLANK	37	10	17.00	4.7	7.1	10	8
ACT 16-BL	BLANK	46	19	17.00	5.5	7.9	16	6
ACT 25-BL	BLANK	48	21	17.00	7.1	9.5	25	4
ACT 35-BL	BLANK	50	21	17.00	8.2	11.2	35	2
ACT 50-BL	BLANK	52	22	22.00	9.5	12.8	50	1
ACT 70-BL	BLANK	64	20	27.00	11.2	14.7	70	2/0
ACT 95-BL	BLANK	64	27	28.00	13.4	17.4	95	3/0
ACT 120-BL	BLANK	81	30	32.00	15.6	20.6	120	4/0
ACT 150-BL	BLANK	80	30	32.00	16.7	22.5	150	300 MCM
ACT 185-BL	BLANK	84	32	38.00	18.4	24.2	185	350 MCM
ACT 240-BL*	BLANK	92	38	40.00	21.2	28.2	240	500 MCM
ACT-300-BL*	BLANK	101	42	45.00	23.5	31.3	300	600 MCM
ACT-400-BL*	BLANK	116	44	50.00	26.8	34.8	400	750 MCM
ACT 500BL	BLANK	126	50	55.50	30	39	500	1000 MCM
ACT 630-BL	BLANK	146	51	64.50	35	44.7	630	1235 MCM
ACT 800-BL	BLANK	171	77	72.50	39	50.6	800	1580 MCM
ACT 1000-BL	BLANK	202	90	80.5	43	56.2	1000	1975 MCM

* UL -LISTED

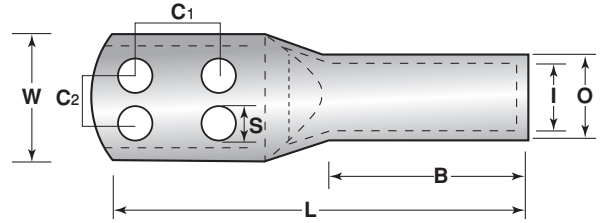

CU FOUR HOLE LUGS

Aftec copper four hole lugs are manufactured from high voltage conductivity seamless copper tubing. The presence of an inspection hole assists the full insertion of the cable into the barrel.

Technical Data

Application : For wire bending and terminating applications. In confined power distribution transformers and panels.

Material : 99.9% Copper

Plating : Electro tin plated

Voltage : 600 V to 1000 V

MODEL NO	DIMENSIONS								CABLE SIZE	
	S	L	B	W	I	O	C1	C2	mm ²	AWG
	MM	MM	MM	MM	MM	MM	MM	MM		
ACT 300-4H	8.5	115	42	58.0	23.5	30	16.3	16.3	300	600 MCM
ACT 400-4H	8.5	120	44	58.0	26.8	34.8	16.3	16.3	400	750 MCM
ACT 500-4H	8.5	124	48	56.0	30	39	16.3	16.3	500	1000 MCM
ACT 630-4H	8.5	144	56	65.0	35	45	20.3	20.3	630	1235 MCM
ACT 800-4H	8.5	171	77	71.50	39	50.6	30	30	800	1580 MCM
ACT 1000-4H	8.5	202	90	80.5	43	56.2	40	40	1000	1975 MCM

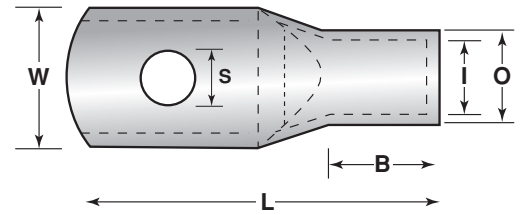

CU ONE HOLE FLARED LUGS

Aftec copper flared lugs are manufactured from high conductivity seamless copper tubing. Flared entry prevents back bend strands when inserting multi strand cables into barrel. The presence of an inspection hole assists the full insertion of the cable into the barrel.

Technical Data

Material : 99.9% Copper.

Plating : Electro tin plated.

Voltage : 600 V to 1000 V

MODEL NO	DIMENSIONS						CABLE SIZE	
	S	L	B	W	I	O	mm ²	AWG
	MM	MM	MM	MM	MM	MM		
ACT 10-5F*	5	36.50	13.97	11.58	4.72	6.35	10	8
ACT 10-6F*	6	36.50	13.97	11.58	4.72	6.35	10	8
ACT 10-8F*	8	36.50	13.97	11.58	4.72	6.35	10	8
ACT 10-10F*	10	41.00	13.97	14.48	4.72	6.35	10	8
ACT 10-12F*	12	48.00	13.97	16.50	4.72	6.35	10	8
ACT 16-5F*	5	32.64	13.97	13.72	5.89	7.92	16	6
ACT 16-6F*	6	32.64	13.97	13.72	5.89	7.92	16	6
ACT 16-8F*	8	32.64	13.97	13.72	5.89	7.92	16	6
ACT 16-10F*	10	32.64	13.97	15.00	5.89	7.92	16	6
ACT 16-12F*	12	42.55	13.97	16.50	5.89	7.92	16	6
ACT 25-5F*	8	40.64	14.73	13.72	7.14	9.04	25	4
ACT 25-6F*	6	40.64	14.73	13.72	7.14	9.04	25	4
ACT 25-8F*	8	40.64	14.73	13.72	7.14	9.04	25	4
ACT 25-10F*	10	40.64	14.73	14.48	7.14	9.04	25	4
ACT 25-12F*	12	40.64	14.73	16.50	7.14	9.04	25	4
ACT 35-6F*	6	45.40	17.50	16.51	8.43	10.67	35	2
ACT 35-8F*	8	45.40	17.50	16.51	8.43	10.67	35	2
ACT 35-10F*	10	45.40	17.50	16.51	8.43	10.67	35	2
ACT 35-12F*	12	45.40	17.50	16.51	8.43	10.67	35	2
ACT 35-6HF*	6	46.00	18.00	16.70	8.94	11.18	35	2
ACT 35-8HF*	8	46.00	18.00	16.70	8.94	11.18	35	2
ACT 35-10HF*	10	46.00	18.00	16.70	8.94	11.18	35	2
ACT 35-12HF*	12	46.00	18.00	16.70	8.94	11.18	35	2
ACT 50-6F*	6	49.50	19.30	18.50	10.19	12.65	50	1
ACT 50-8F*	8	49.50	19.30	18.50	10.19	12.65	50	1
ACT 50-10F*	10	49.50	19.30	18.50	10.19	12.65	50	1
ACT 50-12F*	12	49.50	19.30	18.50	10.19	12.65	50	1
ACT 70-6F*	6	57.00	21.00	20.83	11.58	14.22	70	2/0
ACT 70-8F*	8	57.00	21.00	20.83	11.58	14.22	70	2/0
ACT 70-10F*	10	57.00	21.00	20.83	11.58	14.22	70	2/0
ACT 70-12F*	12	57.00	21.00	20.83	11.58	14.22	70	2/0
ACT 95-6F*	6	59.00	21.46	22.96	12.93	15.62	95	3/0
ACT 95-12F*	12	59.00	21.46	22.96	12.93	15.62	95	3/0
ACT 120-10F*	10	66.29	23.11	26.31	14.94	17.63	120	4/0
ACT 120-12F*	12	66.29	23.11	26.31	14.94	17.63	120	4/0

* UL LISTED

H - HIGH VOLTAGE

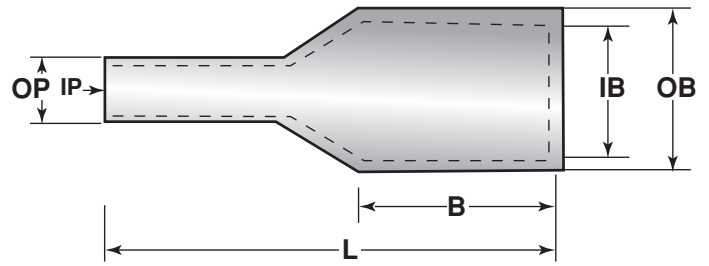

CU PIN TYPE LUGS

Aftec copper pin type lugs are manufactured from High Conductivity seamless copper tubing. The barrel enhances mechanical and electrical performance and pin may be inserted in copper connectors for terminating conductors.

Technical Data

Material : 99.9% Copper

Plating : Electro tin plated

Voltage : 600 V to 1000 V & 33 KV available on request

MODEL NO	DIMENSIONS						CABLE SIZE	
	L	B	IB	OB	IP	OP	mm ²	AWG
	MM	MM	MM	MM	MM	MM		
ACP-4	20	6	2.8	4.7	3.3	3.8	4	12
ACP-6	20	6	3.1	4.7	4	4.5	6	10
ACP-10	23	9	3.8	5.5	4	4.5	10	8
ACP-16	32	12	5.3	7.1	5.5	6	16	6
ACP-25	32	12	7	9	5.5	6	25	4
ACP-35	37	12	8	10	6.5	7.5	35	2
ACP-50	41	16	9.2	11.2	6.5	7.5	50	1
ACP-70	43	18	11.5	13.8	6.5	7.5	70	2/0
ACP-95	51	20	12.8	15.6	10.5	11.5	95	3/0
ACP-120	50	22	14.8	17.8	6.5	7.5	120	4/0
ACP-150	64	26	16	19.6	14	15.6	150	300 MCM
ACP-185	70	32	18	22	14	15.6	185	350 MCM
ACP-240	88	38	22	26	15	16	240	500 MCM
ACP-300	92	42	24	28.7	15	16	300	600 MCM
ACP-400	90	46	27	33.2	14	16	400	750 MCM
ACP-500	98.23	52.41	30.7	36	13.85	15.95	500	1000 MCM
ACP-630	102	56.45	35.3	41.7	14.1	15.97	630	1235 MCM

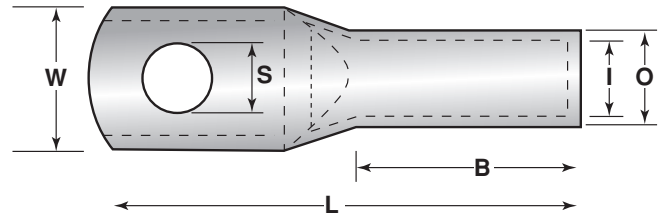

CU ONE HOLE COLOR CODED LUGS

Aftec copper one hole color coded lugs are manufactured from high conductivity seamless copper tubing. Color coding are for proper matching of dies and cable sizing. Crimping is made between or on these color bands. The presence of an inspection hole assists the full insertion of the conductor into the barrel.

Technical Data

Application : For wire bending and terminating application confined power distribution panels and other enclosures.

Material : 99.9% Copper

Plating : Electro tin plated

Marking : Color matches die and cable size

Voltage : 600 V to 1000 V

MODEL NO	COLOR	DIMENSIONS						CABLE SIZE	
		S	L	B	W	I	O	mm ²	AWG
		MM	MM	MM	MM	MM	MM		
ACT 10-6 HVCC*	RED	6	28.50	10.01	11.99	4.70	7.01	10	8
ACT 10-8 HVCC*		8	35.00	10.01	13.00	4.70	7.01	10	8
ACT 10-10 HVCC*		10	38.99	10.01	15.00	4.70	7.01	10	8
ACT 10-12 HVCC*		12	42.01	10.01	17.00	4.70	7.01	10	8
ACT 16-6 HVCC*	BLUE	6	33.25	13.00	11.99	5.41	8.51	16	6
ACT 16-8 HVCC*		8	37.49	13.00	14.00	5.41	8.51	16	6
ACT 16-10 HVCC*		10	41.50	13.00	15.00	5.41	8.51	16	6
ACT 16-12 HVCC*		12	44.98	13.00	17.00	5.41	8.51	16	6
ACT 25-6 HVCC*	GREY	6	37.49	15.01	14.00	6.96	10.01	25	4
ACT 25-8 HVCC*		8	42.01	15.01	17.00	6.96	10.01	25	4
ACT 25-10 HVCC*		10	46.00	15.01	16.00	6.96	10.01	25	4
ACT 25-12 HVCC*		12	48.01	15.01	17.00	6.96	10.01	25	4
ACT 35-6 HVCC*	PINK	6	47.02	20.00	20.00	9.88	14.00	35	2
ACT 35-8 HVCC*		8	47.02	20.00	20.00	9.88	14.00	35	2
ACT 35-10 HVCC*		10	51.00	20.00	19.99	9.88	14.00	35	2
ACT 35-12 HVCC*		12	56.01	20.00	21.00	9.88	14.00	35	2
ACT 50-6 HVCC*	BLACK	6	50.01	20.00	22.00	11.38	15.49	50	1
ACT 50-8 HVCC*		8	50.01	20.00	22.00	11.38	15.49	50	1
ACT 50-10 HVCC*		10	54.00	20.00	22.00	11.38	15.49	50	1
ACT 50-12 HVCC*		12	58.01	20.00	23.01	11.38	15.49	50	1
ACT 70-8 HVCC*	ORANGE	8	52.40	21.01	23.01	11.94	16.51	70	2/0
ACT 70-10 HVCC*		10	55.01	21.01	23.01	11.94	16.51	70	2/0
ACT 70-12 HVCC*		12	59.00	21.01	23.01	11.94	16.51	70	2/0
ACT 95-10 HVCC*	PURPLE	10	59.99	24.99	26.01	13.39	18.01	95	3/0
ACT 95-12 HVCC*		12	62.00	24.99	26.01	13.39	18.01	95	3/0
ACT 120-10 HVCC*	YELLOW	10	65.00	26.01	27.99	15.06	19.51	120	4/0
ACT 120-12 HVCC*		12	65.00	26.01	27.99	15.06	19.51	120	4/0

* UL LISTED

CU LUGS

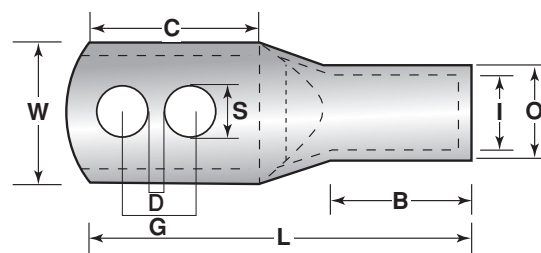

CU TWO HOLE COLOR CODED LUGS

Aftec copper two hole color coded lugs are manufactured from high conductivity seamless copper tubing. Short barrel lugs are ideal for confined area. Color coding are for proper matching of dies and cable sizing.

Technical Data

Application : Short barrel lugs designed for regular duty with limited space application.

Material : 99.9% Copper

Plating : Electro tin plated

Marking : Color matches die and cable size.

Voltage : 600 V to 1000 V

MODEL NO.	COLOR	DIMENSIONS									CABLE SIZE	
		S	L	B	W	I	O	C	D	G	mm ²	AWG
		MM	MM	MM	MM	MM	MM	MM	MM	MM		
ACT 10-2x5CC *	RED	5.3	46.2	11.2	10.7	4.4	6.9	15.90	3.0	7.1	10	8
ACT 16-2x6CC *	BLUE	6.4	53	18	10.7	5.2	7.5	15.90	3.0	7.1	16	6
ACT 16-2x6LCC *		6.4	67	18	10.7	5.2	7.5	25.40	3.0	7.1	16	6
ACT 16-2x10CC *	GREY	10.5	67	18	14.5	5.2	7.5	25.40	3.0	9.7	16	6
ACT 25-2x6CC *		6.4	53	18	12.4	6.4	8.7	15.90	3.0	7.1	25	4
ACT 25-2x6LCC *		6.4	68	19	12.4	6.4	8.7	25.40	3.0	7.1	25	4
ACT 25-2x10CC *	BROWN	10.5	68	19	14.5	6.4	8.7	25.40	3.0	9.7	25	4
ACT 35-2x8CC *		8.4	66.6	21	15.3	8	10.7	19.10	4.0	8.1	35	2
ACT 35-2x6CC *		6.4	58	21	15.3	8	10.7	15.90	4.0	7.1	35	2
ACT 35-2x10CC *		10.5	72	21	15.3	8	10.7	25.40	4.0	7.1	35	2
ACT 35-2x6LCC *	GREEN	6.4	60	21	15.3	8	10.7	19.10	4.0	7.1	35	2
ACT 35-2x6XLCC *		6.4	71	21	15.3	8	10.7	25.40	4.0	7.1	35	2
ACT 35H-2x6CC *		6.4	58	21	17.1	9.1	11.9	15.90	4.0	7.1	35	2
ACT 50-2x8CC *	PINK	8.4	67.1	21	18.9	9.9	13.2	22.20	5.0	8.1	50	1
ACT 50-2x10CC *	BLACK	10.5	72	21	18.9	9.9	13.2	25.40	5.0	9.7	50	1
ACT 70-2x10CC *		10.5	76	24	20.7	11.2	14.3	25.40	6.0	9.7	70	2/0
ACT 70-2x12CC *	ORANGE	13	106	24	20.7	11.2	14.3	44.50	6.0	15.7	70	2/0
ACT 95-2x12CC *		13	109	25	22.9	12.5	15.8	44.50	8.0	15.7	95	3/0
ACT 95-2x10CC *	PURPLE	10.5	79	25	22.9	12.5	15.8	25.40	8.0	9.7	95	3/0
ACT 95H-2x12CC *		13	109	25	25.4	13.9	17.5	44.50	8.0	15.7	95	3/0
ACT 95H-2x10CC *		10.5	79	25	25.4	13.9	17.5	25.40	8.0	9.7	95	3/0
ACT 120-2x12CC *	YELLOW	13	112	27	27.7	15.1	19.1	44.50	8.0	15.7	120	4/0
ACT 120-2x10CC *		10.5	82	27	27.7	15.1	19.1	25.40	8.0	9.7	120	4/0
ACT 150-2x12CC *	WHITE	13	112	27	30.2	16.7	20.7	44.50	9.0	15.7	150	300 MCM
ACT 150H-2x12CC *	RED	13	115	28	32.4	17.8	22.2	44.50	9.0	15.7	150	300 MCM
ACT 150H-2x10CC *		10.5	85	28	32.4	17.8	22.2	25.40	9.0	9.7	150	300 MCM
ACT 185-2x12CC *	BLUE	13	119	30	35.2	19.4	24.1	44.50	11.0	15.7	185	350 MCM
ACT 185-2x12LCC *		13	122	30	35.7	19.4	24.1	44.50	11.0	15.7	185	350 MCM
ACT 240-2x12CC *	BROWN	13	124	35	39.1	21.3	27	44.50	13.0	15.7	240	500 MCM
ACT 240-2x10CC *		10.5	94	35	39.1	21.3	27	25.40	13.0	9.7	240	500 MCM
ACT 300-2x12CC *	GREEN	13	126	38	43.6	23.5	30.2	44.50	14.0	15.7	300	600 MCM
ACT 300-2x12LCC *		13	128	38	43.6	23.5	30.2	44.50	14.0	15.7	300	600 MCM
ACT 300-2x12XLCC *		13	129	35	43.7	23.5	30.2	44.50	14.0	15.7	300	600 MCM
ACT 300-2x10CC *	PINK	10.5	104	36	43.7	23.5	30.2	25.40	21.0	9.7	300	600 MCM
ACT 300H-2x12CC *		13	129	35	45.2	24.75	31.5	44.50	21.0	15.7	300	600 MCM
ACT 400-2x12CC *		BLACK	13	140	47	48.3	26.5	33.3	44.50	17.0	15.7	400

* UL LISTED

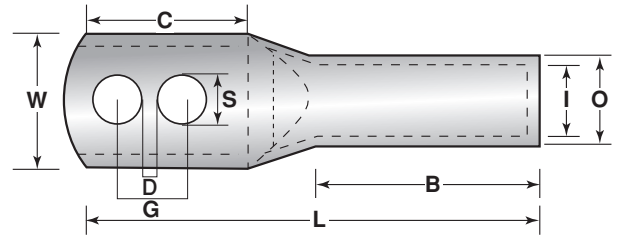

CU TWO HOLE LONG BARREL COLOR CODED LUGS

Aftec copper two hole long barrel color coded lugs are manufactured from high conductivity seamless copper tubing. Long barrel maximizes number of crimps for added mechanical strength and electrical performance which can be used for high voltage insulation up to 33 KV provided high voltage insulation methods are used. Color coding are for proper matching of dies and cable sizing. The absence of an inspection hole prevents the entry of water or moisture into the crimped joint.

Technical Data

Application : For wire bending and terminating application, Ideal for industries, Oil rigs welding and transportation.

Material : 99.9% Copper

Plating : Electro tin plated

Marking : Color matches die and cable size

Voltage : 0.6 KV to 33 KV

MODEL NO.	COLOR	DIMENSIONS									CABLE SIZE	
		S	L	B	W	I	O	C	D	G	mm ²	AWG
ACT 10-2X5 LBCC *	RED	5.3	55.5	20.5	10.7	4.4	6.9	15.90	3.0	7.1	10	8
ACT 10-2X6 LBCC *		6.4	55.5	20.5	10.7	4.4	6.9	15.90	3.0	7.1	10	8
ACT 16-2X6 LBCC *	BLUE	6.4	57	25	10.7	5.2	7.5	12.70	3.0	7.1	16	6
ACT 16-2X12 LBCC *		13	104	25	18.0	5.2	7.5	44.50	3.0	15.7	16	6
ACT 16-2X10LBCC *		10.5	74	25	10.7	5.2	7.5	25.40	3.0	9.7	16	6
ACT 25-2X6 LBCC *	GREY	6.4	60	25	12.4	6.4	8.7	15.90	3.0	7.1	25	4
ACT 25-2X10 LBCC *		10.5	75	25	10.7	6.4	8.7	25.40	3.0	9.7	25	4
ACT 25-2X12 LBCC *		13	104	25	22	6.4	8.7	44.50	3.0	15.7	25	4
ACT 35-2X8 LBCC *	BROWN	8.4	73	28	15.3	8	10.7	19.10	4.0	8.1	35	2
ACT 35-2X10 LBCC *		10.5	78	28	15.3	8	10.7	25.40	4.0	9.7	35	2
ACT 35-2X6 LBCC *		6.4	64	28	15.3	8	10.7	15.90	4.0	7.1	35	2
ACT 35-2X12 LBCC *		13	108	28	20.5	8	10.7	44.50	4.0	15.7	35	2
ACT 70-2X10 LBCC *	BLACK	10.5	87	35	20.7	11.2	14.3	25.40	6.0	9.7	70	2/0
ACT 70-2X6 LBCC *		6.4	76	35	20.7	11.2	14.3	19.10	6.0	7.1	70	2/0
ACT 70-2X12 LBCC *		13	117	35	20.7	11.2	14.3	44.50	6.0	15.7	70	2/0
ACT 95-2X8 LBCC *	ORANGE	8.4	89	35	22.9	12.5	15.8	25.40	8.0	8.1	95	3/0
ACT 95-2X10 LBCC *		10.5	89	35	22.9	12.5	15.8	25.40	8.0	9.7	95	3/0
ACT 95-2X12 LBCC *		13	118	35	22.9	12.5	15.8	44.50	8.0	15.7	95	3/0
ACT 120-2X10 LBCC *	YELLOW	10.5	96	41	27.7	15.1	19.1	25.40	9.0	9.7	120	4/0
ACT 120-2X12 LBCC *		13	126	41	27.7	15.1	19.1	44.50	9.0	15.7	120	4/0
ACT 150-2X12 LBCC *	WHITE	13	135	50	30.2	16.7	20.7	44.50	9.0	15.7	150	300 MCM
ACT 150H-2X10 LBCC *	RED	10.5	107	50	32.4	17.8	22.2	25.40	11.0	9.7	150	350 MCM
ACT 185-2X12 LBCC *	BLUE	13	139	50	35.2	19.4	24.1	44.50	13.0	15.7	185	350 MCM
ACT 240-2X12 LBCC *	BROWN	13	146	57	39.1	21.3	27	44.50	13.0	15.7	240	500 MCM
ACT 240-2X10 LBCC *		10.5	116	57	39.1	21.3	27	25.40	13.0	9.7	240	500 MCM
ACT 300-2X12 LBCC *	GREEN	13	147	57	43.6	23.5	30.2	44.50	14.0	15.7	300	600 MCM
ACT 300-2X10 LBCC *		10.5	117	57	43.6	23.5	30.2	25.40	14.0	9.7	300	600 MCM
ACT 400-2X12 LBCC *	BLACK	13	160	67	48.3	26.5	33.3	44.50	17.0	15.7	400	750 MCM
ACT 400-2X10 LBCC *		10.5	130	67	48.3	26.5	33.3	25.40	17.0	9.7	400	750 MCM

* UL LISTED

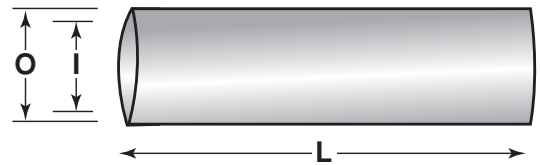

CU FERRULES

Aftec copper ferrules are manufactured from high conductivity seamless copper tubing. Short barrel are used for limited space applications which features an internal taper of wires at both ends and are easy to insulate with low installation cost.

Technical Data

Application : For regular duty application, to join broken cable or extend cables.

Material : 99.9% Copper

Plating : Electro tin plated

Voltage : 600 V to 1000 V

MODEL NO	DIMENSIONS			CABLE SIZE	
	L	I	O	mm ²	AWG
	MM	MM	MM		
ACS 1.5-22*	22	1.8	3.7	1.5	16
ACS 2.5-22*	22	2.4	4.0	2.5	14
ACS 4-22*	22	3.1	4.8	4	12
ACS 6-22*	22	3.8	5.5	6	10
ACS 10-22*	22	4.7	7.1	10	8
ACS 16-44*	44	5.5	7.9	16	6
ACS 25-48*	48	7.1	9.5	25	4
ACS 35-48*	48	8.2	11.2	35	2
ACS 50-48*	48	9.5	12.8	50	1
ACS 70-52*	52	11.2	14.7	70	2/0
ACS 95-54*	54	13.4	17.4	95	3/0
ACS 120-66*	66	15.6	20.6	120	4/0
ACS 150-66*	66	16.7	22.5	150	300 MCM
ACS 185-66*	66	18.4	24.2	185	350 MCM
ACS 240-91*	91	21.2	28.2	240	500 MCM
ACS 300-91*	91	23.5	31.3	300	600 MCM
ACS 400-91*	91	26.8	34.8	400	750 MCM
ACS 500-100	100	30	39	500	1000 MCM
ACS 630-120	120	35	45	630	1235 MCM
ACS 800-150	150	39	50.6	800	1580 MCM
ACS 1000-170	170	43	56.2	1000	1975 MCM

* UL LISTED

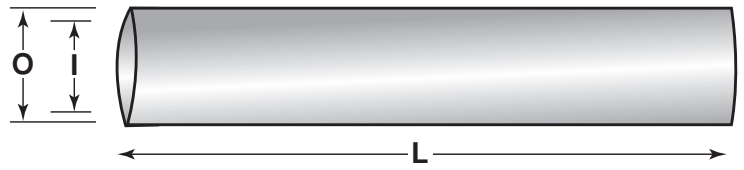

CU LONG BARREL FERRULES

Aftec copper long barrel ferrules are manufactured from high conductivity seamless copper tubing. Long barrel maximizes number of crimps for added mechanical strength and electrical performance which can be used for high voltage insulation up to 33 KV, provided proper high voltage insulation methods are used. It features an internal taper of wires at both ends and easy to install.

Technical Data

Application : Heavy duty designs permits maximum crimps ideal for oil rigs, welding & transportation termination applications.

Material : 99.9% Copper

Plating : Electro tin plated

Voltage : 0.6 KV to 33 KV

MODEL NO	DIMENSIONS			CABLE SIZE	
	L	I	O	mm ²	AWG
	MM	MM	MM		
ACS 16-50 HV*	50	5.5	8.5	16	6
ACS 25-50 HV*	50	7.0	10.0	25	4
ACS 35-50 HV*	50	8.2	12.5	35	2
ACS 50-56 HV*	56	10.0	14.5	50	1
ACS 70-56 HV*	56	11.5	16.5	70	2/0
ACS 95-70 HV*	70	13.5	19.0	95	3/0
ACS 120 -70HV*	70	15.5	21.0	120	4/0
ACS 150 -80HV*	80	17.0	23.5	150	300 MCM
ACS 185 -85HV*	85	19.0	25.5	185	350 MCM
ACS 240-90 HV*	90	21.5	29.0	240	500 MCM
ACS 300-100 HV*	100	24.5	32.0	300	600 MCM
ACS 400-150 HV*	150	27.5	38.5	400	750 MCM

* UL LISTED
HV- HIGH VOLTAGE

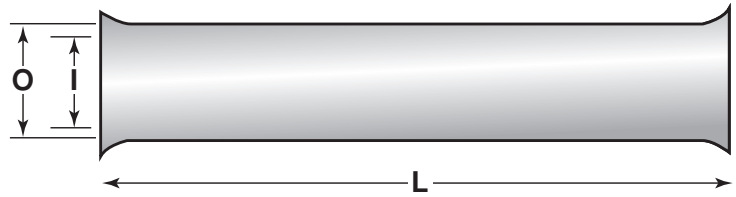

CU FLARED FERRULES

Aftec copper flared ferrules are manufactured from high conductivity seamless copper tubing. Flared entry prevents back bend stands when inserting multi strand cables form both ends.

Technical Data

Application : For regular duty application.

Material : 99.9% Copper

Plating : Electro tin plated

Voltage : 600 V to 1000 V

MODEL NO	DIMENSIONS			CABLE SIZE	
	L	I	O	mm ²	AWG
	MM	MM	MM		
ACS 10-27.940 F*	27.94	4.724	6.35	10	8
ACS 16-29.210 F*	29.21	5.593	7.925	16	6
ACS 25-30.988 F*	30.988	7.137	9.042	25	4
ACS 35-34.036 F*	34.036	8.433	10.668	35	2
ACS 50-34.036 LF*	34.036	8.941	11.176	50	1
ACS 50-39.624 F*	39.624	10.185	12.649	50	1
ACS 70-45.974 F*	45.974	11.582	14.224	70	2/0
ACS 95-48.260 F*	48.26	12.929	15.621	95	3/0
ACS 95-62.484 LF*	62.484	14.935	17.628	95	3/0

* UL LISTED
LF- HIGH VOLTAGE



CU FERRULES COLOR CODED

Aftec copper ferrules are manufactured from high conductivity seamless copper tubing. Short barrel are used for limited space applications which features an internal taper of wires at both ends and are easy to insulate with low installed cost. Color coded ferrule for proper matching die and cable size.

Technical Data.

Application : For regular duty application.

Material : 99.9% Copper

Plating : Electro tin plated

Voltage : 600 V to 1000 V

MODEL NO	COLOR	DIMENSIONS			CABLE SIZE	
		L	I	O	mm ²	AWG
		MM	MM	MM		
ACS 10-22.9 CC*	RED	22.9	4.4	6.9	10	8
ACS 16-25.4 CC*	BLUE	25.4	5.2	7.5	16	6
ACS 25-25.4 CC*	GREY	25.4	6.4	8.7	25	4
ACS 35-31.8 CC*	BROWN	31.8	8	10.7	35	#2
ACS 35-45.7 HV CC*	GREEN	45.7	9.1	11.9	35	#1
ACS 50-40.6 CC*	PINK	40.6	9.9	13.2	50	1/0
ACS 70-44.5 CC*	BLACK	44.5	11.2	14.3	70	2/0
ACS 95-44.5 CC*	ORANGE	44.5	12.5	15.8	95	3/0
ACS 120-48.3 HV CC*	PURPLE	48.3	13.9	17.5	120	4/0
ACS 120-50.8 CC*	YELLOW	50.8	15.1	19.1	120	250 MCM
ACS 150-53.3 CC*	WHITE	53.3	16.7	20.7	150	300 MCM
ACS 185-53.3 HV CC*	RED	53.3	17.8	22.2	185	350 MCM
ACS 185-58.4 CC*	BLUE	58.4	19.4	24.1	185	400 MCM
ACS 240-63.5 CC*	BROWN	63.5	21.2	27	240	500 MCM
ACS 300-63.5 CC*	GREEN	63.5	23.5	30.2	300	600 MCM
ACS 400-81.3 CC*	BLACK	81.3	26.2	33.3	400	750 MCM

* UL LISTED
HV- HIGH VOLTAGE

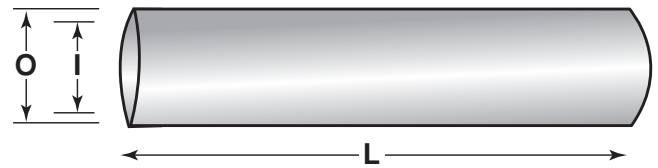

CU LONG BARREL COLOR CODED FERRULES

Aftec cu long barrel color coded ferrules are manufactured from high conductivity seamless copper tubing. Long barrel maximizes number of crimps for added mechanical strength and electrical performance which can be used for high voltage installation up to 33 KV. Provided proper high voltage insulation methods are used.

It features an internal taper of wires at both ends and easy to install. Color coded ferrules for proper matching die and cable size.

Technical Data

Application : Heavy duty designs permits maximum crimps ideal for oil rigs, welding & transportation termination application.

Material : 99.9% Copper

Plating : Electro tin plated

Voltage : 0.6 KV to 33 KV

MODEL NO	COLOR	DIMENSIONS			CABLE SIZE	
		L	I	O	mm ²	AWG
		MM	MM	MM		
ACS 10-44.5 L CC*	RED	44.5	4.4	6.9	10	8
ACS 16-44.5 L CC*	BLUE	44.5	5.2	7.5	16	6
ACS 25-44.5 L CC*	GREY	44.5	6.4	8.7	25	4
ACS 35-48.5 L CC*	BROWN	48.3	8	10.7	35	#2
ACS 50-55.9 HV CC*	GREEN	55.9	9.1	11.9	50	#1
ACS 50-55.9 L CC*	PINK	55.9	9.9	13.2	50	1/0
ACS 70-57.2 L CC*	BLACK	57.2	11.2	14.3	70	2/0
ACS 95-57.2 L CC*	ORANGE	57.2	12.5	15.8	95	3/0
ACS 120-69.9 HV CC*	PURPLE	69.9	13.9	17.5	120	4/0
ACS 120-82.6 L CC*	YELLOW	82.6	15.1	19.1	120	250 MCM
ACS 150-89 L CC*	WHITE	89	16.7	20.7	150	300 MCM
ACS 185-95.3 HV CC*	RED	95.3	17.8	22.2	185	350 MCM
ACS 185-95.3L CC*	BLUE	95.3	19.4	24.1	185	400 MCM
ACS 240-108 L CC*	BROWN	108	21.2	27	240	500 MCM
ACS 300-114.3 L CC*	GREEN	114.3	23.5	30.2	300	600 MCM
ACS 400-120.7 L CC*	BLACK	120.7	26.2	33.3	400	750 MCM

* UL LISTED



**IEC
BA STANDARDS**

INSULATED TERMINALS

AFTEC Range Terminals are designed to offer maximum Efficiency in heavy duty applications and to meet the increasing demands for improved safety and reliability of Electrical Connectors. AFTEC TERMINALS are polycarbonate insulations, Halogen free and self Extinguishing Thermoplastic Material. Aftec Terminals are manufactured from Electrolytic Copper, Rolled, Brazed Annealed and Tin Plated to Avoid corrosion. The Maximum Operating Temperature for AFTEC Terminals is 115°C (surge 130° C)

RING TERMINALS

FORK TERMINALS

FLANGED FORK TERMINALS

LOCKING FORK TERMINALS

HOOK TERMINALS

BLADE TERMINALS

HOOK BLADE TERMINALS

PIN TERMINALS

PIGGY BACK TERMINALS

PUSH-ONS MALE TERMINALS

PUSH-ONS FEMALE TERMINALS

MALE BULLET TERMINALS

FEMALE BULLET TERMINALS

SOCKET TERMINALS

ANGLE FEMALE FULLY INSULATED TERMINALS

SPLICE TERMINALS

PARALLEL SPLICE TERMINALS

FULL INSULATED MALE TERMINALS

FULL INSULATED FEMALE TERMINALS

PUSH-ONS TOTALLY FEMALE INSULATED TERMINALS

SCREW ON TERMINALS

END SPLICE TERMINALS

BOOTLACE FERRULES

TWIN BOOTLACE FERRULES

STRIP CONNECTORS

NON INSULATED BOOTLACE FERRULES

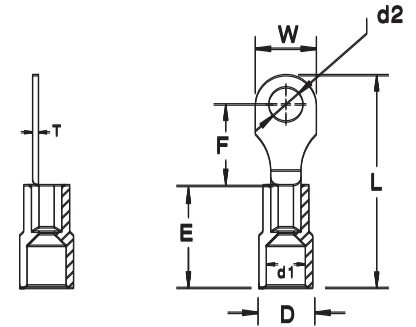

RING TERMINALS

Aftec Ring terminals are designed to offer maximum efficiency in heavy duty applications and to meet the increasing demands for improved safety and reliability of electrical connectors. Color coded insulation identifies the cable size. Ring tongue assures a secure connection in high vibration applications and brazed seam protects terminal barrel from splitting during the crimping process which cannot be removed unless mounting screw is removed.

Technical Data

Material : Electrolytic Copper
 Plating : Tin plated
 Insulation : Pvc (polyvinylchloride)
 Marking : Wire size and stud hole size mention on the tongue
 Color coding : According to wire sizes

MODEL NO.	WIRE RANGE		COLOR	STUD HOLE	DIMENSIONS						
	mm ²	AWG		D2	W	F	L	E	D	D1	T
				MM	MM	MM	MM	MM	MM	MM	MM
ARI 1.5-3.2	0.5-1.5	20-16	RED	3.2	5.6	5.0	17.5	10.0	4.0	1.7	0.75
ARI 1.5-3.7				3.7	5.6	5.0	17.5				
ARI 1.5-4.3				4.3	6.6	6.3	19.4				
ARI 1.5-5.3				5.3	8.0	7.0	20.8				
ARI 1.5-6.5				6.5	11.6	11.6	26.8				
ARI 1.5-8.5				8.5	11.6	11.0	26.8				
ARI 1.5-10				10.0	13.6	13.9	30.5				
ARI 1.5-12				12.0	18.1	16.0	35.4				
ARI 2.5-3.2	1.5-2.5	16-14	BLUE	3.2	6.6	4.8	17.8	10.0	4.5	2.3	0.80
ARI 2.5-3.7				3.7	6.6	4.8	17.8				
ARI 2.5-4.3				4.3	6.6	6.3	19.4				
ARI 2.5-5.3				5.3	8.5	7.8	21.8				
ARI 2.5-6.5				6.5	12.0	11.0	26.8				
ARI 2.5-8.5				8.5	12.0	11.0	26.8				
ARI 2.5-10				10.0	13.5	13.9	30.5				
ARI 2.5-12				12.0	18.1	16.0	35.4				
ARI 6-3.7	4.0-6.0	12-10	YELLOW	3.7	7.2	6.1	22.7	13.0	6.3	3.4	1.0
ARI 6-4.3				4.3	7.2	6.1	22.7				
ARI 6-5.3				5.3	9.5	9.1	26.6				
ARI 6-6.5				6.5	12.0	10.5	29.5				
ARI 6-8.5				8.5	15.0	13.5	34.0				
ARI 6-10				10.0	15.0	13.5	34.0				
ARI 6-12				12.0	18.5	16.0	38.6				

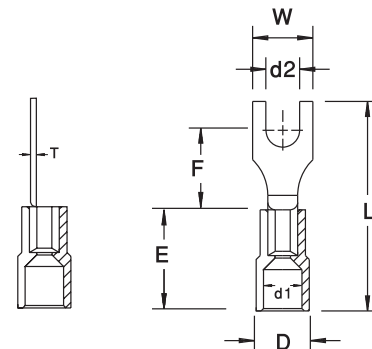

FORK TERMINALS

Aftec Fork terminals are designed to offer maximum efficiency in heavy duty applications and to meet the increasing demands for improved safety and reliability of electrical connectors. Color coded insulations identifies the cable size. Fork terminals enable easy and fast installation as the mounting screw does not have to be removed completely and brazed seam protects terminal barrel from splitting during the crimping process.

Technical Data

Material	: Electrolytic Copper
Plating	: Tin plated
Insulation	: Pvc (polyvinylchloride)
Marking	: Wire size and stud hole size mention on the tongue
Color coding	: According to wire sizes

MODEL NO.	WIRE RANGE		COLOR	STUD HOLE	DIMENSIONS						
	mm ²	AWG		D2	W	F	L	E	D	D1	T
				MM	MM	MM	MM	MM	MM	MM	MM
AFI 1.5-3.2	0.5-1.5	20-16	RED	3.2	5.7	6.5	21.0	10.0	4.0	1.7	0.75
AFI 1.5-3.7				3.7	5.7						
AFI 1.5-4.3				4.3	6.4						
AFI 1.5-5.3				5.3	8.1						
AFI 1.5-6.5				6.5	9.5						
AFI 2.5-3.2	1.5-2.5	16-14	BLUE	3.2	5.8	6.5	21.0	10.0	4.5	2.3	0.8
AFI 2.5-3.7				3.7	5.8						
AFI 2.5-4.3				4.3	6.4						
AFI 2.5-5.3				5.3	8.1						
AFI 2.5-6.5				6.5	9.5						
AFI 6-3.7	4.0-6.0	12-10	YELLOW	3.7	8.2	7.0	25.5	13.0	6.3	3.4	1.0
AFI 6-4.3				4.3	8.2	7.0	25.5				
AFI 6-5.3				5.3	9.0	7.0	25.5				
AFI 6-6.5				6.5	12.0	12.0	31.5				
AFI 6-8.5				8.5	14.0	10.5	30.5				

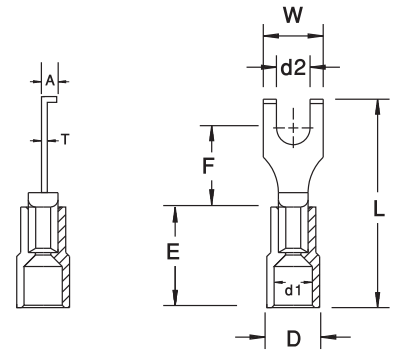

FLANGED FORK TERMINALS

Aftec Flanged Fork terminals are designed to offer maximum efficiency in heavy duty applications and to meet the increasing demands for improved safety and reliability of electrical connectors. Color coded insulation identifies the cable size. Flanged fork terminal locks in place and provides extra secure connection which also enables easy and fast installation as the mounting screw does not have to be removed completely and brazed seam protects terminal barrel from splitting during the crimping process.

Technical Data

Material : Electrolytic Copper
 Plating : Tin plated
 Insulation : Pvc (polyvinylchloride)
 Marking : Wire size and stud hole size mention on the tongue
 Color coding : According to wire sizes

MODEL NO.	WIRE RANGE		COLOR	STUD HOLE	DIMENSIONS							
	mm ²	AWG		D2	W	F	L	E	D	D1	A	T
				MM	MM	MM	MM	MM	MM	MM	MM	MM
AFFI 1.5-3.2	0.5-1.5	20-16	RED	3.2	7.5	5.1	19.0	10.0	4.0	1.7	1.5	0.75
AFFI 1.5-3.7				3.7	8.5	7.2	24.5					
AFFI 1.5-4.3				4.3	8.5	7.2	24.5					
AFFI 1.5-5.3				5.3	8.5	7.2	24.5					
AFFI 2.5-3.7	1.5-2.5	16-14	BLUE	3.7	8.5	7.2	23.0	10.0	4.5	2.3	1.5	0.8
AFFI 2.5-4.3				4.3	8.5							
AFFI 2.5-5.3				5.3	8.5							
AFFI 6-3.7	4.0-6.0	12-10	YELLOW	3.7	8.5	7.5	27.0	13.0	6.3	3.4	1.5	1.0
AFFI 6-4.3				4.3	8.5							
AFFI 6-5.3				5.3	8.5							

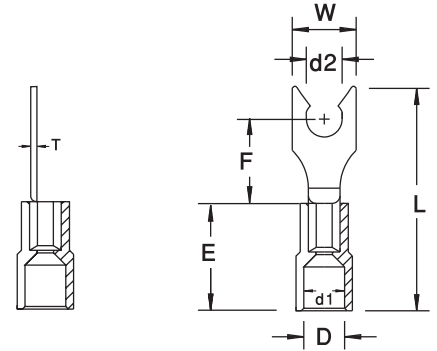

LOCKING FORK TERMINALS

Aftec Locking fork terminals are designed to offer maximum efficiency in heavy duty applications and to meet the increasing demands for improved safety and reliability of electrical connectors. Color coded insulation identifies the cable size. Locking fork terminals provides locks in place for secure connection which also enables easy and fast installation as the mounting screw does not have to be removed completely and brazed seam protects terminals barrel from splitting during the crimping process.

Technical Data

Material	: Electrolytic Copper
Plating	: Tin plated
Insulation	: Pvc (polyvinylchloride)
Marking	: Wire size and stud hole size mention on the tongue
Color coding	: According to wire sizes

MODEL NO.	WIRE RANGE		COLOR	STUD HOLE	DIMENSIONS						
	mm ²	AWG		D2	W	F	L	E	D	D1	T
				MM	MM	MM	MM	MM	MM	MM	MM
ALFI 1.5-3.7	0.5-1.5	20-16	RED	3.7	6.4	6.5	21.0	10.0	4.0	1.7	0.75
ALFI 1.5-4.3				4.3	8.1						
ALFI 1.5-5.3				5.3	9.5						
ALFI 2.5-3.7	1.5-2.5	16-14	BLUE	3.7	6.0	6.5	21.0	10.0	4.5	2.3	0.8
ALFI 2.5-4.3				4.3	8.1						
ALFI 2.5-5.3				5.3	9.3						
ALFI 6-3.7	4.0-6.0	12-10	YELLOW	3.7	8.3	7.0	25.2	13.0	6.3	3.4	1.0
ALFI 6-4.3				4.3	8.3	7.0	25.2				
ALFI 6-5.3				5.3	9.0	7.0	25.2				
ALFI 6-6.4				6.4	12.0	12.0	31.5				

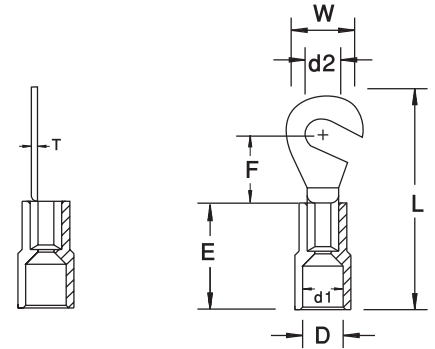

HOOK TERMINALS

Aftec Hook terminals are designed to offer maximum efficiency in heavy duty applications and to meet the increasing demands for improved safety and reliability of electrical connectors. Color coded insulation identifies the cable size. Hook terminal insulation support and helps to prevent wire damage in bending applications. Which also enables easy and fast installation as the mounting screw does not have to be removed completely and brazed seam protects terminals barrel from splitting during the crimping process.

Technical Data

Material : Electrolytic Copper
 Plating : Tin plated
 Insulation : Pvc (polyvinylchloride)
 Marking : Wire size and stud hole size mention on the tongue
 Color coding : According to wire sizes

MODEL NO.	WIRE RANGE		COLOR	STUD HOLE	DIMENSIONS						
	mm ²	AWG		D2	W	F	L	E	D	D1	T
				MM	MM	MM	MM	MM	MM	MM	MM
AHI 1.5-3.7	0.5-1.5	20-16	RED	3.7	8.0	7.0	20.8	10.0	4.0	1.7	0.75
AHI 1.5-4.3				4.3	8.0	7.0	20.8				
AHI 1.5-5.3				5.3	8.0	7.0	20.8				
AHI 1.5-6.5				6.5	11.6	11.0	26.8				
AHI 2.5-3.7	1.5-2.5	16-14	BLUE	3.7	8.5	7.8	21.8	10.0	4.5	2.3	0.8
AHI 2.5-4.3				4.3	8.5	7.8	21.8				
AHI 2.5-5.3				5.3	9.5	7.3	21.8				
AHI 2.5-6.5				6.5	12.0	11.0	26.8				
AHI 6-3.7	4.0-6.0	12-10	YELLOW	3.7	7.2	6.1	22.7	13.0	6.3	3.4	1.0
AHI 6-4.3				4.3	9.5	9.5	26.8				
AHI 6-5.3				5.3	9.5	9.5	26.8				
AHI 6-6.5				6.5	12.0	10.3	29.5				
AHI 6-8.5				8.5	15.0	13.5	34.0				

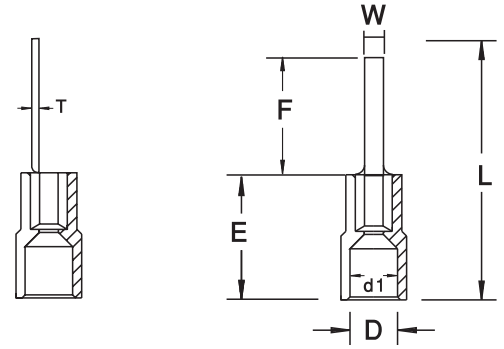

BLADE TERMINALS

Aftec Blade terminals are designed to offer maximum efficiency in heavy duty applications and to meet the increasing demands for improved safety and reliability of electrical connectors. Color coded insulation identifies the cable size. Blade terminals are designed to prevent damage to the wire over crimping, which are reliable electrical connections mostly used for terminal blocks. Which also enables easy and fast installation and brazed seam protects terminals barrel from splitting during the crimping process.

Technical Data

Material	: Electrolytic Copper
Plating	: Tin plated
Insulation	: Pvc (polyvinylchloride)
Marking	: Wire size mentioned on the tongue
Color coding	: According to wire sizes

MODEL NO.	WIRE RANGE		COLOR	DIMENSIONS						
	mm ²	AWG		W	F	L	E	D	D1	T
				MM	MM	MM	MM	MM	MM	MM
ABLI 1.5-8	0.5-1.5	20-16	RED	2.8	9.0	18.8	10.0	4.0	1.7	0.75
ABLI 1.5-10				2.3	10.0	19.8				
ABLI 1.5-12				3.0	12.0	20.8				
ABLI 1.5-14				3.0	14.0	23.8				
ABLI 1.5-18				2.2	18.0	27.8				
ABLI 2.5-8	1.5-2.5	16-14	BLUE	2.8	8.0	18.8	10.0	4.5	2.3	0.8
ABLI 2.5-10				2.4	10.0	19.8				
ABLI 2.5-14				3.0	14.0	23.8				
ABLI 2.5-18				2.8	18.0	27.8				
ABLI 6-10	4.0-6.0	12-10	YELLOW	2.8	10.0	23.0	13.0	6.3	3.4	1.0
ABLI 6-14				4.5	14.0	27.0				
ABLI 6-18				4.5	18.0	31.0				

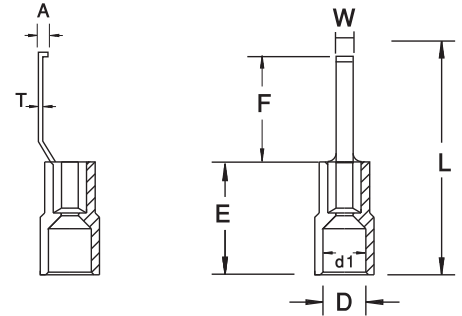
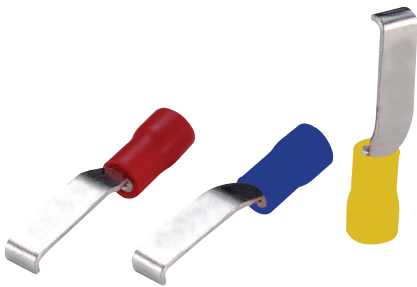

HOOK BLADE TERMINALS

Aftec Hook Blade terminals are designed to offer maximum efficiency in heavy duty applications and to meet the increasing demands for improved safety and reliability of electrical connectors. Color coded insulation identifies the cable size. Hook blade terminals insulation supports and helps to prevent wire damage in bending application.

Technical Data

Material : Electrolytic Copper
 Plating : Tin plated
 Insulation : Pvc (polyvinylchloride)
 Marking : Wire size and blade width mention on the tongue
 Color coding : According to wire sizes

MODEL NO.	WIRE RANGE		COLOR	DIMENSIONS							
	mm ²	AWG		W	F	L	E	D	D1	A	T
				MM	MM	MM	MM	MM	MM	MM	MM
AHBLI 1.5-3.0	0.5-1.5	20-16	RED	3.0	16.8	27.2	10.0	4.0	1.7	2.1	0.75
AHBLI 1.5-4.6				4.6							
AHBLI 2.5-3.0	1.5-2.5	16-14	BLUE	3.0	16.8	27.2	10.0	4.5	2.3	2.1	0.80
AHBLI 2.5-4.6				4.6							
AHBLI 6-3.0	4.0-6.0	12-10	YELLOW	3.0	17.2	30.2	13.0	6.3	3.4	2.4	1.0
AHBLI 6-4.6				4.6							

TERMINALS

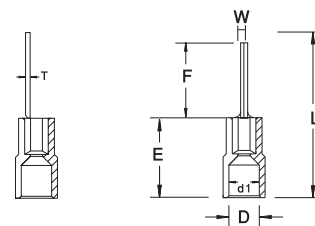

PIN TERMINALS

Aftec Pin terminals are designed to offer maximum efficiency in heavy duty applications and to meet the increasing demands for improved safety and reliability of electrical connectors. Color coded insulation identifies the cable size. Pin terminal are designed to prevent damage to the wire over crimping, which are reliable electrical connections mostly used for terminal blocks. Which also enables easy and fast installation and brazed seam protects terminals barrel from splitting during the crimping process.

Technical Data

Material : Electrolytic Copper
 Plating : Tin plated
 Insulation : Pvc (polyvinylchloride)
 Marking : Wire size and stud hole size mention on the tongue
 Color coding : According to wire sizes

MODEL NO.	WIRE RANGE		COLOR	DIMENSIONS							
	mm ²	AWG		W	F	L	E	D	D1	T	
				MM	MM	MM	MM	MM	MM	MM	
API 1.5-10	0.5-1.5	20-16	RED	1.9		10	19.8	10	4.0	1.7	0.75
API 1.5-12						12	21.8				
API 1.5-14						14	23.8				
API 1.5-18						16	25.8				
API 2.5-10	1.5-2.5	16-14	BLUE	1.9		10	19.8	10	4.5	2.3	0.80
API 2.5-12						12	21.8				
API 2.5-16						16	26.0				
API 2.5-18						18	28.0				
API 6-13	4.0-6.0	12-10	YELLOW	2.8		14	27.0	13	6.3	3.4	1.0

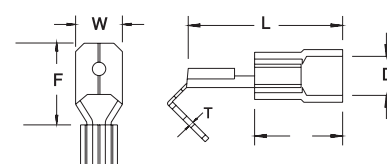

PIGGY BACK TERMINALS

Aftec Piggy back terminals are combination of female disconnect and male tab allows versal connection. Unique construction of the female disconnects offers longer term dependability, Color coded insulation indentifies the cable size. Brazed seam serrated barrel provides maximum tensile strength.

Technical Data:

Material : 70% Copper with brass
 Plating : Tin plated
 Insulation : Pvc (polyvinylchloride)
 Color coding : According to wire sizes

MODEL NO.	WIRE RANGE		COLOR	DIMENSIONS					
	mm ²	AWG		W	F	L	B	D	T
				MM	MM	MM	MM	MM	MM
APBI 1.5-6.3	0.5-1.5	20-16	RED	6.6	6.35	22.5	10.5	3.8	0.40
APBI 2.5-6.3	1.5-2.5	16-14	BLUE	6.6	6.35	22.5	10.5	4.7	0.40
APBI 6-6.3	4.0-6.0	12-10	YELLOW	6.6	6.35	24.0	13.0	6.2	0.40

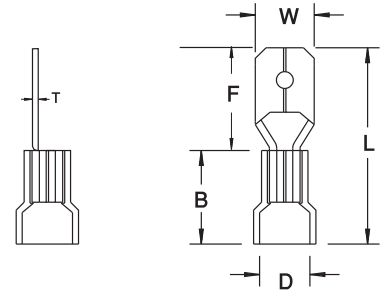

PUSH-ONS MALE TERMINALS

Aftec Push on male terminals connects with push on female terminals for disconnects which can be inserted and easily removed to install without the use of tools, Color coded insulation identifies the cable size. Brazed seam serrated barrel provides maximum tensile strength.

Technical Data

Material : 70% Copper with brass
 Plating : Tin plated
 Insulation : Pvc (polyvinylchloride)
 Marking : Wire size and stud hole size mention on the tongue
 Color coding : According to wire sizes

MODEL NO.	WIRE RANGE		COLOR	DIMENSIONS					
	mm ²	AWG		W	F	L	B	D	T
				MM	MM	MM	MM	MM	MM
APOMI 1.5-2.8	0.5-1.5	20-16	RED	2.8	6.5	19.2	10.5	3.8	0.50
APOMI 1.5-4.8				4.8	6.7	19.8			
APOMI 1.5-6.35				6.35	7.7	21.8			
APOMI 2.5-4.8	1.5-2.5	16-14	BLUE	4.8	6.7	19.8	10.5	4.7	0.50
APOMI 2.5-6.35				6.35	7.7	21.8			
APOMI 6-6.35	4.0-6.0	12-10	YELLOW	6.35	7.7	24.0	13.0	6.2	0.40

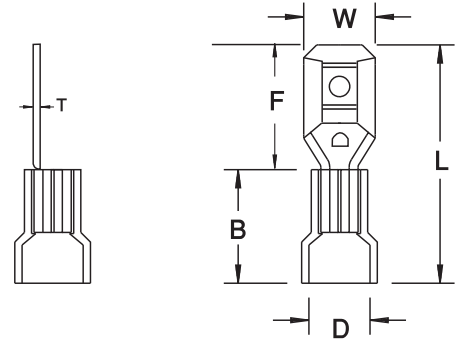

PUSH-ONS FEMALE TERMINALS

Aftec Push on female terminals connects with push on male terminals for disconnects which can be inserted and easily removed to install without the use of tools, Color coded insulation identifies the cable size. Brazed seam serrated barrel provides maximum tensile strength.

Technical Data:

Material : 70% Copper with brass
 Plating : Tin plated
 Insulation : Pvc (polyvinylchloride)
 Marking : Wire size and stud hole size mention on the tongue
 Color coding : According to wire sizes

MODEL NO.	WIRE RANGE		COLOR	DIMENSIONS					
	mm ²	AWG		W	F	L	B	D	T
				MM	MM	MM	MM	MM	MM
APFI 1.5-2.8	0.5-1.5	20-16	RED	3.2	6.5	19.0	10.5	3.8	0.40
APFI 1.5-4.8				5.0	6.4	19.4			
APFI 1.5-6.3				6.6	7.3	20.8			
APFI 2.5-2.8	1.5-2.5	16-14	BLUE	3.2	6.5	19.0	10.5	4.7	0.40
APFI 2.5-4.8				5.0	6.4	19.4			
APFI 2.5-6.3				6.6	7.3	20.8			
APFI 2.5-8.0				8.2	10.0	24.5			
APFI 6-4.8	4.0-6.0	12-10	YELLOW	5.0	6.5	22.0	13.0	6.2	0.50
APFI 6-6.3				6.6	7.3	23.3			
APFI 6-8.0				8.2	10.0	27.0			
APFI 6-9.5				10.0	12.0	28.6			

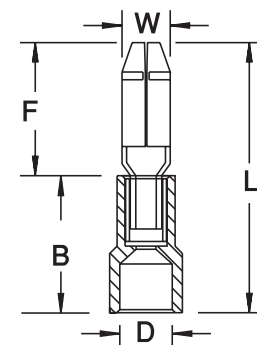

MALE BULLET TERMINALS

Aftec male bullet terminals connect with female bullets terminals for disconnects which can be inserted and easily removed to install without the use of tools, Color coded insulation identifies the cable size. Brazed seam serrated barrel provides maximum tensile strength.

Technical Data:

Material : 70% Copper with brass
 Plating : Tin plated
 Insulation : Pvc (polyvinylchloride)
 Color coding : According to wire sizes

MODEL NO.	WIRE RANGE		COLOR	DIMENSIONS					
	mm ²	AWG		W	F	L	B	D	T
				MM	MM	MM	MM	MM	MM
ABMI 1.5-4.0	0.5-1.5	20-16	RED	4.0	8.5	21.5	10.5	3.8	0.40
ABMI 2.5-4.0	1.5-2.5	16-14	BLUE	4.0	8.5	21.7	10.5	4.7	0.40
ABMI 2.5-5.0				5.0	8.5	21.7	10.5	4.7	0.40
ABMI 6-5.0	4.0-6.0	12-10	YELLOW	5.0	8.5	24.0	13.0	6.2	0.40

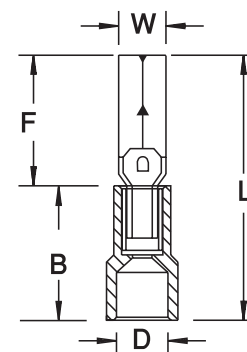

FEMALE BULLET TERMINALS

Aftec female bullet terminals connect with push on male bullet terminals for disconnects which can be inserted and easily removed to install without the use of tools, Color coded insulation identifies the cable size. Brazed seam serrated barrel provides maximum tensile strength.

Technical Data:

Material : 70% Copper with brass
 Plating : Tin plated
 Insulation : Pvc (polyvinylchloride)
 Color coding : According to wire sizes

MODEL NO.	WIRE RANGE		COLOR	DIMENSIONS					
	mm ²	AWG		W	F	L	B	D	T
				MM	MM	MM	MM	MM	MM
ABFI 1.5-4.0	0.5-1.5	20-16	RED	3.9	7.3	22.0	10.5	3.8	0.40
ABFI 2.5-4.0	1.5-2.5	16-14	BLUE	3.9	7.3	22.0	10.5	4.7	0.40
ABFI 6-5.0	4.0-6.0	12-10	YELLOW	4.9	7.0	24.5	13.0	6.2	0.40

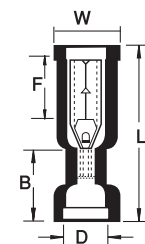

SOCKET TERMINALS

Aftec Socket terminals are combination of female disconnect which are designed to offer maximum efficiency in heavy duty applications and to meet the increasing demands for improved safety and reliability of electrical connectors. Color coded insulation identifies the cable size. Socket terminals brazed seam to prevent barrel separation.

Technical Data

Material : Brass
 Plating : Tin plated
 Insulation : Pvc (Polyvinylchloride)
 Color coding : According to wire sizes

MODEL NO.	WIRE RANGE		COLOR	DIMENSIONS					
	mm ²	AWG		W	F	L	B	D	T
				MM	MM	MM	MM	MM	MM
AST 1.5-4.0	0.5-1.5	20-16	RED	3.9	7.3	23.3	10.5	3.8	0.40
AST 2.5-4.0	1.5-2.5	16-14	BLUE	3.9	7.3	23.3	10.5	4.7	0.40
AST 2.5-5.0				4.9	7.0	23.3	10.5	4.7	0.40
AST 6-5.0	4.0-6.0	12-10	YELLOW	4.9	7.0	25.1	12.5	6.2	0.45

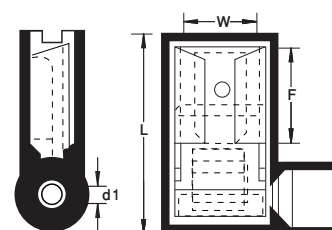
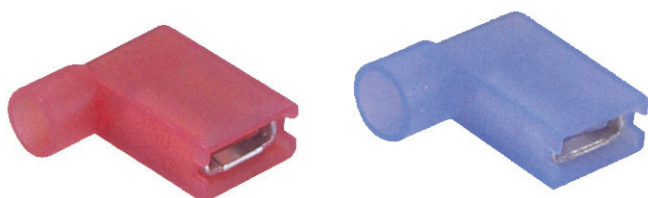

ANGLE FEMALE FULLY INSULATED TERMINALS

Aftec Angle female fully insulated terminals are designed for use in limited space area application and connect with male terminals for disconnects which can be inserted and easily removed to install without the use of tools, Color coded insulation identifies the cable size.

Technical Data

Material : 70% Copper with brass
 Plating : Tin plated
 Insulation : Pvc (Polyvinylchloride)
 Color coding : According to wire sizes

MODEL NO.	WIRE RANGE		COLOR	DIMENSIONS				
	mm ²	AWG		W	F	L	D	T
				MM	MM	MM	MM	MM
AAFI 1.5-4.8	0.5-1.5	20-16	RED	5.0	7.0	15.0	1.6	0.40
AAFI 1.5-6.3				6.6	7.6	15.2		
AAFI 2.5-4.8	1.5-2.5	16-14	BLUE	5.0	7.0	15.2	2.1	0.40
AAFI 2.5-6.3				6.6	7.6	15.2		

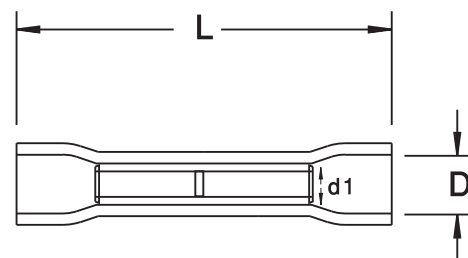

SPLICE TERMINALS

Aftec Splice terminals are designed to splice two stranded wires together to repair or lengthen wires and crimped at each end of the splice and are used in limited space area. Color coded insulation identifies the cable size. Brazed seam protects terminal barrel from splitting during the crimping process.

Technical Data

Material : Electrolytic Copper
 Plating : Tin plated
 Insulation : Pvc (Polyvinylchloride)
 Color coding : According to wire sizes

MODEL NO.	WIRE RANGE		COLOR	DIMENSIONS		
	mm ²	AWG		L	D	D1
				MM	MM	MM
ASI 1.5	0.5-1.5	20-16	RED	24.6	4.0	1.7
ASI 2.5	1.5-2.5	16-14	BLUE	24.6	4.5	2.3
ASI 6.0	4.0-6.0	12-10	YELLOW	26.5	6.3	3.4

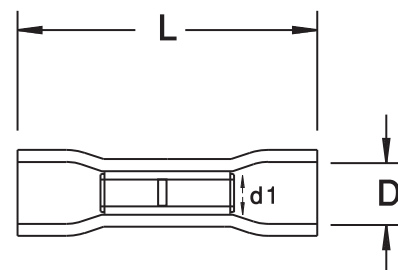

PARALLEL SPLICE TERMINALS

Aftec Parallel splice terminals are designed to splice two stranded wires side by side to repair or lengthen wires and crimped once. Color coded insulation identifies the cable size. Brazed seam protects terminal barrel from splitting during the crimping process.

Technical Data

Material : Electrolytic Copper
 Plating : Tin plated
 Insulation : Pvc (Polyvinylchloride)
 Color coding : According to wire sizes

MODEL NO.	WIRE RANGE		COLOR	DIMENSIONS		
	mm ²	AWG		L	D	D1
				MM	MM	MM
APSI 1.5	0.5-1.5	20-16	RED	13.0	4.0	1.7
APSI 2.5	1.5-2.5	16-14	BLUE	13.0	4.5	2.3
APSI 6.0	4.0-6.0	12-10	YELLOW	15.0	6.3	3.4

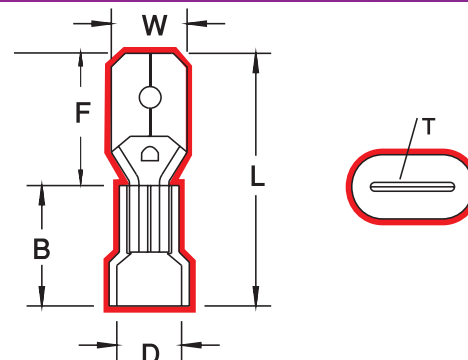

FULL INSULATED MALE TERMINALS

Aftec fully insulated male terminals connect with female terminals for disconnects which can be inserted and easily removed without the use of tools. Fully insulated terminals are designed for maximum stable connection providing higher quality connection, Color coded insulation identifies the cable size. Brazed seam serrated barrel provides maximum tensile strength.

Technical Data

Material : 70% copper with brass
 Plating : Tin plated
 Insulation : Polyamide
 Color coding : According to wire sizes

MODEL NO.	WIRE RANGE		COLOR	DIMENSIONS					
	mm ²	AWG		W	F	L	B	D	T
				MM	MM	MM	MM	MM	MM
AFIM 1.5-6.5	0.5-1.5	20-16	RED	6.35	7.7	23	11.0	4.0	0.40
AFIM 2.5-6.5	1.5-2.5	16-14	BLUE	6.35	7.7	24	11.0	4.5	0.40
AFIM 6-6.5	4.0-6.0	12-10	YELLOW	6.35	7.7	25	13.0	6.3	0.40

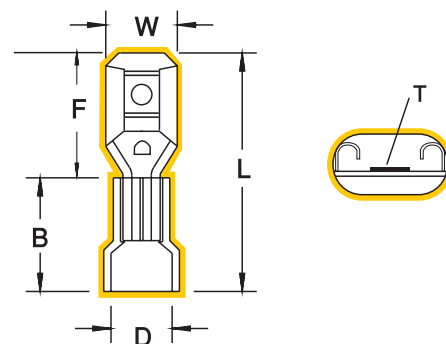

FULL INSULATED FEMALE TERMINALS

Aftec fully insulated female terminals connect with male terminals for disconnects which can be inserted and easily removed without the use of tools. Fully insulated terminals are designed for maximum stable connection providing higher quality connection, Color coded insulation identifies the cable size. Brazed seam serrated barrel provides maximum tensile strength.

Technical Data

Material : 70% copper with brass
 Plating : Tin plated
 Insulation : Polyamide
 Color coding : According to wire sizes

MODEL NO.	WIRE RANGE		COLOR	DIMENSIONS					
	mm ²	AWG		W	F	L	B	D	T
				MM	MM	MM	MM	MM	MM
AFIF 1.5-6.6	0.5-1.5	20-16	RED	6.6	7.3	22	11.0	4.0	0.40
AFIF 2.5-6.6	1.5-2.5	16-14	BLUE	6.6	7.3	22	11.0	4.5	0.40
AFIF 6-6.6	4.0-6.0	12-10	YELLOW	6.6	7.3	24	13.0	6.3	0.40

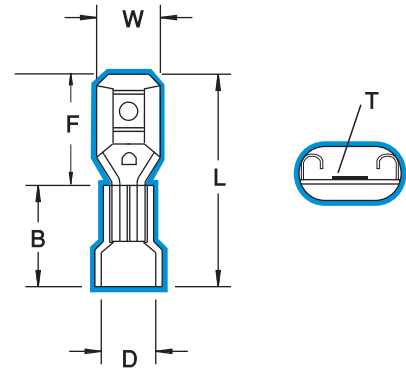

PUSH ONS TOTALLY FEMALE INSULATED TERMINALS

Aftec push on totally female insulated terminals connect with male terminals for disconnects which can be inserted and easily removed without the use of tools. Nylon insulation retains its shape when crimped and provides a firm grip around the wire insulation for maximum strain relief and also designed which provides protection from electrical shorts, Color coded insulation identifies the cable size.

Technical Data

Material : 70% copper with brass
 Plating : Tin plated
 Insulation : Polyamide
 Color coding : According to wire sizes

MODEL NO.	WIRE RANGE		COLOR	DIMENSIONS					
	mm ²	AWG		W	F	L	B	D	T
				MM	MM	MM	MM	MM	MM
APOI 1.5-2.8TI	0.5-1.5	20-16	RED	3.2	6.5	19.0	10.5	3.8	0.30
APOI 1.5-4.8TI				5.0	6.4	20.5			0.40
APOI 1.5-6.3TI				6.6	7.3	21.8			0.40
APOI 2.5-2.8TI	1.5-2.5	16-14	BLUE	3.2	6.5	19.0	10.5	4.7	0.30
APOI 2.5-4.8TI				5.0	6.4	20.2			0.40
APOI 2.5-6.3TI				6.6	7.3	22.2			0.40
APOI 6-6.3TI	4.0-6.0	12-10	YELLOW	6.6	7.3	24.2	12.5	6.2	0.40

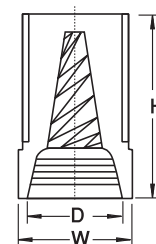

SCREW ON TERMINALS

Aftec screw on terminals is used for general wiring use which is quick and easy to use. Color coding indicates the right connector to the size of wire as shown in the chart below.

- ASC1 (Grey): 22-16 AWG (Three to Five #22 AWG; Two to Four #20 AWG; Two or Three #18 AWG; Two #16 AWG)
- ASC2 (Blue): 22-16 AWG (Five #22 AWG; Three to Five #20 AWG; Two or Four #18 AWG; Two or Three #16 AWG; One # 14 AWG w/On #16 AWG)
- ASC3 (Orange): 22-14 AWG (Five #22 AWG; Three to Five #20 AWG; Two to Five #18 AWG; Two or Three #16 AWG; Two #14 AWG)
- ASC4 (Yellow): 22-12 AWG (Four or Five #22 AWG; Three to Five #20 AWG; Two to Seven #18 AWG; Two to Four #16 AWG; Two or Three #14 AWG; Two #12 AWG)
- ASC5 (Red): 18-10 AWG (Three to Nine #18 AWG; Two to Six #14 AWG; Two to Four #12 AWG; Two or Three #10 AWG)

MODEL NO.	WIRE RANGE		COLOR	DIMENSIONS		
	mm ²	AWG		H	W	D
				MM	MM	MM
ASC1	0.34 - 1.5	22 - 16	GREY	15	8.7	6.5
ASC2	0.34 - 1.5	22 - 16	BLUE	18	10.0	7.5
ASC3	0.34 - 2.5	22 - 14	ORANGE	23	11.2	9.5
ASC4	0.34 - 4	22 - 12	YELLOW	24.2	13.6	10.8
ASC5	0.75 - 6	18 - 10	RED	27.8	16.1	12.7

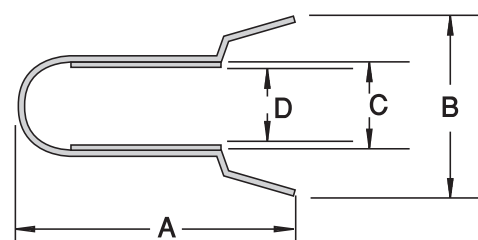

END SPLICE TERMINALS

Aftec End splice terminals accommodate multiple wire sizes in varying combinations. Internal barrel beveled to provide quick and easy wire insertion. Ideal for harsh environments and provides excellent chemical impact and abrasion resistance.

Technical Data

Material : Brass
 Plating : Tin plated
 Insulation : Polyamide

MODEL NO.	WIRE RANGE		COLOR	DIMENSIONS			
	mm ²	AWG		A	B	C	D
				MM	MM	MM	MM
AESI 1.5	0.5-1.5	20-16	WHITE	17.8	7.2	3.6	2.5
AESI 2.5	1.5-2.5	16-14	WHITE	21.0	8.2	4.0	2.9
AESI 6.0	4.0-6.0	12-10	WHITE	22.5	9.0	4.8	3.9

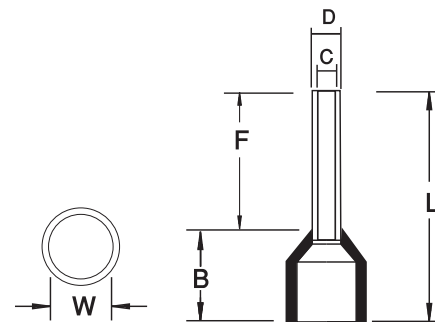

BOOTLACE FERRULES

Aftec Bootlace ferrules ensure reliable electrical connectors when terminating conductors in screw clamp terminal blocks. Color coding of the insulation is according to the wire size and the country standard. Designed with seamless barrel to contain loose wire strands for separator terminations which are easy to use by stripping the wire and sliding on to the end wire and crimping suitable for limited space panel applications.

Technical Data

Material : Copper

Plating : Tin plated

Insulation : Polyamide

MODEL NO.	WIRE RANGE		COLOR		DIMENSIONS					
	mm ²	AWG			F	L	W	B	D	C
					MM	MM	MM	MM	MM	MM
ABF 0.5-8	0.5	20	WHITE	ORANGE	8	14	3.2	6.0	1.3	1.0
ABF 0.5-12					12	18				
ABF 0.75-8	0.75	18	WHITE	BLUE	8	14	3.2	6.0	1.5	1.2
ABF 0.75-12					12	18				
ABF 1.0-8	1.0	17	RED	YELLOW	8	15	3.7	7.0	1.7	1.4
ABF 1.0-10					10	17				
ABF 1.0-12					12	19				
ABF 1.0-18					18	25				
ABF 1.5-8	1.5	16	RED	BLACK	8	15	4.0	7.0	2.0	1.7
ABF 1.5-10					10	17				
ABF 1.5-12					12	19				
ABF 1.5-18					18	25				
ABF 2.5-12	2.5	14	BLUE	GREY	12	19	5.0	7.0	2.6	2.3
ABF 2.5-18					18	25				
ABF 4.0-12	4.0	12	GREY	YELLOW	12	20	6.0	8.0	3.2	2.8
ABF 4.0-18					18	26				
ABF 6.0-12	6.0	10	GREEN	BLACK	12	20	6.8	8.0	3.9	3.5
ABF 6.0-18					18	26				
ABF 10.0-10	10.0	8	BROWN	IVORY	10	19	8.5	9.0	4.9	4.5
ABF 10.0-12					12	21				
ABF 10.0-18					18	27				
ABF 16.0-12	16.0	6	WHITE	GREEN	12	22	8.7	10.0	6.2	5.8
ABF 16.0-18					18	28				
ABF 25.0-15	25.0	4	BLACK	BROWN	15	27	11.0	12.0	7.9	7.5
ABF 35.0-20	35.0	2	RED	BEIGE	20	34	13.2	14.0	8.7	8.3
ABF 50.0-20	50.0	1	BLUE	GREEN	20	36	15.0	16.0	10.9	10.3
ABF 70.0-25	70.0	2/0	YELLOW	RED	25	42	17.0	16.5	14.3	13.5
ABF 95.0-25	95.0	3/0	RED	BLUE	25	44	20.0	19.0	15.6	14.8
ABF 120.0-27	120	4/0	BLUE		27	47.3	20.8	20.3	17.5	16.7
ABF 150.0-27	150	300MCM	YELLOW		27	52	24.5	25.0	20.6	19.6

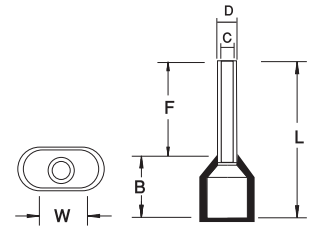

TWIN BOOTLACE FERRULES

Aftec Twin bootlace ferrules ensure reliable electrical connectors when terminating conductors in screw clamp terminal blocks and are used for twin wire containment. Color coding of the insulation is according to the wire size and the country standard. Designed with seamless barrel to contain loose wire strands for separator terminations which are easy to use by stripping the wire and sliding on to the end wire and crimping suitable for limited space panel applications.

Technical Data

Material : Copper
 Plating : Tin plated
 Insulation : Polyamide

MODEL NO.	WIRE RANGE		COLOR		DIMENSIONS					
	mm ²	AWG			F	L	W	B	D	C
					MM	MM	MM	MM	MM	MM
ABF 0.5-8X2C	0.5	20	WHITE	ORANGE	8	15	5.5	7	1.5	1
ABF 0.75-10X2C	0.75	18	WHITE	BLUE	10	17	6	7	2	1.8
ABF 1.0-10X2C	1.0	17	RED	YELLOW	10	18	6	8	2	1.8
ABF 1.5-8X2C	1.5	16	RED	BLACK	8	16	7	8	2.8	2.2
ABF 1.5-12X2C					12	20	7	8	2.8	2.2
ABF 2.5-10X2C	2.5	14	BLUE	GREY	10	19	9	9	4.2	3.9
ABF 2.5-13X2C					13	22	9	9	4.2	3.9
ABF 4.0-12X2C	4.0	12	GREY	YELLOW	12	23	10	11	4	3.9
ABF 6.0-14X2C	6.0	10	GREEN	BLACK	14	24.5	10.5	10	5.2	4.9
ABF 10.0-14X2C	10.0	8	BROWN	IVORY	14	26.2	13.2	12.2	7	6.5
ABF 16.0-14X2C	16.0	6	WHITE	GREEN	14	31	20	17	9	8.5

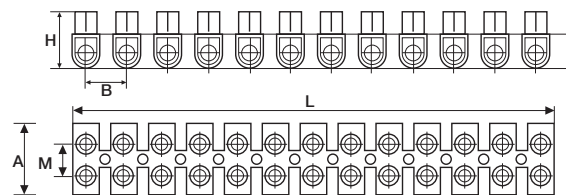
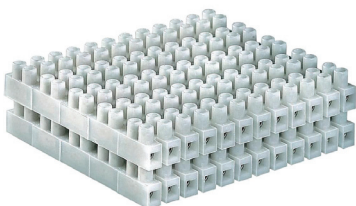

STRIP CONNECTOR

Aftec strip connectors are double row terminal strips which are cost effective. Simply strip and insert the wire and tighten the screw.

Technical Data:

Application : For wire to wire connectors in HVAC. Appliances, equipments and power distribution.
 Material : Polyamide 6.6
 Voltage Rating : 400 V
 Color : Black & White

MODEL NO.	CABLE SIZE		AMP	L	A	H	M	B	VOLT
	mm ²	AWG		MM					
APSC 412	4	12	3	93	16	12	6	8	400 V
APSC 612	6	10	6	115	15.7	13	6.5	9.5	
APSC 1012	10	8	10	126	20.2	15.5	8.4	10.5	
APSC 1612	16	6	30	171	26	20.5	12	14.5	
APSC 2512	25	4	60	192	30	26	13.5	16.5	
APSC 3512	35	2	80	205	33	27	15	17	

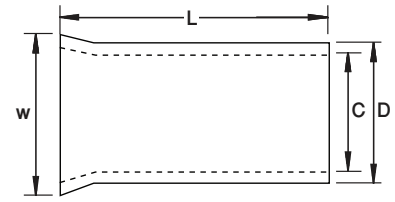

NON INSULATED BOOTLACE FERRULES

Aftec Non insulated Bootlace ferrules ensure reliable electrical connectors when terminating conductors in screw clamp terminal blocks. Designed with seamless barrel to contain loose wire strands for separator terminations which are easy to use by stripping the wire and sliding on to the end wire and crimping suitable for limited space panel applications.

Technical Data

Material : Copper

Plating : Tin plated

MODEL NO.	WIRE RANGE		DIEMESIONS			
	mm ²	AWG	L	W	D	C
			MM	MM	MM	MM
ABFNI 0.5-8	0.5	20	8	1.7	1.3	1.0
ABFNI 0.5-12			12			
ABFNI 0.75-8	0.75	18	8	1.9	1.5	1.2
ABFNI 0.75-12			12			
ABFNI 1.0-8	1.0	17	8	2.2	1.7	1.4
ABFNI 1.0-10			10			
ABFNI 1.5-8	1.5	16	8	2.5	2	1.7
ABFNI 1.5-10			10			
ABFNI 1.5-12			12			
ABFNI 1.5-18			18			
ABFNI 2.5-12	2.5	14	12	3.3	2.6	2.3
ABFNI 2.5-18			18			
ABFNI 4.0-12	4.0	12	12	3.9	3.2	2.8
ABFNI 4.0-18			18			
ABFNI 6.0-12	6.0	10	12	4.7	3.9	3.5
ABFNI 6.0-18			18			
ABFNI 10.0-12	10.0	8	12	5.8	4.9	4.5
ABFNI 10.0-18			18			
ABFNI 16.0-12	16.0	6	12	7.2	6.2	5.8
ABFNI 16.0-18			18			
ABFNI 25.0-15	25.0	4	15	9.1	7.9	7.5
ABFNI 35.0-20	35.0	2	20	10.2	8.7	8.3
ABFNI 50.0-20	50.0	1	20	12.7	10.9	10.3
ABFNI 70.0-25	70.0	2/0	25	15.8	14.3	13.5
ABFNI 95.0-25	95.0	3/0	25	17.3	15.6	14.8
ABFNI 120.0-27	120	4/0	27	20.2	17.3	16.7
ABFNI 150.0-27	150	300MCM	27	23	20.6	19.6



**IEC
BA STANDARDS**

AFTEC Heat Shrink Sleeves and End Caps are superior performance heat shrinkable products designed for corrosion, protection of high profile couplings and also for mechanical and electrical insulations.

Features

Flexible

High Shrink Ratio

Flame Retardant

Resistant to all Common Fluids & Solvents

Shrink Temperature 90°C

AFTEC Heat Shrink Sleeves and End Caps are UL2240 approved and follow CSA Specifications.

AFTEC Shrink Sleeves and End Caps are silicon, cadmium and lead free.

HEAT SHRINKABLES

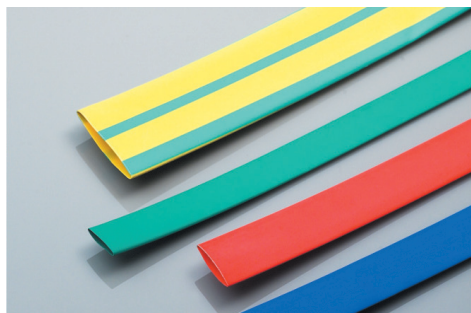

HEAT SHRINKABLES

Aftec Heat Shrink sleeves are multipurpose use for insulation, bundling, strain relief for electrical wire connection which are flexible, and are resistance to chemical, copper corrosion and fungus, they are flame retardant and self extinguishing Insulation up to 1KV.

Technical Data:

Material : Cross linked Polyolefin
 Shrink ratio : 2:1
 Operating temperature : - 55° C to + 125° C
 Shrinking temperature : + 110° C
 Water absorption : 0.15 %(max)

MODEL NO	DIAMETER				WALL THICKNESS		STANDARD QUANTITY PER ROLL
	BEFORE SHRINK		AFTER SHRINK		BEFORE SHRINK	AFTER SHRINK	
	D1		D2		W1	W2	
	MM	INCH	MM	INCH	MM	MM	METERS
HSS 2	2	0.08	1.0	0.04	0.44	0.22	200 Mtr
HSS 3	3	0.12	1.5	0.06	0.44	0.22	200 Mtr
HSS 4	4	0.16	2.0	0.08	0.44	0.22	200 Mtr
HSS 6	6	0.24	3.0	0.12	0.56	0.28	100 Mtr
HSS 10	10	0.4	5.0	0.20	0.56	0.28	100 Mtr
HSS 15	15	0.6	7.5	0.30	0.69	0.345	100 Mtr
HSS 20	20	0.8	10.0	0.40	0.78	0.39	100 Mtr
HSS 25	25	1	12.5	0.50	0.78	0.39	50 Mtr
HSS 30	30	1.2	15.0	0.60	0.87	0.435	25 Mtr
HSS 35	35	1.4	17.5	0.70	0.87	0.435	25 Mtr
HSS 40	40	1.6	20.0	0.80	0.97	0.485	25 Mtr
HSS 50	50	2	25.0	1.00	0.97	0.485	25 Mtr
HSS 60	60	2.4	30.0	1.20	0.97	0.485	25 Mtr
HSS 80	80	3.2	40.0	1.60	1.17	0.585	25 Mtr
HSS 100	100	4	50.0	2.00	1.17	0.585	25 Mtr
HSS 120	120	4.8	60.0	2.40	1.37	0.685	25 Mtr
HSS 150	150	6	75.0	3.00	1.37	0.685	25 Mtr

For different colors add color suffix to the product reference.

 RED (R)
  YELLOW (Y)
  BLUE (BL)
  BLACK (BK)
  GREEN/YELLOW (GY)

 WHITE (W)
  ORANGE (C)
  BROWN (BR)
  GREY (GY)
  GREEN (G)

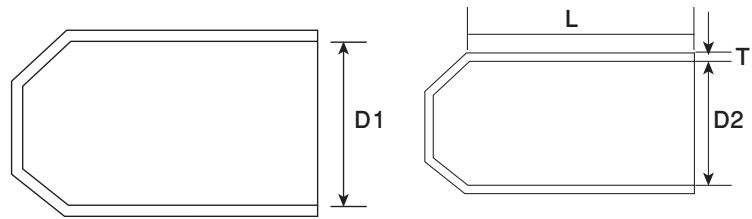

END CAPS

Aftec Heat Shrinkable End Caps are effective method for sealing cable ends and pipes.to protect against corrosion and moisture penetration.

Technical Data

Material : Crossedlinked Polyolefin End Caps.
 Shrinkratio : 3:1
 Operating temperature : -55° C to + 125° C

MODEL NO	DIAMETER				LENGTH	THICKNESS	CABLE	
	BEFORE SHRINK		AFTER SHRINK				DIA-C (mm)	
	D1		D2				Min	Max
	MM	INCH	MM	INCH				
AEC-101 A	25	1.00	7.5	0.30	55	2.30	8	20
AEC-102 A	35	0.71	11	0.44	75	2.50	12	30
AEC-201	40	0.63	15	0.60	90	3.30	16	35
AEC-301	55	0.45	25	1.00	125	3.80	25	47
AEC-401	75	0.33	35	1.40	140	3.80	35	68
AEC-501	100	0.25	45	1.80	160	4.00	45	90
AEC-601	130	0.19	60	2.40	160	4.60	64	120



AFTEC PVC tapes are used for insulating connection, phase labeling and sheath protection of wires and cables under 600v and below 70°C
They are also used for bandaging, fixation, splicing, remedy, encapsulation and protection industry.

AFTEC PVC tapes major properties include :

- a) Shine or Matt Surfaces
- b) Soft Material
- c) High Elasticity
- d) High Intensity
- e) Highly Adhesive and Electrical insulative performance

Available in Different Colors





NYLON CABLE TIES

Aftec Nylon Cable ties are available in lengths from 100mm to 1200mm and width from 2.5mm to 12mm. Which are halogen and silicone free polyamide 6.6 are available in different colors.

NON RELEASABLE CABLE TIES

NON RELEASABLE HEAT STABILIZED CABLE TIES

NON RELEASABLE ULTRA VIOLET(UV) RESISTANCE CABLE TIES

NON RELEASABLE FIRE RETARDANT CABLE TIES

MARKER CABLE TIES

RELEASABLE CABLE TIES

NYLON DOUBLE LOCKING CABLE TIES

NYLON PUSH MOUNT CABLE TIES

WIRING AND ACCESSORIES

Aftec wiring and accessories exist in a wide range and with different mounting methods for increased performance. These accessories can be used in a variety of applications providing the optimal cable management solution.

CABLE TIE MOUNT

SCREW SADDLE MOUNT

CIRCLE CABLE CLIPS

SPIRAL WRAPPING BANDS

NYLON P CLIPS

FEATURES AND BENEFITS

MATERIAL CRITERIA	NATURAL NYLON 6.6	UV STABILISED NYLON 66	HEAT STABILISED NYLON 66	FLAME RETARDANT NYLON 66	WEATHER RESISTANT POLYPROPYLENE	WEATHER RESISTANT NYLON 12	TEFZEL	STAINLESS STEEL
MODEL NO	ACTI 2.5-100	ACTI 2.5-100 UV	ACTI 2.5-100 HS	ACTI 2.5-100 FR				ACTI 4.6-100 BL
APPLICATION	For indoor wirecable bunching	For Outdoor, Weather Resistant	For High Temperature Area	In Fire Hazardous Area				For Extreme Conditions & Hazardous area
Colour	Natural/Black	Black	Light Green	White	Black	Black	Blue	Metatic & Polyester Coating
Overall Weatherability (Includes a Combination of resistance to ultraviolet light and sulfuric acid/nitric acid rain)	3	5	4	3	6	7	9	10
Loop Tensile Strength	7	7	7	7	5	6	7	10
Operating Temperature	-40°C to 85°C	-40°C to 85°C	-40°C to 125°C	-40°C to 85°C	-40°C to 85°C	-40°C to 80°C	-46°C to 150°C	Uncoated: -80°C to 538°C Coated: -80°C to 150°C
Low Temperature Service	6	6	6	5	6	6	7	10
High Temperature Service	5	5	6	5	5	5	8	10
Flammability	6	6	6	8	2	3	9	10
Flammability Rating	UL 94V-2	UL 94V-2	UL 94V-2	UL 94V-0	UL 94HB	UL 94V-2	UL 94V-0	Uncoated: -Fireproof Coated: - UL 94V-0
Ultraviolet Resistance	1	6	4	1	6	7	9	10
Gamma Radiation Resistance	3	3	3	3	5	4	9	10
Overall Chemical Resistance	6	6	6	6	8	8	10	9
- Hydrocarbons	9	9	9	9	6	9	10	10
- Chlorinated Hydrocarbons	7	7	7	7	5	8	10	10
- Acids	2	2	2	2	9	6	10	10
- Bases	7	7	7	7	9	7	10	8
- Salts	3	3	3	3	10	8	10	9
For different colors add color suffix to the product reference.								
R = Red Y = Yellow BL = Blue BK = Black G = Green W = White GR = Grey BR = Brown OE = Orange								

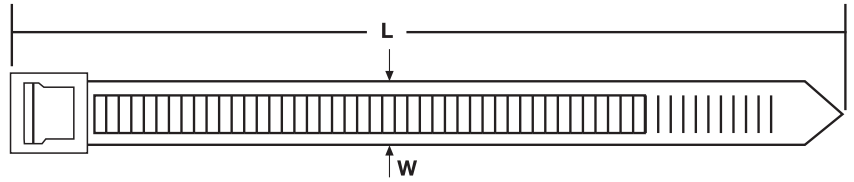
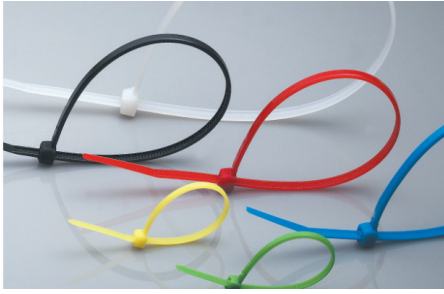

NON RELEASABLE CABLE TIES

Aftec cable ties provide an appropriate and elegant solution for specific applications where aesthetics and users concern is primary.

Aftec cable ties have self locking which ensure fast and easy installation and once locked cannot be reused.

Technical information

Application : For indoor use

Material : Nylon 6.6

Temperature range : - 40°C to + 85°C

Flammability rating : UL 94 V-2

Color : Black & Natural color are available and other colors can be supplied upon request.

MODEL NO.	WIDTH		LENGTH		TENSILE STRENGTH		MAXIMUM BUNDLE DIA	
	W		L		KGS	LBS	INCH	MM
	MM	INCH	MM	MM				
ACTI 2.5-100*	2.5	4	100	8	18	0.94	24	
ACTI 2.5-150		6	150			1.38	35	
ACTI 2.5-200		8	200			2.09	53	
ACTI 3.6-150*	3.6	6	150	18	40	1.38	35	
ACTI 3.6-200*		8	200			2.09	53	
ACTI 3.6-250		10	250			2.68	68	
ACTI 3.6-300		12	300			3.23	82	
ACTI 3.6-370		14.8	370			3.50	89	
ACTI 4.8-200*	4.8	8	200	22	50	2.09	53	
ACTI 4.8-250*		10	250			2.68	68	
ACTI 4.8-300*		12	300			3.39	86	
ACTI 4.8-368		14.72	368			4.23	107.5	
ACTI 4.8-400		16	400			4.69	119	
ACTI 4.8-450		18	450			5.12	130	
ACTI 4.8-500		20	500			5.75	146	
ACTI 4.8-550		22	550			6.50	165	
ACTI 4.8-650		26	650			7.60	193	
ACTI 4.8-750		30	750			8.80	225	
ACTI 7.2-200	7.2	8	200	55	120	2.09	53	
ACTI 7.2-250		10	250			2.68	68	
ACTI 7.2-300		12	300			3.23	82	
ACTI 7.2-350		14	350			4.09	104	
ACTI 7.2-380		15.2	380			3.58	91	
ACTI 7.2-400		16	400			4.69	119	
ACTI 7.2-450		18	450			5.12	130	
ACTI 7.2-500		20	500			5.75	146	
ACTI 7.2-550		22	550			6.42	163	

* UL LISTED

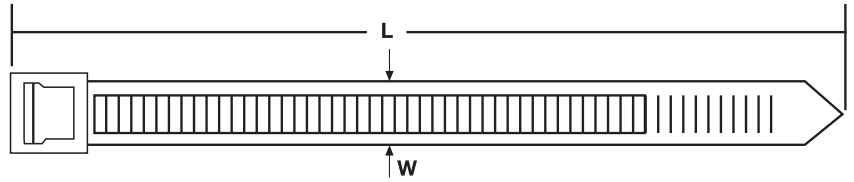
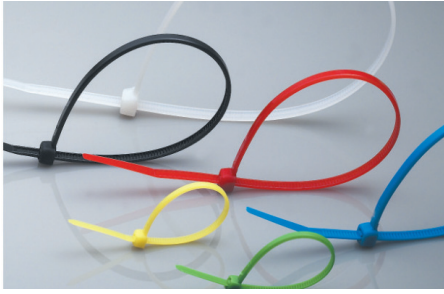

NON RELEASABLE CABLE TIES

MODEL NO.	WIDTH	LENGTH		TENSILE STRENGTH		MAXIMUM BUNDLE DIA	
	W	L		KGS	LBS	INCH	MM
	MM	INCH	MM				
ACTI 7.6-200*	7.6	8	200	55	120	2.09	53
ACTI 7.6-250*		10	250			2.68	68
ACTI 7.6-300*		12	300			3.23	82
ACTI 7.6-380*		15.2	380			3.58	91
ACTI 9.0-400	9.0	16	400	80	175	4.69	119
ACTI 9.0-450		18	450			5.12	130
ACTI 9.0-500		20	500			5.75	146
ACTI 9.0-550*		22	550			6.42	163
ACTI 9.0-600*		24	600			7.09	180
ACTI 9.0-700		28	700			8.27	210
ACTI 9.0-750		30	750			8.85	225
ACTI 9.0-800		32	800			9.45	240
ACTI 9.0-900		36	900			10.87	276
ACTI 9.0-1000		40	1000			12.01	305
ACTI 9.0-1100		44	1100			12.95	329
ACTI 9.0-1200		48	1200			13.89	353
ACTI 12.0-650		12	26			650	114
ACTI 12.0-900	36		900	10.87	276		

* UL LISTED

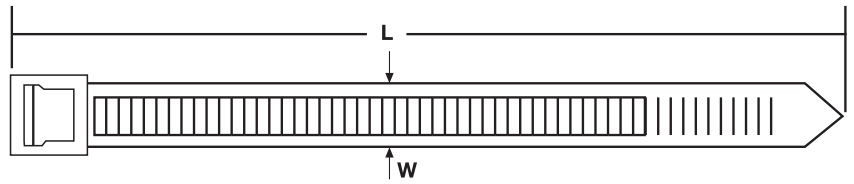
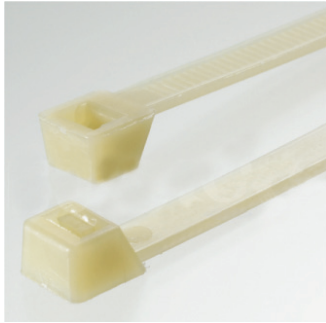

NON RELEASABLE HEAT STABILIZED CABLE TIES

Aftec Heat Stabilized (HS) cable ties provide an appropriate and elegant solution for specific applications where aesthetic and users concern is primary.

Aftec cable ties have self locking which ensures fast and easy installation and once locked cannot be reused.

Technical information

Application : For high temperature area Indoor-Outdoor

Material : Nylon 6.6

Temperature range : - 40°C to +85°C

Flammability rating : UL 94 V-2

Color : Light Green

MODEL NO.	WIDTH		LENGTH		TENSILE STRENGTH		MAXIMUM BUNDLE DIA	
	W		L		KGS	LBS	INCH	MM
	MM	INCH	MM	INCH				
ACTI 2.5-100 HS*	2.5	4	100	4	8	18	0.94	24
ACTI 3.6-150 HS*	3.6	6	150	6	18	40	1.38	35
ACTI 3.6-200 HS*		8	200				2.09	53
ACTI 4.8-200 HS*	4.8	8	200	8	22	50	2.09	53
ACTI 4.8-250 HS*		10	250				2.68	68
ACTI 4.8-300 HS*		12	300				3.39	86
ACTI 4.8-368 HS*		14.72	368				4.23	107.5
ACTI 7.6-200 HS*	7.6	8	200	8	55	120	2.09	53
ACTI 7.6-250 HS*		10	250				2.68	68
ACTI 7.6-300 HS*		12	300				3.23	82
ACTI 7.6-380 HS*		15.2	380				4.25	108
ACTI 9.0-550 HS*	9.0	22	550	22	80	175	6.42	163
ACTI 9.0-610 HS*		24.4	610				7.09	180

* UL LISTED

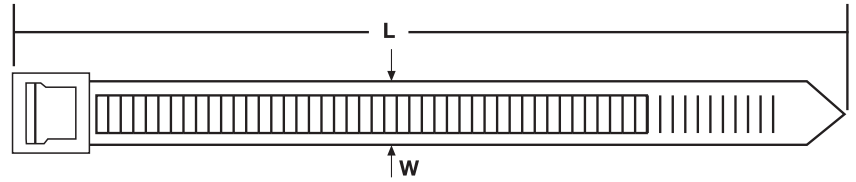
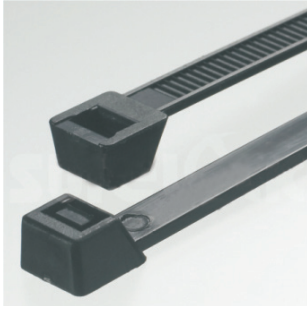

NON RELEASABLE ULTRA VIOLET CABLE TIES

Aftec Ultra Violet (UV) cable ties provide an appropriate and elegant solution for specific applications where aesthetics and users concern is primary.

Aftec cable ties have self locking which ensures fast and easy installation and once locked cannot be reused.

Technical Data

Application : For Indoor-Outdoor use (whether resistant)

Material : Nylon 6.6

Temperature range : - 40°C to + 85°C

Flammability rating : UL 94 V-2

Color : Black

MODEL NO.	WIDTH		LENGTH		TENSILE STRENGTH		MAXIMUM BUNDLE DIA	
	W		L		KGS	LBS	INCH	MM
	MM	INCH	MM	MM				
ACTI 2.5-100 UV*	2.5	4	100	8	18	0.94	24	
ACTI 2.5-150 UV		6	150			1.38	35	
ACTI 2.5-200 UV		8	200			2.09	53	
ACTI 3.6-150 UV*	3.6	6	150	18	40	1.38	35	
ACTI 3.6-200 UV*		8	200			2.09	53	
ACTI 3.6-250 UV		10	250			2.68	68	
ACTI 3.6-300 UV		12	300			3.23	82	
ACTI 4.8-200 UV*	4.8	8	200	22	50	2.09	53	
ACTI 4.8-250 UV*		10	250			2.68	68	
ACTI 4.8-300 UV*		12	300			3.39	86	
ACTI 4.8-368 UV*		14.72	368			4.23	107.5	
ACTI 4.8-450 UV		18	450			5.12	130	
ACTI 4.8-550 UV		22	550			6.50	165	
ACTI 4.8-650 UV		26	650			7.60	193	
ACTI 4.8-750 UV	30	750	8.80	225				
ACTI 7.6-200 UV*	7.6	8	200	55	120	2.09	53	
ACTI 7.6-250 UV*		10	250			2.68	68	
ACTI 7.6-300 UV*		12	300			3.23	82	
ACTI 7.6-380 UV*		15.2	380			3.58	91	
ACTI 9.0-550 UV*	9.0	22	550	80	175	6.42	163	
ACTI 9.0-600 UV*		24	600			7.09	180	
ACTI 9.0-700 UV		28	700			8.27	210	
ACTI 9.0-750 UV		30	750			8.86	225	
ACTI 9.0-800 UV		32	800			9.45	240	
ACTI 9.0-900 UV		36	900			10.87	276	
ACTI 9.0-1000 UV		40	1000			12.01	305	

* UL LISTED

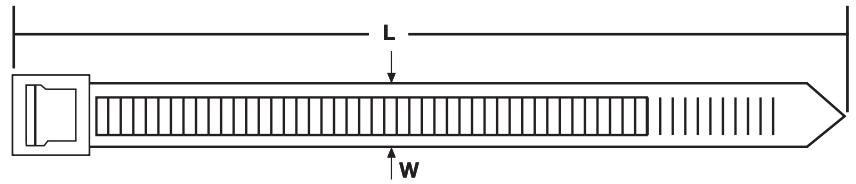
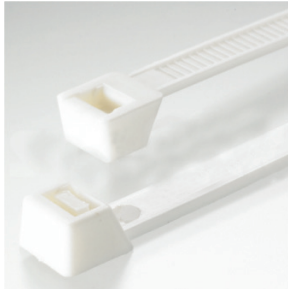

NON RELEASABLE FIRE RETARDANT CABLE TIES

Aftec Fire Retardant (FR) cable ties provide an appropriate and elegant solution for specific applications where aesthetics and users concern is primary.

Aftec cable ties have self locking which ensures fast and easy installation and once locked cannot be reused.

Technical Data

Application : For fire hazardous area

Material : Nylon 6.6

Temperature range : - 40°C to + 85°C

Flammability rating : UL 94 V-2

Color : Milky White

MODEL NO.	WIDTH		LENGTH		TENSILE STRENGTH		MAXIMUM BUNDLE DIA	
	W		L		KGS	LBS	INCH	MM
	MM	INCH	MM	MM				
ACTI 2.5-100 FR*	2.5	4	100	8	18	0.94	24	
ACTI 3.6-150 FR	3.6	6	150	18	40	1.38	35	
ACTI 3.6-200 FR*		8	200			2.09	53	
ACTI 4.8-200 FR	4.8	8	200	22	50	2.09	53	
ACTI 4.8-250 FR		10	250			2.68	68	
ACTI 4.8-300 FR		12	300			3.39	86	
ACTI 4.8-368 FR		14.72	368			4.23	107.5	
ACTI 7.6-200 FR	7.6	8	200	55	120	2.09	53	
ACTI 7.6-250 FR		10	250			2.68	68	
ACTI 7.6-300 FR		12	300			3.23	82	
ACTI 7.6-380 FR		15.2	380			3.58	91	
ACTI 9.0-550 FR	9.0	22	550	80	175	6.42	163	
ACTI 9.0-600 FR		24	600			7.09	180	

* UL LISTED

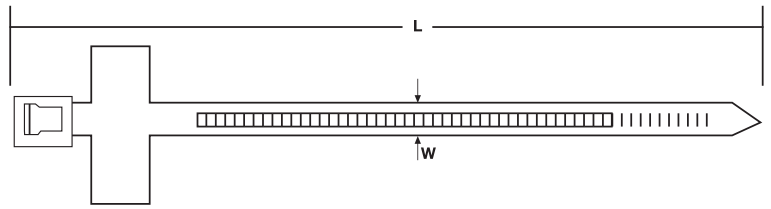
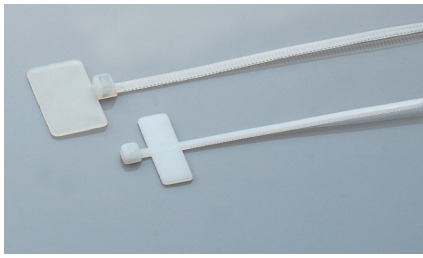

MARKER CABLE TIES

Aftec Marker ties are identification ties and trouble free insulation tying ties. Aftec Marker ties can be marked with marker pen or can be imprinted.

Technical Data

Application : For identifying purpose
 Material : Nylon 6.6
 Temperature range : - 40°C to + 85°C
 Flammability rating : UL 94 V-2
 Color : White

MODEL NO.	WIDTH		LENGTH		TENSILE STRENGTH		MAXIMUM BUNDLE DIA	
	W		L		KGS	LBS	INCH	MM
	MM	INCH	MM	MM				
ACTI 2.5-100 MT	2.5	4	100	8	18	0.95	24	
ACTI 4.8-200 MT	4.8	8	200	22	50	2.09	53	

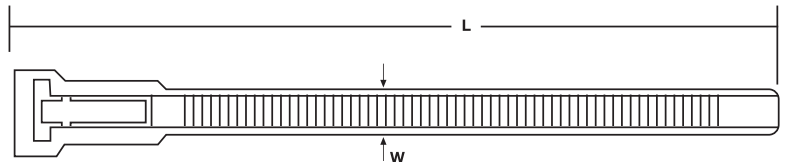
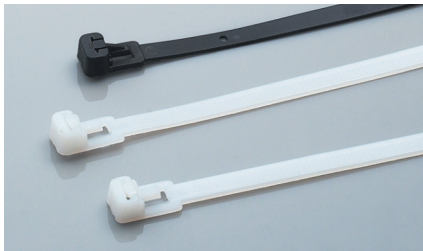

RELEASABLE CABLE TIES

Aftec Releasable cable ties permits easy release and reuse with release button even when the tie has been tied.

Technical Data

Application : For Outdoor use where changes are anticipated.
 Material : Nylon 6.6
 Temperature range : - 40°C to + 85°C
 Flammability rating : UL 94 V-2
 Color : Natural & Black

MODEL NO.	WIDTH		LENGTH		TENSILE STRENGTH		MAXIMUM BUNDLE DIA	
	W		L		KGS	LBS	INCH	MM
	MM	INCH	MM	MM				
ACTI 3.6-150 RT	3.6	6	150	18	40	1.38	35	
ACTI 4.8-200 RT	4.8	8	200	22	50	2.09	53	
ACTI 4.8-250 RT		10	250			2.68	68	
ACTI 4.8-300 RT		12	300			3.39	86	
ACTI 7.0-150 RT	7.0	6	150	55	120	1.25	32	
ACTI 7.0-200 RT		8	200			1.96	50	
ACTI 7.5-250 RT	7.5	10	250	55	120	2.55	65	
ACTI 7.5-300 RT		12	300			3.15	80	
ACTI 7.5-380 RT		15.2	380			4.13	105	

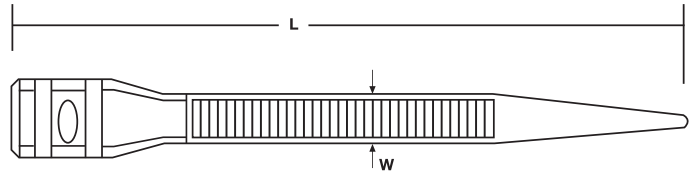

NYLON DOUBLE LOCKING TIES

Aftec Double Locking cable tie offers better tensile as compared to standard ties and serrations on the outside of tie element the risk of damaging cables.

Technical Data

Application : For Outdoor use, hazardous area securing & bundling of cables in utility and construction industries.

Material : Nylon 6.6

Temperature range : - 40°C to + 85°C

Flammability rating : UL 94 V-2

Color : Natural & Black

MODEL NO.	WIDTH	LENGTH		TENSILE STRENGTH		MAXIMUM BUNDLE DIA	
	W	L		KGS	LBS	INCH	MM
	MM	INCH	MM				
ACTI 9.0-235 DL	9.0	9.4	235	55	120	2.16	55
ACTI 9.0-300 DL		12	300			3.46	88
ACTI 9.0-360 DL		14.4	360			3.93	100

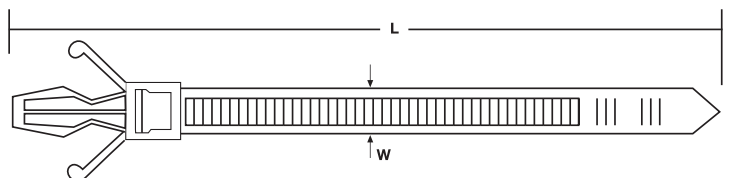
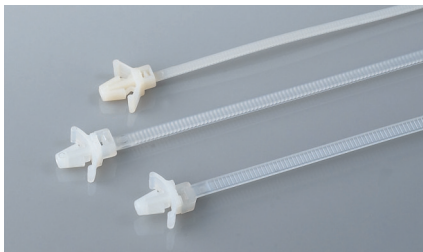

NYLON PUSH MOUNT CABLE TIES

Aftec Push Mount cable ties are piece construction design eliminates the use of screw or adhesive mounts to hold cable bundle to a surface such as flat panel.

Technical Data

Application : For fastening and clip mounts in one where cable tie along with cable wire harness assembly should with stand vibration & constant higher temperature.

Material : Nylon 6.6

Temperature range : - 40°C to + 85°C

Flammability rating : UL 94 V-2

Color : Natural

MODEL NO.	WIDTH	LENGTH		TENSILE STRENGTH		MAXIMUM BUNDLE DIA	
	W	L		KGS	LBS	INCH	MM
	MM	INCH	MM				
ACTI 4.8-145 PT	4.8	5.8	145	22	50	1.18	30
ACTI 4.8-200 PT		8	200			2.09	53

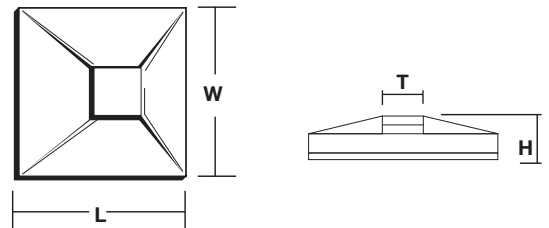

CABLE TIE MOUNTS

Aftec cable tie mounts are used with Aftec nylon ties to simplify the mounts of wires & cables on plain surface. To apply simply peel off paper and apply mount to surface.

Technical data

Application : To support light weight wire bundles, should be applied on plain and clean surface.
 Material : Nylon 6.6
 Temperature range : - 29°C to + 49°C
 Flammability rating : UL 94 V-2
 Color : Natural

MODEL NO.	WIDTH	LENGTH		HEIGHT	TIE WIDTH MAX	STD. QTY/ BAG
	W	L		H	T	
	MM	INCH	MM	MM	MM	
ACTM 20	20	0.8	20	6.00	3.60	100 Pcs.
ACTM 25	25	1.0	25	7.00	4.80	
ACTM 30	30	1.2	30	8.00	7.60	
ACTM 40	30	1.6	40	9.00	9.20	



SCREW SADDLE MOUNTS

Screw saddle type provides maximum stability to wire bundles, to apply fix mount with a screw and secure wire bundles with Aftec nylon cable ties.

Technical data

Application : For holding wires, cable bundle and help routing of the same as designed.
 Material : Nylon 6.6
 Temperature range : - 40°C to + 85°C
 Flammability rating : UL 94 V-2
 Color : Natural

MODEL NO.	WIDTH	LENGTH		HEIGHT	TIE WIDTH MAX	STD. QTY/ BAG
	W	L		H	T	
	MM	INCH	MM	MM	MM	
ASM 1	10.2	0.62	15.5	7.00	3.60	100 Pcs.
ASM 2	11.5	0.7	16.5	7.20	4.80	
ASM 3	17.5	0.88	22	10.20	9.20	
ASM 4	18.4	1.72	43	15.90	12.50	

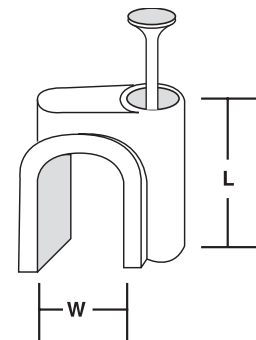

CIRCLE CABLE CLIPS

Circle cable clips are used for securing wires, cables to nail able surface.

Technical Data

Material : Nylon 6.6
 Temperature range : - 40°C to + 85°C
 Flammability rating : UL 94 V-2
 Color : White, Black & Gray

MODEL NO.	WIDTH		LENGTH		MODEL NO.	WIDTH		LENGTH	
	W		L			W		L	
	MM	INCH	MM	MM		MM	INCH	MM	
ACL 4	4	0.21	5.3		ACL 16	16	0.67	16.9	
ACL 5	5	0.3	6.5		ACL 18	18	0.8	20.8	
ACL 6	6	0.32	8.1		ACL 20	20	0.95	23.6	
ACL 8	8	0.35	8.7		ACL 22	22	1	25.0	
ACL 9	9	0.38	9.6		ACL 25	25	1.10	27.7	
ACL 10	10	0.42	10.7		ACL 30	30	1.32	33.1	
ACL 12	12	0.51	12.8		ACL 35	35	1.46	36.6	
ACL 14	14	0.6	14.9		ACL 40	40	1.8	45.2	

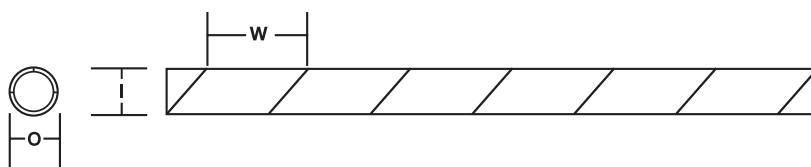
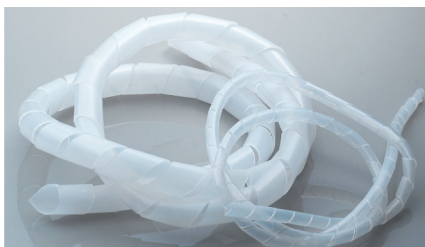

SPIRAL WRAPPING BANDS

Afttec spiral wrapping bands are for protection of wire bundles ranging from 4.8mm to 170mm and harness multiple cables into a single manageable bundle.

Technical Data

Application : Abrasion protection for control panel wiring.
 Material : Polyester
 Temperature range : - 40°C to + 85°C
 Color : Natural & Black

MODEL NO.	WIDTH		INSIDE DIA	OUTSIDE DIA	WRAPPING RANGE		STD. QTY/ BAG
	W				MIN	MAX	
	INCH	MM	MM	MM			
ASW 6	0.24	6	5	6	4.8	40.0	10 Mtrs.
ASW8	0.32	8	7.8	9	8	76.0	
ASW 10	0.4	10	8.5	10	10	89.0	
ASW 12	0.48	12	10.6	12	19.1	102.0	
ASW 16	0.64	16	14.4	16	22	114.0	
ASW 20	0.8	20	18.2	20	25	127.0	
ASW 25	1	25	23.2	25	32	135.0	
ASW 38	1.52	38	34.8	38	43	170.0	

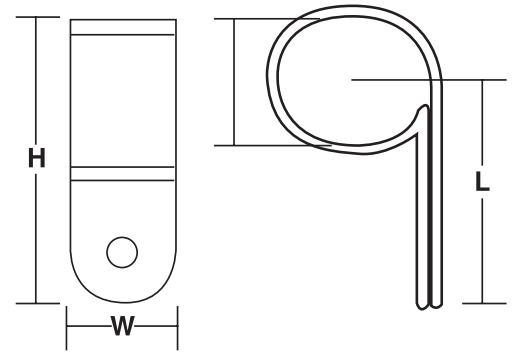

NYLON 'P' CLIP

Aftec Nylon P clips offers easy installation and economical assembly for a wide variety of application & most versatile clips to hold cables & tubes.

Technical Data

Application : For Indoor application.
 Material : Nylon 6.6
 Temperature range : - 40°C to + 85°C
 Flammability rating : UL 94 V-2
 Color : Natural & Black

MODEL NO.	MAXIMUM BUNDLE DIA		WIDTH	LENGTH		HOLE	STD. QTY/ BAG
	INCH	MM	W	L		H	
			MM	INCH	MM	MM	
APC 3	0.12	3.0	6	0.54	13.5	4.0	100 Pcs.
APC 4.5	0.18	4.5	6	0.66	16.5	3.4	
APC 6.0	0.24	6.0	8.6	0.70	17.5	4.0	
APC 7.5	0.30	7.5	9.5	0.88	22.0	4.1	
APC 9.0	0.35	9.0	9.5	0.92	23.0	4.0	
APC 10.0	0.39	10.0	9.5	1.00	25.0	4.2	
APC 12.5	0.49	12.5	11.5	1.16	29.0	4.3	
APC 15.0	0.59	15.0	11.8	1.30	32.5	4.5	
APC 19.0	0.75	19.0	11.8	1.48	37.0	4.6	
APC 25.0	0.98	25.0	15	1.78	44.5	6.0	



STAINLESS STEEL CABLE TIES

Aftec stainless steel ties provide a high mechanical strength for Indoor and Outdoor applications. Stainless steel ties are designed for use in critical applications where strength, vibration, radiation, weathering corrosion and temperature extremes are major factors.

They are available in different types

STAINLESS STEEL BALL LOCK CABLE TIES

BALL LOCK STAINLESS STEEL POLYESTER COATED CABLE TIES

RELEASABLE STAINLESS STEEL CABLE TIES

RELEASABLE STAINLESS STEEL POLYESTER COATED CABLE TIES

EASY LOCK STAINLESS STEEL CABLE TIES

EASY LOCK STAINLESS STEEL POLYESTER COATED CABLE TIES

MULTI LOCK STAINLESS STEEL CABLE TIES

MULTI LOCK STAINLESS STEEL POLYESTER COATED CABLE TIES

EMBOSSABLE STAINLESS STEEL TAGS

SLIDE ON STAINLESS STEEL CARRIER RAILS

SLIDE ON STAINLESS STEEL MARKERS

STAINLESS STEEL BAND

STAINLESS STEEL POLYESTER COATED BAND

STAINLESS STEEL PERFORATED BETA STRIP

STAINLESS STEEL PERFORATED POLYESTER COATED BETA STRIP

STAINLESS STEEL ACCESSORIES

Aftec stainless steel accessories available for mounting of wires, cable and tubing with Aftec stainless steel cable ties.

SLIDE ON STAINLESS STEEL JAW BUCKLE

SLIDE ON STAINLESS STEEL CLIP

CABLE TIES



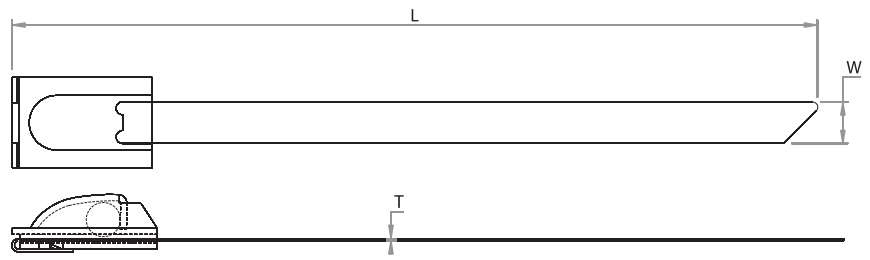

STAINLESS STEEL BALL LOCK CABLE TIE

Aftec Stainless Steel Ball Lock cable ties are self locking for fast & easy installation. 316 grade Stainless steel which provides excellent resistance to extreme conditions, corrosion, weather and UV radiation.

Technical Data

Application : For Indoor-Outdoor applications. Installation of cables, wire & pipes in extreme conditions and hazardous area.

Material : SS 316 L non-magnetic stainless steel.

Operating temperature : - 80°C to + 538°C.

Flammability rating : Fire proof, UV-resistant.

MODEL NO.	WIDTH		LENGTH		TENSILE STRENGTH		MAXIMUM BUNDLE DIA		THICKNESS
	W		L		KGS	LBS	INCH	MM	T
	MM	INCH	MM						MM
ACTI 4.6-100 BL	4.6		4	100	60	132	0.86	22	0.25
ACTI 4.6-150 BL*			6	150			1.18	30	
ACTI 4.6-200 BL*			8	200			1.97	50	
ACTI 4.6-260 BL*			10.4	260			2.76	70	
ACTI 4.6-300 BL*			12	300			3.35	85	
ACTI 4.6-360 BL*			14.4	360			3.94	100	
ACTI 4.6-450 BL*			18	450			5.12	130	
ACTI 4.6-520 BL*			20.8	520			5.91	150	
ACTI 4.6-610 BL*			24.4	610			7.09	180	
ACTI 4.6-680 BL*			27.2	680			7.87	200	
ACTI 4.6-840 BL*			33.6	840			9.84	250	
ACTI 4.6-1000 BL*			40	1000			11.81	300	
ACTI 7.9-150 BL*	7.9		6	150	170	375	0.98	25	0.25
ACTI 7.9-200 BL*			8	200			1.97	50	
ACTI 7.9-260 BL*			10.4	260			2.76	70	
ACTI 7.9-300 BL*			12	300			3.35	85	
ACTI 7.9-360 BL*			14.4	360			3.94	100	
ACTI 7.9-450 BL*			18	450			5.12	130	
ACTI 7.9-520 BL*			20.8	520			5.91	150	
ACTI 7.9-610 BL*			24.4	610			7.09	180	
ACTI 7.9-680 BL*			27.2	680			7.87	200	
ACTI 7.9-840 BL*			33.6	840			9.84	250	

* UL LISTED

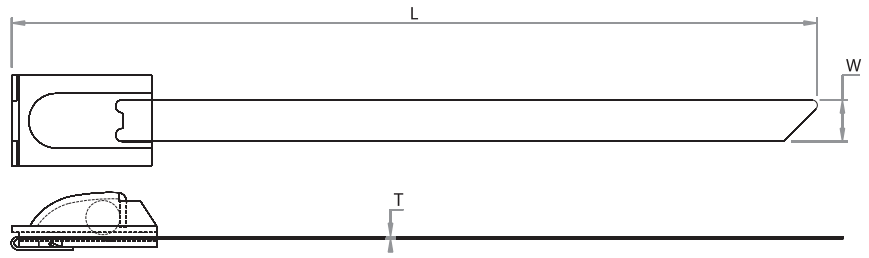

STAINLESS STEEL BALL LOCK CABLE TIES POLYESTER COATED

Aftec Stainless Steel Ball Lock Polyester Coated cable ties are self locking for fast & easy installation. Polyester coating ties are halogen free & nontoxic which provides improved installation between dissimilar materials which are excellent resistance to mist, chemicals and salt sprays.

Technical Data

Application : For Indoor-Outdoor application. Installation of cables, wire & pipes in extreme conditions and hazardous area.

Material : SS 316 L non-magnetic stainless steel.

Operating temperature : - 80°C to + 150°C.

Flammability rating : Halogen free, Low smoke, nontoxic, UV resistance.

Coating : UL 94V-0, polyester coated.

MODEL NO.	WIDTH		LENGTH		TENSILE STRENGTH		MAXIMUM BUNDLE DIA		THICKNESS
	W	L							T
	MM	INCH	MM		KGS	LBS	INCH	MM	MM
ACTI 4.6-100 BLP	4.6	4	100	60	132	0.86	22	0.38	
ACTI 4.6-150 BLP*		6	150			1.18	30		
ACTI 4.6-200 BLP*		8	200			1.97	50		
ACTI 4.6-260 BLP*		10.4	260			2.76	70		
ACTI 4.6-300 BLP*		12	300			3.35	85		
ACTI 4.6-360 BLP*		14.4	360			3.94	100		
ACTI 4.6-450 BLP*		18	450			5.12	130		
ACTI 4.6-520 BLP*		20.8	520			5.91	150		
ACTI 4.6-610 BLP*		24.4	610			7.09	180		
ACTI 4.6-680 BLP*		27.2	680			7.87	200		
ACTI 4.6-840 BLP*		33.6	840			9.84	250		
ACTI 4.6-1000 BLP*		40	1000			11.81	300		
ACTI 7.9-150 BLP*	7.9	6	150	170	375	0.98	25	0.38	
ACTI 7.9-200 BLP*		8	200			1.97	50		
ACTI 7.9-260 BLP*		10.4	260			2.76	70		
ACTI 7.9-300 BLP*		12	300			3.35	85		
ACTI 7.9-360 BLP*		14.4	360			3.94	100		
ACTI 7.9-450 BLP*		18	450			5.12	130		
ACTI 7.9-520 BLP*		20.8	520			5.91	150		
ACTI 7.9-610 BLP*		24.4	610			7.09	180		
ACTI 7.9-680 BLP*		27.2	680			7.87	200		
ACTI 7.9-840 BLP*		33.6	840			9.84	250		

* UL LISTED

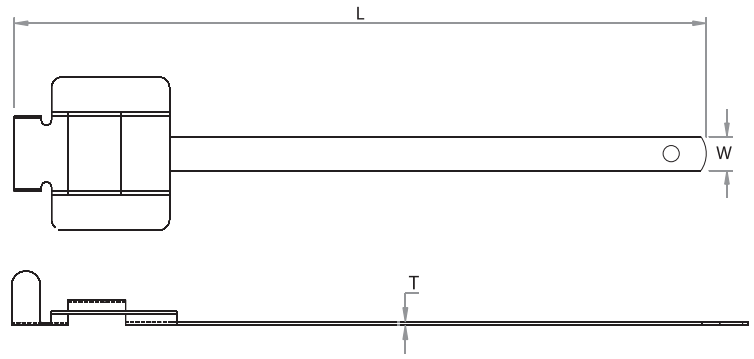

RELEASABLE STAINLESS STEEL CABLE TIES

Aftec Releasable Stainless Steel cable ties are designed for quick fastening and also be unfastened for reuse, which accommodate double wrapping. (SS 316) Stainless steel which provides excellent resistant to extreme conditions, corrosion, whether and UV radiation.

Technical Data

Application : For Indoor -Outdoor application. Installation of cables, wire & pipes in extreme conditions and hazardous area.

Material : SS 316 L nonmagnetic stainless steel.

Operating temperature : - 80°C to + 538°C.

Flammability rating : Fire proof, UV – resistant.

MODEL NO.	WIDTH		LENGTH		TENSILE STRENGTH		MAXIMUM BUNDLE DIA		THICKNESS
	W		L		KGS	LBS	INCH	MM	T
	MM	INCH	MM						MM
ACTI 6.3-152 RS*	6.3		6.08	152	149	330	1.30	33	0.50
ACTI 6.3-229 RS*			9.16	229			2.28	58	
ACTI 6.3-305 RS*			12.2	305			3.19	81	
ACTI 6.3-457 RS*			18.28	457			5.20	132	
ACTI 6.3-500 RS*			20	500			5.91	150	
ACTI 6.3-610 RS*			24.4	610			7.09	180	
ACTI 9.5-152 RS*	9.5		6.08	152	181	400	1.30	33	0.50
ACTI 9.5-229 RS*			9.16	229			2.28	58	
ACTI 9.5-305 RS*			12.2	305			3.19	81	
ACTI 9.5-457 RS*			18.28	457			5.20	132	
ACTI 9.5-500 RS*			20	500			5.91	150	
ACTI 9.5-610 RS*			24.4	610			7.09	180	
ACTI 9.5-762 RS*			30.48	762			8.90	226	
ACTI 9.5-914 RS*			36.56	914			10.83	275	

* UL LISTED

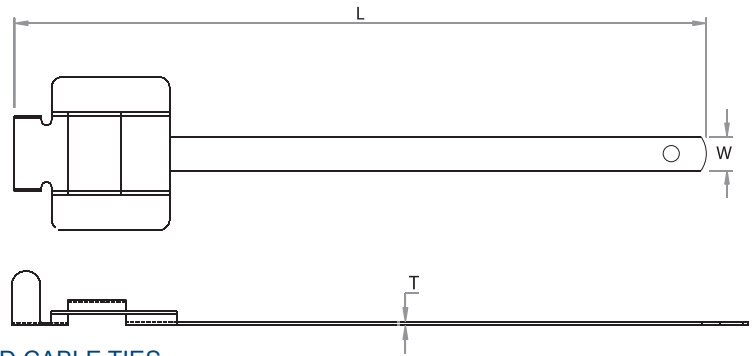

RELEASABLE STAINLESS STEEL POLYESTER COATED CABLE TIES

Aftec Releasable Stainless Steel Polyester coated cable ties are designed for quick fastening and unfastening for reuse. It is also designed to accommodate double wraps. Polyester coating are halogen free, nontoxic low smoke for better protection of cables and for installer safety.

Technical Data

Application : For Indoor -Outdoor application, installation of cables, wire & pipes in extreme conditions and hazardous area.

Material : SS 316 L nonmagnetic stainless steel.

Operating temperature : - 80°C to + 150°C.

Flammability rating : Halogen free, low smoke, nontoxic, UV resistance.

Coating : UV 94V-0, Polyester coated

MODEL NO.	WIDTH		LENGTH		TENSILE STRENGTH		MAXIMUM BUNDLE DIA		THICKNESS
	W		L						T
	MM	INCH	MM		KGS	LBS	INCH	MM	MM
ACTI 6.3-152 RSP*	6.3		6.08	152	149	330	1.30	33	1.10
ACTI 6.3-229 RSP*			9.16	229			2.28	58	
ACTI 6.3-305 RSP*			12.2	305			3.19	81	
ACTI 6.3-457 RSP*			18.28	457			5.20	132	
ACTI 6.3-500 RSP*			20	500			5.91	150	
ACTI 6.3-610 RSP*			24.4	610			7.09	180	
ACTI 9.5-152 RSP*	9.5		6.08	152	181	400	1.30	33	1.10
ACTI 9.5-229 RSP*			9.16	229			2.28	58	
ACTI 9.5-305 RSP*			12.2	305			3.19	81	
ACTI 9.5-457 RSP*			18.28	457			5.20	132	
ACTI 9.5-500 RSP*			20	500			5.91	150	
ACTI 9.5-610 RSP*			24.4	610			7.09	180	
ACTI 9.5-762 RSP*			30.48	762			8.90	226	
ACTI 9.5-914 RSP*			36.56	914			10.83	275	

* UL LISTED

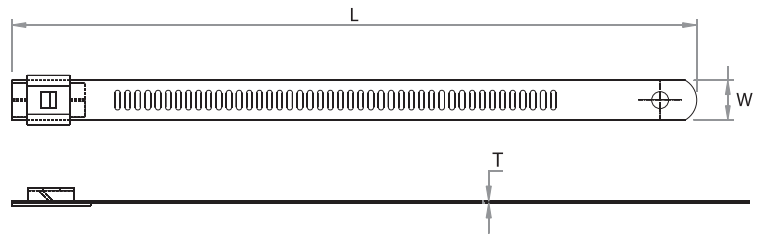

EASY LOCK STAINLESS STEEL CABLE TIES

Aftec Easy Lock Stainless Steel cable ties are self locking with multiple locking systems which are designed for fast, stronger and secure installation with no sharp edges. 316 grade Stainless steel which provides excellent resistant to extreme conditions, corrosion, whether and UV radiation, which also has slots till end for large bundle diameter with the same tie length.

Technical Data

Application : For Indoor-Outdoor application. Installation of cables, wire & pipes in extreme conditions and hazardous area.

Material : SS 316 L nonmagnetic stainless steel.

Operating temperature : - 80°C to + 538°C.

Flammability rating : Fire proof, UV – resistant.

MODEL NO.	WIDTH		LENGTH		TENSILE STRENGTH		MAXIMUM BUNDLE DIA		THICKNESS
	W		L						T
	MM	INCH	MM	INCH	KGS	LBS	INCH	MM	MM
ACTI 7-150 EL*	7	6	150	45	100	1.57	40	0.25	
ACTI 7-200 EL*		8	200			2.17	55		
ACTI 7-225 EL*		9	225			2.56	65		
ACTI 7-250 EL*		10	250			2.95	75		
ACTI 7-300 EL*		12	300			3.54	90		
ACTI 7-360 EL*		14.4	360			3.94	100		
ACTI 7-450 EL*		18	450			4.33	110		
ACTI 7-600 EL*		24	600			5.31	135		
ACTI 7-610 EL*		24.4	610			5.71	145		
ACTI 7-750 EL*		30	750			7.68	195		
ACTI 7-1000 EL*		40	1000			11.61	295		
ACTI 12-150 EL*	12	6	150	111	250	1.57	40	0.25	
ACTI 12-200 EL*		8	200			2.17	55		
ACTI 12-225 EL*		9	225			2.56	65		
ACTI 12-250 EL*		10	250			2.95	75		
ACTI 12-300 EL*		12	300			3.54	90		
ACTI 12-360 EL*		14.4	360			3.94	100		
ACTI 12-450 EL*		18	450			4.33	110		
ACTI 12-600 EL*		24	600			5.31	135		
ACTI 12-610 EL*		24.4	610			5.71	145		
ACTI 12-750 EL*		30	750			7.68	195		
ACTI 12-1000 EL*		40	1000			11.61	295		

* UL LISTED

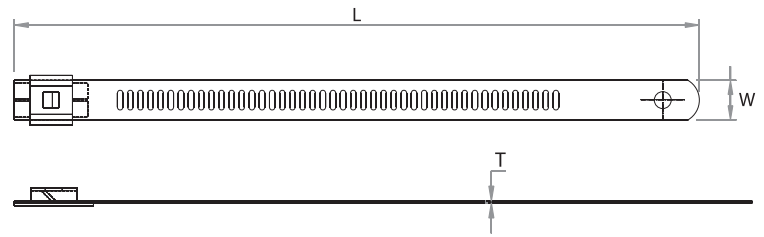
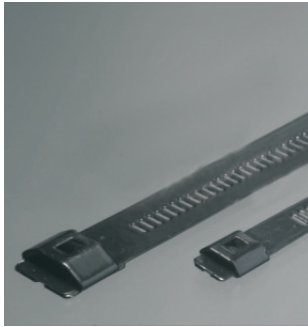

EASY LOCK STAINLESS STEEL CABLE TIES POLYESTER COATED

Aftec Easy Lock Stainless Steel Polyester coated cable ties are self locking with multiple locking system which are designed for fast stronger and secure installation with no sharp edges which also has slots till end for large bundle diameter with the same tie length. Polyester coating are halogen free, nontoxic low smoke for better protection of cables and for human safety.

Technical Data

Application : For Indoor-Outdoor application. Installation of cables, wire & pipes in extreme conditions and hazardous area.

Material : SS 316 L nonmagnetic stainless steel.

Operating temperature : - 80°C to + 150°C.

Flammability rating : Halogen free, low smoke, nontoxic, UV resistance.

Coating : UV 94V-0, Polyester coated.

MODEL NO.	WIDTH		LENGTH		TENSILE STRENGTH		MAXIMUM BUNDLE DIA		THICKNESS
	W	L	T						
	MM	INCH	MM	KGS	LBS	INCH	MM	MM	
ACTI 7-150 ELP*	7	6	150	45	100	1.57	40	0.40	
ACTI 7-200 ELP*		8	200			2.17	55		
ACTI 7-225 ELP*		9	225			2.56	65		
ACTI 7-250 ELP*		10	250			2.95	75		
ACTI 7-300 ELP*		12	300			3.54	90		
ACTI 7-360 ELP*		14.4	360			3.94	100		
ACTI 7-450 ELP*		18	450			4.33	110		
ACTI 7-600 ELP*		24	600			5.31	135		
ACTI 7-610 ELP*		24.4	610			5.71	145		
ACTI 7-750 ELP*		30	750			7.68	195		
ACTI 7-1000 ELP*		40	1000			11.61	295		
ACTI 12-150 ELP*	12	6	150	111	250	1.57	40	0.40	
ACTI 12-200 ELP*		8	200			2.17	55		
ACTI 12-225 ELP*		9	225			2.56	65		
ACTI 12-250 ELP*		10	250			2.95	75		
ACTI 12-300 ELP*		12	300			3.54	90		
ACTI 12-360 ELP*		14.4	360			3.94	100		
ACTI 12-450 ELP*		18	450			4.33	110		
ACTI 12-600 ELP*		24	600			5.31	135		
ACTI 12-610 ELP*		24.4	610			5.71	145		
ACTI 12-750 ELP*		30	750			7.68	195		
ACTI 12-1000 ELP*		40	1000			11.61	295		

* UL LISTED

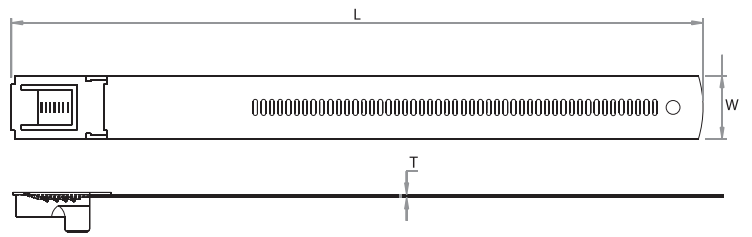

MULTI LOCK STAINLESS STEEL CABLE TIES

Aftec Multi Lock Stainless Steel cable ties are self locking with multiple locking systems for stronger and secured hold. Designed to accommodate double wrapping with no sharp edges. It also has slots till end for large bundle diameters with the same length. 316 grade Stainless steel provides excellent resistance to extreme conditions, corrosion, whether and UV radiation.

Technical Data

Application : For indoor and outdoor application. Installation of cables, wire & pipes in extreme conditions and hazardous area.

Material : SS 316 L nonmagnetic stainless steel.

Operating temperature : - 80°C to + 538°C.

Flammability rating : Fire proof, UV – resistant.

MODEL NO.	WIDTH	LENGTH		TENSILE STRENGTH		MAXIMUM BUNDLE DIA		THICKNESS
	W	L				INCH	MM	T
	MM	INCH	MM	KGS	LBS			MM
ACTI 7-150 ML*	7.0	6	150	60	132	1.65	42	0.25
ACTI 7-225 ML*		9	225			2.56	65	
ACTI 7-300 ML*		12	300			3.54	90	
ACTI 7-450 ML*		18	450			5.31	135	
ACTI 7-610 ML*		24.4	610			7.20	183	
ACTI 12-150 ML*	12.0	6	150	130	286	1.65	42	0.25
ACTI 12-225 ML*		9	225			2.56	65	
ACTI 12-300 ML*		12	300			3.54	90	
ACTI 12-450 ML*		18	450			5.31	135	
ACTI 12-610 ML*		24.4	610			7.20	183	

* UL LISTED

CABLE TIES

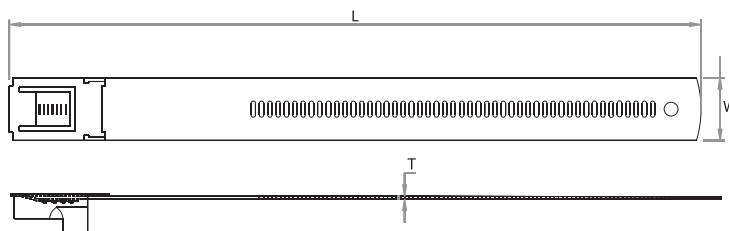

MULTI LOCK STAINLESS STEEL CABLE TIES POLYESTER COATED

Aftec Multi Lock Stainless Steel Polyester coated cable ties are self locking with multiple locking system for stronger and secure hold. Designed to accommodate double wrapping with no sharp edges. It also has slots till end for large bundle diameters with the same length. Polyester coating are halogen free, nontoxic low smoke for better protection of cables and for human safety, and easy installation between dissimilar materials.

Technical Data

Application : For indoor and outdoor application. Installation of cables, wire & pipes in extreme conditions and hazardous area.
 Material : SS 316 non L magnetic stainless steel.
 Operating temperature : - 80°C to + 150°C.
 Flammability rating : Halogen free, low smoke, nontoxic, UV resistance.
 Coating : UV 94V-0, Polyester coated.

MODEL NO.	WIDTH	LENGTH		TENSILE STRENGTH		MAXIMUM BUNDLE DIA		THICKNESS
	W	L				INCH	MM	T
	MM	INCH	MM	KGS	LBS			MM
ACTI 7-150 MLP*	7.0	6	150	60	132	1.65	42	0.38
ACTI 7-225 MLP*		9	225			2.56	65	
ACTI 7-300 MLP*		12	300			3.54	90	
ACTI 7-450 MLP*		18	450			5.31	135	
ACTI 7-610 MLP*		24.4	610			7.20	183	
ACTI 12-150 MLP*	12.0	6	150	130	286	1.65	42	0.38
ACTI 12-225 MLP*		9	225			2.56	65	
ACTI 12-300 MLP*		12	300			3.54	90	
ACTI 12-450 MLP*		18	450			5.31	135	
ACTI 12-610 MLP*		24.4	610			7.20	183	

* UL LISTED

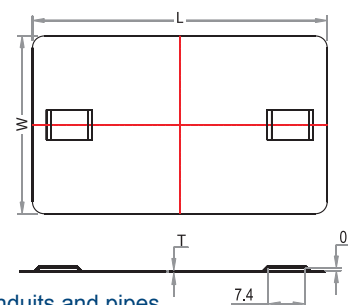

EMBOSSABLE STAINLESS STEEL TAGS

Aftec Embossable Stainless Steel Tags offers permanent identification of cables, hoses, conduits and pipes.

Technical Data

Application : For harsh environments such as petrochemical, marine, construction, power etc.
 Material : SS 316 L nonmagnetic stainless steel.
 Operating temperature : - 80°C to + 538°C.

MODEL NO.	WIDTH	LENGTH		THICKNESS	STD. QTY/ BAG
	W	L		T	
	MM	INCH	MM	MM	
AMS - 51SS	19	2.04	51	0.25	100 Pcs.
AMS - 63SS	38	2.52	63	0.40	
AMS - 89SS	19	3.56	89	0.40	
AMS - 115SS	9.9	4.6	115	0.30	

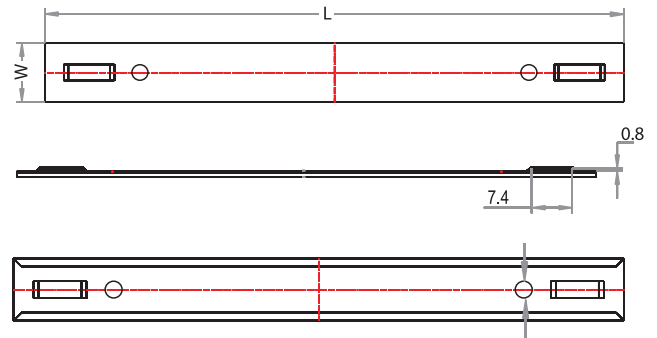
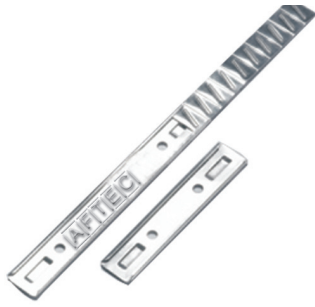

SLIDE ON STAINLESS STEEL CARRIER RAIL

Aftec Slide on pre marked marker strip is required to slide inside the carrier rails.

Technical Data

Application : For Multi lock, Easy lock & Ball lock stainless steel ties.
 Materia : SS 316 non magnetic stainless steel.
 Operating temperature : - 80°C to + 538°C.

MODEL NO.	WIDTH		LENGTH		MAX CAPACITY MARKERS PER RAILS	STD. QTY/ BAG
	W		L			
	MM	INCH	MM			
ACR - 46SS	11	1.84	46		6	100 Pcs.
ACR - 56SS	11	2.24	56		8	
ACR - 82SS	11	3.28	82		12	
ACR-106SS	11	4.24	106		16	
ACR-286SS	11	11.44	286		46	



SLIDE ON STAINLESS STEEL MARKER

Aftec Slide on Stainless steel markers are used with carrier rails. Marker strips are with 10mm height and are available in Alphabets, Numbers and Symbols.

Application : For safety and quick installation. Stainless steel marking system for extreme & hazardous environment.

Technical Data

Material : SS 316 L non magnetic stainless steel.
 Operating temperature : - 80°C to + 538°C.
 STD.QTY : 100pcs/Bag.

MODEL NO.	MODEL NO.	MODEL NO.	MODEL NO.	MODEL NO.	MODEL NO.
ASSM-A	ASSM-H	ASSM-O	ASSM-V	ASSM-2	ASSM-9
ASSM-B	ASSM-I	ASSM-P	ASSM-W	ASSM-3	ASSM- (-)
ASSM-C	ASSM-J	ASSM-Q	ASSM-X	ASSM-4	ASSM-(+)
ASSM-D	ASSM-K	ASSM-R	ASSM-Y	ASSM-5	ASSM- (/)
ASSM-E	ASSM-L	ASSM-S	ASSM-Z	ASSM-6	ASSM- ⊥ EARTH
ASSM-F	ASSM-M	ASSM-T	ASSM-0	ASSM-7	
ASSM-G	ASSM-N	ASSM-U	ASSM-1	ASSM-8	

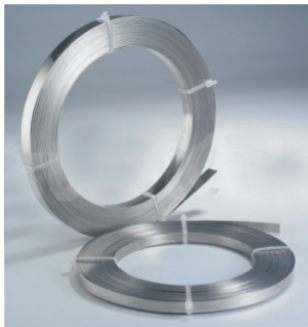

STAINLESS STEEL BAND

Aftec Stainless Steel Bands have high strength fastening feature and the cable can be clamped quickly with the use of buckles & clips which provides site jobs fast, easy and less inventory.

Technical Data

Application : For Outdoor applications. Installation of cables, wire & pipes that requires various bundle diameters where the exact requirement lengths cannot be predetermined.

Material : SS 316 L non-magnetic stainless steel.

Operating temperature : - 80°C to + 538°C.

Flammability rating : Fire proof, UV-resistant

Packing : 25 meters roll

MODEL NO.	WIDTH	TENSILE STRENGTH		LENGTH	THICKNESS	USED WITH	
	W			L	T	JAW BUCKLE	CLIP
	MM	KGS	LBS	METERS	MM	PART NO	
ASSB 9.5U	9.5	340	750	30.5	0.63	ASSB-9U	ASSC-9U
ASSB 13U	12.7	543	1200	30.5	0.76	ASSB-13U	ASSC-13U
ASSB 16U	15.9	680	1500	30.5	0.76	ASSB-16U	ASSC-16U
ASSB 19U	19.0	815	1800	30.5	0.76	ASSB-19U	ASSC-19U

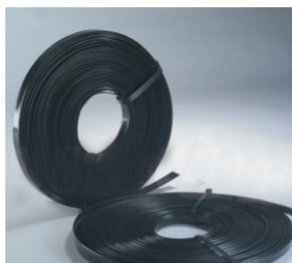

STAINLESS STEEL POLYESTER COATED BAND

Aftec Stainless Steel Polyester Coated Bands are high strength fastening feature and can be clamped quickly with the use of buckles & clips which provides site jobs fast, easy and less inventory. Polyester coating provides edge protection and prevents corrosion between dissimilar metals.

Application: For Outdoor applications. Installation of cables, wire & pipes that requires various bundle diameters where the exact requirement lengths cannot be predetermined.

Technical Data

Material : SS 316 L non-magnetic stainless steel.

Operating temperature : - 80°C to + 150°C.

Flammability rating : Halogen free, Low smoke, nontoxic, UV resistance.

Coating : UL 94V-0, polyester coated.

Packing : 25 meters roll

MODEL NO.	WIDTH	TENSILE STRENGTH		LENGTH	THICKNESS	USED WITH	
	W			L	T	JAW BUCKLE	CLIP
	MM	KGS	LBS	METERS	MM	PART NO	
ASSB 9.5C	9.5	228	505	25	1.22	ASSB-9U	ASSC-9U
ASSB 13C	12.7	303	670	25	1.22	ASSB-13U	ASSC-13U
ASSB 16C	15.9	380	840	25	1.22	ASSB-16U	ASSC-16U
ASSB 19C	19.0	453	1000	25	1.22	ASSB-19U	ASSC-19U



STAINLESS STEEL PERFORATED BETA STRIP

Aftec Stainless Steel Perforated Beta Strip can be easily applied with nut, bolt & no tools are required for installation.

Technical Data

Application : Applied where high vibration is the concern.
 Material : SS 316 L non-magnetic stainless steel.
 Operating temperature : - 80°C to + 538°C.
 Coating : Black PPA - thermoplastic.
 Packing : 25 meters.

MODEL NO.	WIDTH	HOLE DIA		LENGTH	THICKNESS
	W			L	T
	MM	INCH	MM	METERS	MM
APBS 13U	12.7	0.2	5	25	0.76
APBS 19U	19	0.28	7	25	0.76
APBS 26U	25.4	0.32	8	25	0.76



STAINLESS STEEL PERFORATED POLYESTER COATED BETA STRIP

Aftec Stainless Steel Polyester Coated Beta Strip can be easily applied with nut, bolt & no tools are required for installation.

Technical Data

Application : Applied where high vibration is the concern.
 Material : SS 316 L non-magnetic stainless steel.
 Operating temperature : - 80°C to + 150°C.
 Coating : UL 94V-0, polyester coated.

MODEL NO.	WIDTH	HOLE DIA		LENGTH	THICKNESS
	W			L	T
	MM	INCH	MM	METERS	MM
APBS 13C	12.7	0.2	5	25	1.3
APBS 19C	19	0.28	7	25	1.3
APBS 26C	25.4	0.32	8	25	1.3

Note:-For ordering hot dip galvanized, replace Catalogue No. with suffix HDG.

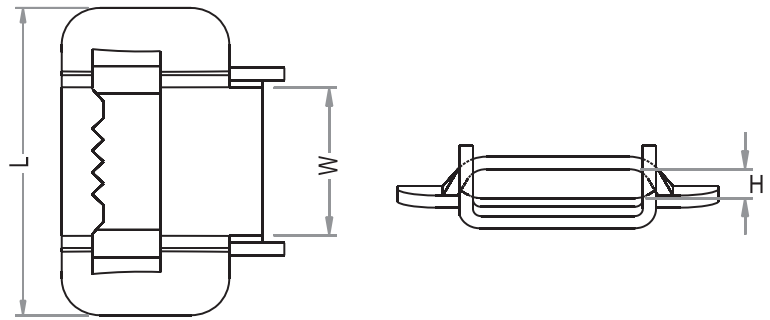

STAINLESS STEEL JAW BUCKLE

Aftec Stainless Steel Jaw Buckles are designed to accommodate both single and double wrapping of bundles. The jaws and wings are provided for maximum clamping strength.

Technical Data:

Material : SS 316 L non-magnetic stainless steel.

MODEL NO.	WIDTH	LENGTH	HEIGHT	STD. QTY/ BAG
	W	L	H	
	MM	MM	MM	
ASSB-9U	12.77	23.28	3.72	100 PCS
ASSB-13U	16.03	32.17	3.99	
ASSB-16U	19.07	34.5	3.98	
ASSB-19U	22.3	42.24	3.97	

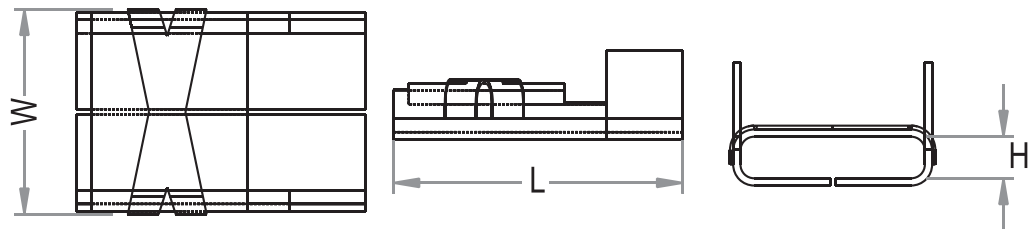

STAINLESS STEEL CLIP

Aftec Stainless Steel Clips are designed to use with all kinds of bands coated and uncoated.

Technical Data

Material : SS 316 L non-magnetic stainless steel.

MODEL NO.	WIDTH	LENGTH	HEIGHT	STD. QTY/ BAG
	W	L	H	
	MM	MM	MM	
ASSC-9U	12	16	4.05	100 PCS
ASSC-13U	15	23.3	3.9	
ASSC-16U	18	27.92	3.9	
ASSC-19U	22.0	29.28	3.9	



AFTEC Cable Markers are ECM TYPE Flexible PVC Markers for Cables between 1.0 mm to 25mm diameter suitable for all types of Industrial and Electrical Applications.

AFTEC Cable Markers are made of Soft PVC in Concave Converted shape and number coded with the following markings.

0-9, A-Z, + (plus), (-) Minus, Oblique, Earth, Blank.

Aftec Cable Markers have operational service temperature of -40°C to +85°C.

Aftec Cable markers are Resistant to Sea Water, Detergents, Fuels, Oils and Spirits and are Erosion Controlled.

AFTEC Cable Markers are suitable for any Size, Any Special Lengths and the inside are hollow and elastic.

CABLE MARKER

Aftec cable markers are flexible pvc marker for cables between 0.5mm² to 10mm². Chevron cut design ensures that markers stay locked to each other and doesn't allow to rotate and maintain entire identification in one line.

Technical Data

Application : For wire identification in electrical & electronic wires and are resistant to sea water, detergents, fuels, oil and spirits.

Material : Soft P.V.C

Temperature range : - 40°C to +85°C.

Color : Yellow & White with Black marking.

Marking : 0-9, A-Z, + (Plus), - (Minus), / (Oblique), (Earth) ⊥ Blank.

Z-TYPE CABLE MARKERS

MODEL NO	WIRE SIZE	IN DIAMETER	LENGTH	MARKERS	PACKING/BOX
	mm ²	MM	MM		
ACM 0	0.5 to 0.75	1.8 to 2.2	6712	A to Z, 0-9, +, -, /, ⊥	1500 Nos
ACM 1	1.0 to 2.5	3.2 to 3.8	4445	A to Z, 0-9, +, -, /, ⊥	1000 Nos
ACM 2	2.5 to 6.0	4.5 to 5.2	2810	A to Z, 0-9, +, -, /, ⊥	500 Nos
ACM 3	6.0 to 10.0	5.5 to 6.8	1830	A to Z, 0-9, +, -, /, ⊥	350 Nos

K-TYPE CABLE MARKERS

MODEL NO	WIRE SIZE	IN DIAMETER	LENGTH	MARKERS	PACKING/BOX
	mm ²	MM	MM		
ACM K	4.0 to 10.0	4.0 to 7.0	2650	A to Z, 0-9, +, -, /, ⊥	500 Nos

CARRIER STRIPS

Aftec Carrier strips are used with ties up to width of 4.8 mm

Technical Data

Application : To mark cable bundles for permanent identification with aftec k type cable marker

Material : Nylon

Temperature range : - 40°C to +85°C.

Color : Black

MODEL NO.	WIDTH	LENGTH		MAX CAPACITY MARKERS PER STRIP	STANDERED QUANTITY PER BAG
	W	L			
	MM	INCH	MM		
AMS 65	9	2.6	65	7	100
AMS100	9	4.0	100	12	
AMS 135	9	5.4	135	18	



Aftec is a leading manufacturer of cable glands, Cable Connectors and associated accessories, used extensively for power control, lighting and instrumentation cable application in connection with IEC and NEC Cables.

Having the widest range of cable glands products to meet every kind of requirement for use in marine, Industrial and Non(Industrial)Areas.



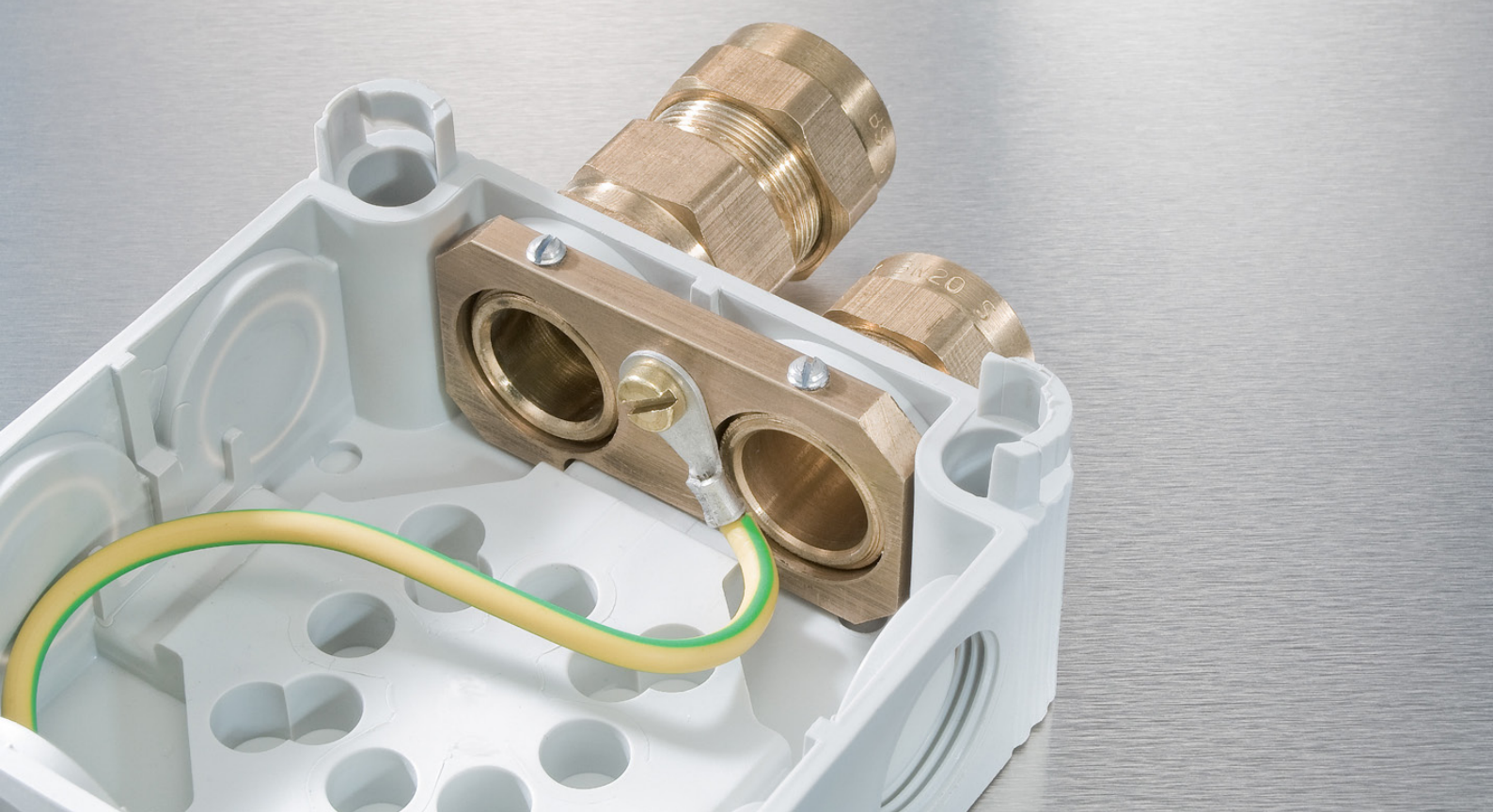

CABLE GLAND AND CLEATS SELECTOR CHART FOR PVC/ SWA/PVC & XLPE/ SWA/ PVC 600/ 1000 VOLT POWER CABLES						
CONDUCTOR AREA mm ²	NO OF CORES	BW INDOOR GLANDS	CW OUTDOOR GLANDS	E1 W DOUBLE COMPRESSION GLANDS	SINGLE BOLT CLEAT	DOUBLE BOLT CLEAT
1.5	2	20S	20S	20S	ASBC-AA	-
	3	20S	20S	20S	ASBC-AA	-
	4	20S	20S	20S	ASBC-AB	-
	7	20S	20S	20S	ASBC-AC	-
	12	25	25	25	ASBC-AD	-
	19	25	25	25	ASBC-AE	-
	27	32	32	32	ASBC-AF	-
	37	32	32	32	ASBC-AF	-
2.5	2	20S	20S	20S	ASBC-AB	-
	3	20S	20S	20S	ASBC-AB	-
	4	20S	20S	20S	ASBC-AB	-
	7	20	20	20	ASBC-AC	-
	12	25	25	25	ASBC-AD	-
	19	32	32	32	ASBC-AE	-
	27	32	32	32	ASBC-AF	-
	37	40	40	40	ASBC-AG	-
4	2	20S	20S	20S	ASBC-AB	-
	3	20S	20S	20S	ASBC-AB	-
	4	20	20	20	ASBC-AC	-
	7	25	25	25	ASBC-AD	-
	12	25	25	25	ASBC-AE	-
	19	32	32	32	ASBC-AF	-
	27	40	40	40	ASBC-AG	-
	37	40	40	40	ASBC-AH	-
6	2	20S	20S	20S	ASBC-AB	-
	3	20	20	20	ASBC-AC	-
	4	20	20	25	ASBC-AD	-
10	2	20	20	20	ASBC-AC	-
	3	25	25	25	ASBC-AD	-
	4	25	25	25	ASBC-AD	-
16	2	25	25	25	ASBC-AD	-
	3	25	25	25	ASBC-AD	-
	4	25	25	25	ASBC-AE	-
25	2	25	25	25	ASBC-AE	-
	3	32	32	32	ASBC-AE	-
	4	32	32	32	ASBC-AF	-

CABLE GLAND AND CLEATS SELECTOR CHART FOR						
PVC/ SWA/PVC & XLPE/ SWA/ PVC 600/ 1000 VOLT POWER CABLES						
CONDUCTOR AREA	NO OF CORES	BW INDOOR GLANDS	CW OUTDOOR GLANDS	E1 W DOUBLE COMPRESSION GLANDS	SINGLE BOLT CLEAT	DOUBLE BOLT CLEAT
mm ²						
35	2	32	32	32	ASBC-AF	-
	3	32	32	32	ASBC-AF	-
	4	32	32	32	ASBC-AF	-
50	2	25	25	25	ASBC-AE	-
	3	32	32	32	ASBC-AF	-
	4	32	32	32	ASBC-AF	-
70	2	32	32	32	ASBC-AF	-
	3	32	32	32	ASBC-AF	-
	4	40	40	40	ASBC-AG	-
95	2	32	32	32	ASBC-AG	-
	3	40	40	40	ASBC-AG	-
	4	50S	50S	50S	ASBC-AH	-
120	2	40	40	40	ASBC-AG	-
	3	40	40	40	ASBC-AG	-
	4	50S	50	50	ASBC-AH	-
150	2	40	40	40	ASBC-AG	-
	3	50S	50S	50S	ASBC-AH	-
	4	50	50	50	-	ATBC-AA
185	2	50S	50S	50S	ASBC-AH	-
	3	50	50	50	ASBC-AH	-
	4	63S	63S	63S	-	ATBC-AA
240	2	50	50	50	ASBC-AH	-
	3	63S	63S	63S	-	ATBC-AA
	4	63	63	63	-	ATBC-AC
300	2	50	63S	63S	-	ATBC-AA
	3	63S	63	63	-	ATBC-AB
	4	75S	75S	75S	-	ATBC-AD
400	2	63S	63S	63S	-	ATBC-AB
	3	63	63	63	-	ATBC-AC
	4	75	75	75	-	ATBC-AE
630	2	50S	50S	50S	ASBC-AH	-
	1	50	50	50	-	ATBC-AA

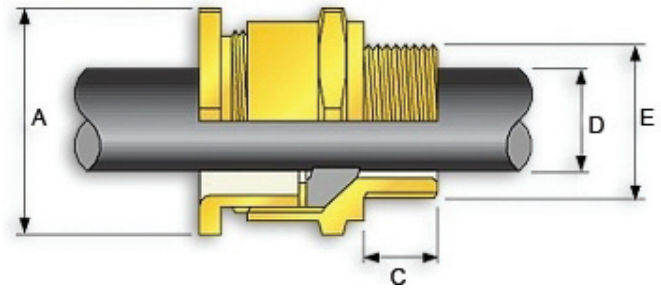

A2 UNARMOUR GLANDS

Aftec A2 brass industrial cable glands can be used for unarmoured cables for Indoor & Outdoor applications. It provides a weather proof, seal on outer insulation.

Technical Data

Standard : Designed to BS 6121 Part 1:1987 EN 50262: 1999.
 Ingress Protection : IP 66, IP 67, IP 68
 Operating Temperature : -60°C to + 150°C
 Material Available : Brass, Brass NP, Stainless Steel, Aluminum

MODEL NO.	METRIC ENTRY THREAD	MINIMUM THREAD LENGTH	CABLE DIA MAX		MAX ACROSS COR- NERS DIA	PVC SHROUD
			D			
	E	C	MIN	MAX	A	
A2 20/16	20	15	3.1	8.6	26	A20/16
A2 20S	20	15	6.1	11.6	26	A20S
A2 20	20	15	6.5	13.9	30	A20
A2 25S	25	15	8.8	17.0	39.5	A25S
A2 25	25	15	11.1	19.9	39.5	A25
A2 32	32	15	17.0	26.2	45	A32
A2 40	40	15	22.0	32.1	53.5	A40
A2 50S	50	15	29.5	38.1	66	A50S
A2 50	50	15	35.6	44.0	66.25	A50
A2 63S	63	15	40.1	49.9	75	A63S
A2 63	63	15	47.2	55.9	81.5	A63
A2 75S	75	15	52.8	61.9	90	A75S
A2 75	75	15	59.1	67.9	98	A75
A2 90	90	21	66.6	79.3	115	A90

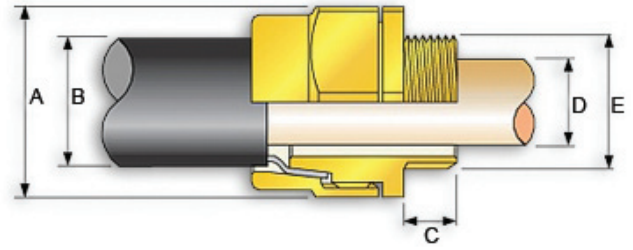

ABW ARMOUR GLANDS

Aftec BW brass industrial cable glands can be used for single wire armoured cables for Indoor applications. It provides earth continuity through armour wire termination.

Technical Data

Standard : Designed to BS 6121 Part 1:2005 En 12168.

Material available : Brass, Brass NP, Stainless Steel, Aluminum

MODEL NO.	METRIC ENTRY THREAD E	MINIMUM THREAD LENGTH C	CABLE DIA MAX D		MAX ACROSS CORNERS DIA A	ARMOUR WIRE DIA	PVC SHROUD
			MIN	MAX			
BW 20S	20	9.5	11.6	16.1	23.25	0.9/1.25	B20S
BW 20	20	9.5	13.9	21.1	27.35	0.9/1.25	B20
BW 25S	25	9.5	17.8	27.4	37.5	1.25/1.6	B25S
BW 25	25	9.5	19.9	27.4	37.5	1.25/1.6	B25
BW 32	32	9.5	61.9	76.2	45	1.6/2	B32
BW 40	40	14.5	61.9	76.2	54	1.6/2	B40
BW 50S	50	14.5	61.9	76.2	67.5	2/2.25	B50S
BW 50	50	14.5	61.9	76.2	71	2/2.5	B50
BW 63S	63	14.5	61.9	76.2	83	2.5	B63S
BW 63	63	14.5	61.9	76.2	86	2.5	B63
BW75S	75	14.5	61.9	76.2	99	2.5	B75S
BW75	75	14.5	61.9	82.9	106	2.5/3.15	B75

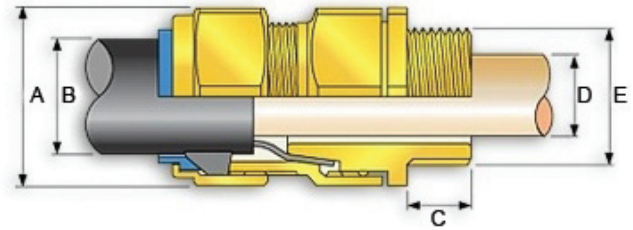
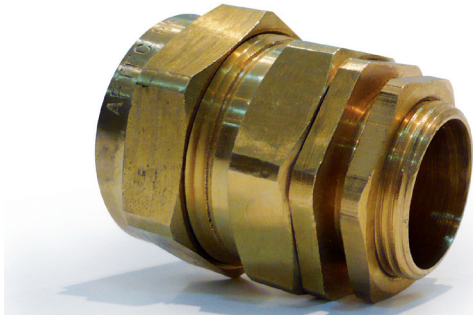

ACW ARMOUR GLANDS

Aftec CW brass single compression industrial cable glands can be used for single wire armoured cables for Indoor & Outdoor applications. It provides earth continuity through armour wire termination & a weather proof, seal on the outer insulation. Universal clamping ring on the armour clamp allows the disconnection of the equipment from the cable easily.

Technical Data

Standard : Designed to BS 6121 Part 1:1987 EN 50262: 1999.
 Ingress Protection : IP 66, IP 67, IP 68
 Operating Temperature : -60°C to + 150°C
 Material available : Brass, Brass NP, Stainless Steel, Aluminum

MODEL NO.	METRIC ENTRY THREAD	MINIMUM THREAD LENGTH	CABLE DIA MAX	CABLE DIA B		MAX ACROSS CORNERS DIA	ARMOUR WIRE DIA	PVC SHROUD
	E	C	D	MIN	MAX	A		
CW 20/16	20	15	8.6	8.0	13.4	25	0.90	C20/16
CW 20S	20	9.5	11.6	11.4	15.9	26.8	0.9/1.25	C20S
CW 20	20	9.5	13.9	16.0	20.9	30.5	0.9/1.25	C20
CW 25S	25	9.5	17.8	22.0	27.4	40.8	1.25/1.6	C25S
CW 25	25	9.5	19.9	22.0	27.4	40.8	1.25/1.6	C25
CW 32	32	9.5	26.2	26.0	33.9	51	1.60/2.00	C32
CW 40	40	14.5	32.1	31.0	40.0	59	1.60/2.00	C40
CW 50S	50	14.5	38.1	36.0	46.7	67	2.00/2.50	C50S
CW 50	50	14.5	44.0	44.0	53.1	78.5	2.00/2.50	C50
CW 63S	63	14.5	50.0	48.9	59.4	84.5	2.50	C63S
CW 63	63	14.5	55.9	58.0	65.9	88.5	2.50	C63
CW 75S	75	14.5	61.9	60.6	72.1	98	2.50	C75S
CW 75	75	14.5	67.9	64.9	78.5	108	2.5/3.15	C75
CW 90	90	15	79.3	76.0	90.4	120	3.15	C90

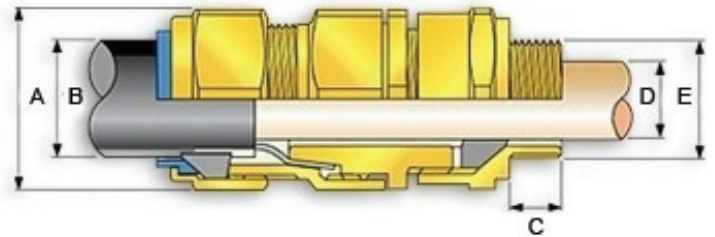
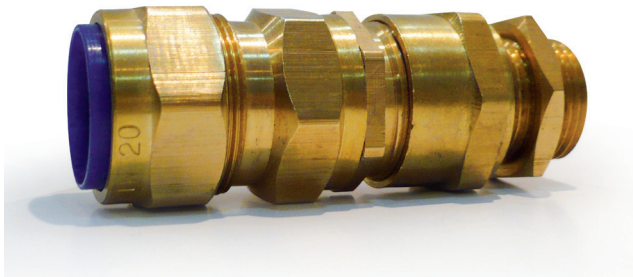

E1W ARMOUR GLANDS

Aftec E1W brass double compression industrial cable glands can be used for single wire armoured cables for Indoor & Outdoor applications. It provides earth continuity through armour wire termination & a weather proof, seal on the Inner & Outer insulation. Universal clamping ring on the armour clamp allows the disconnection of the equipment from the cable easily.

Technical Data

Standard : Designed to BS 6121 Part 1:1987 EN 50262: 1999.

Ingress Protection : IP 66, IP 67, IP 68

Operating Temperature : -60°C to + 150°C

Material available : Brass, Brass NP, Stainless Steel, Aluminum

MODEL NO.	METRIC ENTRY THREAD	MINIMUM THREAD LENGTH	CABLE DIA		CABLE DIA		MAX ACROSS CORNERS DIA	ARMOUR WIRE DIA	PVC SHROUD
			D		B				
	E	C	MIN	MAX	MIN	MAX	A		
E1W 20/16	20	15	3.1	8.6	8.0	13.4	26	0.90	E20/16
E1W 20S	20	15	6.1	11.6	11.4	15.9	26.8	0.9/1.25	E20S
E1W 20	20	15	6.5	13.9	16.0	20.9	30.5	0.9/1.25	E20
E1W 25S	25	15	8.8	17.8	22.0	27.4	40.8	1.25/1.6	E25S
E1W 25	25	15	11.1	19.9	22.0	27.4	40.8	1.25/1.6	E25
E1W 32	32	15	17.0	26.2	26.0	33.9	51	1.60/2.00	E32
E1W 40	40	15	22.0	32.1	31.0	40.0	59	1.60/2.00	E40
E1W 50S	50	15	29.5	38.1	36.0	46.7	67	2.00/2.50	E50S
E1W 50	50	15	35.6	44.0	44.0	53.1	78.5	2.00/2.50	E50
E1W 63S	63	15	40.1	49.9	48.9	59.4	84.5	2.50	E63S
E1W 63	63	15	47.2	55.9	58.0	65.9	88.5	2.50	E63
E1W 75S	75	15	52.8	61.9	60.6	72.1	98	2.50	E75S
E1W 75	75	15	59.1	67.9	64.9	78.5	108	2.5/3.15	E75
E1W 90	90	21	66.6	79.3	76.0	90.4	120	3.15	E90

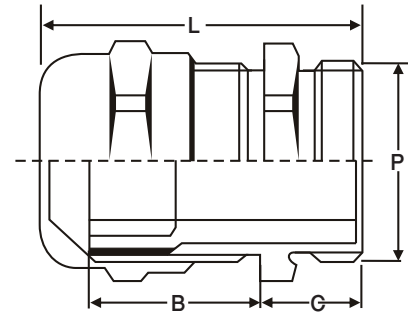

PG GLANDS BRASS NICKLE PLATED

Aftec PG Brass Nickel Plated Cable Glands Can be used for Unarmoured Cable for indoor and outdoor Application.

Technical Data

Standard : Designed to BS 6121 Part 1:1987 EN 50262: 1999.
 Ingress Protection : IP 66, IP 67, IP 68
 Operating Temperature : -10° C to + 90° C
 Material Available : Brass Nickel Plated

MODEL NO.	PITCH	THREAD DIA	CABLE RANGE		B	C	LENGTH		QUANTITY
			MIN-MAX				MIN-MAX		
			P	A			L		
			MM	MM			MM		
APG 7 NP	1.27	12.5	3.5-7	14	5	14-19		100	
APG 9 NP	1.41	15.5	4-8	17	6	17-23			
APG 11 NP	1.41	19	4.5-10	20	6	20-25			
APG 13.5 NP	1.41	20.5	5-12	22	6.5	20-26			
APG 16 NP	1.41	22.5	7-13	24	6.5	20-27			
APG 21 NP	1.59	29	10-17	30	7	25-32			
APG 29 NP	1.59	37	18-25	39	8	33-40			
APG 36 NP	1.59	47	20-32	50	8	43-50			
APG 42 NP	1.59	54	28-38	57	9	50-57			
APG 48 NP	1.59	60	40-44	64	10	57-64			

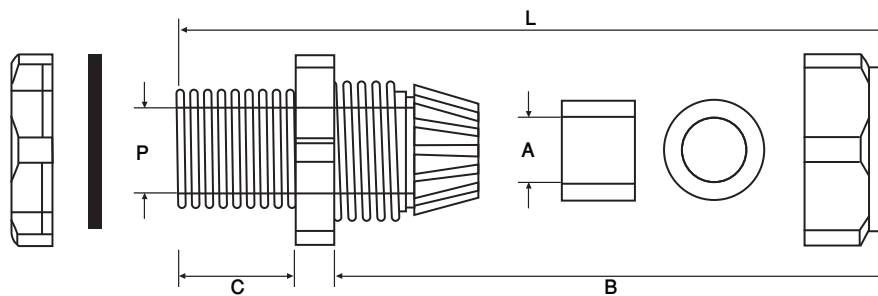

PG GLANDS

Aftec APG Polyamide glands can be used for circular unarmoured cables & wires for outdoor & indoor use.

Technical data

Material : Polyamide PA 6

Operating Temperature : -30°C to + 80°C

Ingress Protection : IP 54

Color : RAL 9000 White, RAL 9005 Black, RAL 7035 Grey.

MODEL NO.	PITCH	THREAD DIA	CABLE RANGE		B	C	LENGTH		QUANTITY
			MIN-MAX				MIN-MAX		
			A						
			MM					MM	
APG 7	1.27	12.5	3.5-7		15	8	18-22	100	
APG 9	1.41	15.5	5-8		19	8	22-26		
APG 11	1.41	19	5-10		22	8	23-28		
APG 13.5	1.41	20.5	7-12		24	9	24-29		
APG 16	1.41	22.5	10-14		27	10	26-31		
APG 21	1.59	29	13-18		33	12	30-35		
APG 29	1.59	37	18-25		42	12	33-39		
APG 36	1.59	47	20-32		53	14	42-49		
APG 42	1.59	54	28-38		60	14	42-50		
APG 48	1.59	60	40-44		65	15	42-50		

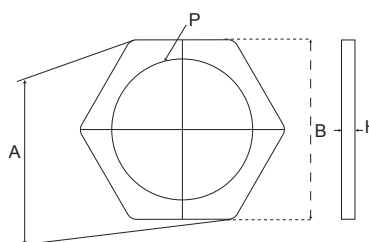
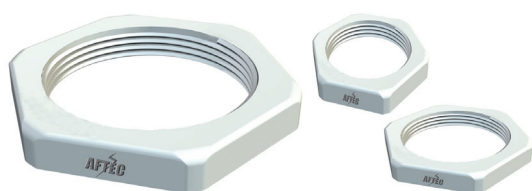

PG LOCKNUT

Secures a Gland in proper position, manufactured from polyamide

MODEL NO.	P	A	B	H	QUANTITY
		MM	MM	MM	
APG 7LN	7	21	19	5	100
APG 9LN	9	24	22	5	
APG 11LN	11	26	24	5	
APG 13.5LN	13.5	29	27	6	
APG 16LN	16	33	30	6	
APG 21LN	21	39	36	7	
APG 29LN	29	50	46	7	
APG 36LN	36	66	60	8	
APG 42LN	42	73	65	8	
APG 48LN	48	78	70	8	

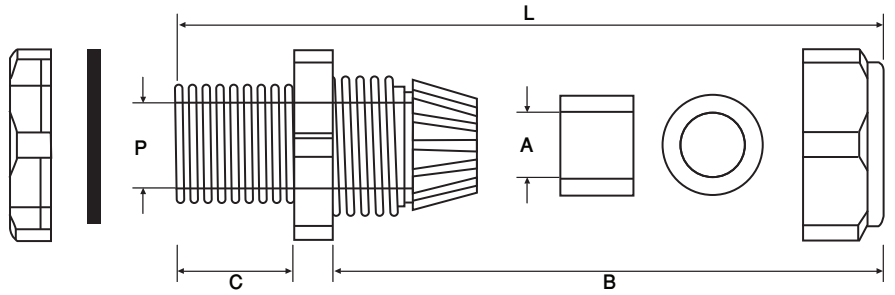

METRIC GLANDS

Aftec AMM Polyamide glands can be used for circular unarmoured cables & wires for outdoor & indoor use.

Technical data:

Material : Polyamide PA 6
 Operating Temperature : -30°C to + 80°C
 Ingress Protection : IP 54
 Color : RAL 9005 Black

MODEL NO.	PITCH	THREAD DIA P MM	CABLE RANGE		B MM	C MM	LENGTH	QUANTITY
			MIN-MAX				MIN-MAX	
			A	MM			L	
AMM16	1.5	16.5	5-10	19	8	22-27	100	
AMM20	1.5	20.5	7-13	25	9	24-30		
AMM25	1.5	25.5	10-17	30	10	28-39		
AMM32	1.5	32.5	13-21	36	10	33-44		
AMM40	1.5	40.5	19-28	46	10	36-45		
AMM50	1.5	50.5	27-35	55	12	43-52		
AMM63	1.5	63.5	34-45	66	12	45-55		

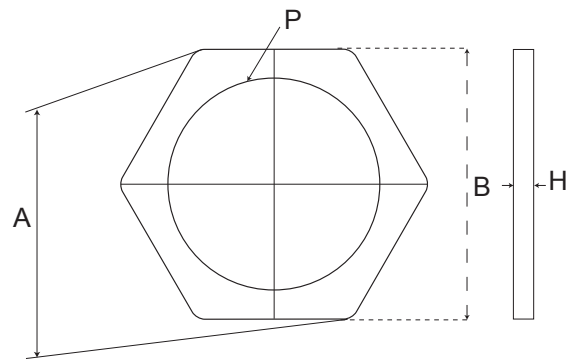
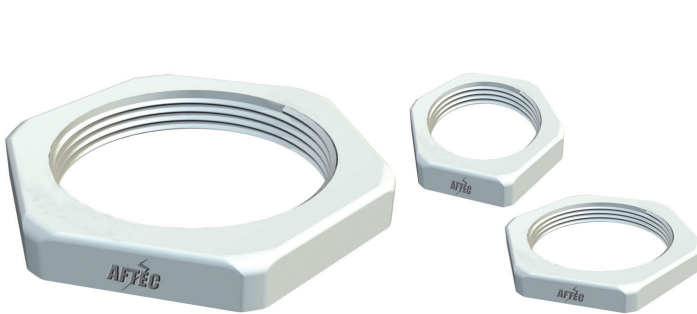

METRIC LOCKNUT

Secures a Gland in proper position, manufactured from polyamide

MODEL NO.	P	A	B	H	QUANTITY
		MM	MM	MM	
AMM16LN	M16	24	22	5	100
AMM20LN	M20	29	27	6	
AMM25LN	M25	35.5	32	6	
AMM32LN	M32	45	41	7	
AMM40LN	M40	55	50	7	
AMM50LN	M50	65	60	8	
AMM63LN	M63	82	75	8	



BRASS LOCK NUT

Secures a Cable Gland in proper position. Heavy duty hex lock is manufactured from brass.

MODEL NO.	A/F	THICKNESS
20MM	24.00	3.25
25MM	29.75	3.25
32MM	37.00	4.00
40MM	45.75	4.50
50MM	57.50	5.00
63MM	71.50	5.00
75MM	84.50	6.00



EARTH TAG

Provide earth continuity to the Cable Gland.

MODEL NO.	O.D	LENGTH
16MM	24.00	43.50
20MM	29.10	47.75
25MM	36.95	57.50
32MM	43.80	69.15
40MM	52.40	78.00
50MM	64.25	90.60
63MM	79.60	116.90
75MM	96.30	133.80

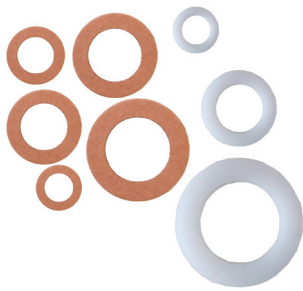

NYLON WASHER & FIBRE WASHER
To maintain proper ingress protection.

MODEL NO.	O.D	THICKNESS
20MM	24.00	1.5
25MM	29.75	
32MM	37.00	
40MM	45.75	
50MM	57.50	
63MM	71.50	
75MM	84.50	



SERRATED WASHER - SS316 L & SS304
To damper vibration of the cable gland, manufactured in stainless steel.

MODEL NO.	O.D	THICKNESS
20MM	24.00	1.5
25MM	29.75	
32MM	37.00	
40MM	45.75	
50MM	57.50	
63MM	71.50	
75MM	84.50	

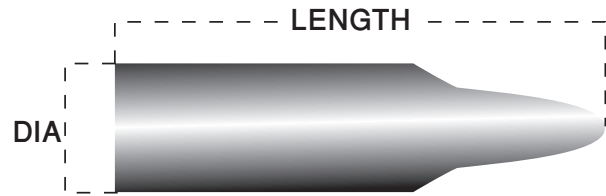

PVC SHROUD

To maintain additional environmental and corrosion protection.

MODEL NO	A2		BW		CW		E1W		ACW	
	DIA	LENGTH	DIA	LENGTH	DIA	LENGTH	DIA	LENGTH	DIA	LENGTH
20/16	26.0	80.0	20.5	80.0	27.0	94.5	27.0	102.0		
20S	26.0	80.0	23.5	82.0	27.0	94.5	27.0	102.0		
20	30.0	87.0	27.5	80.0	30.5	105.0	30.5	125.0		
25S	39.5	102.0	37.5	102.0	41.0	106.0	41.0	125.0		
25	39.5	102.0	37.5	102.0	41.0	106.0	41.0	125.0	42.0	106.0
32S					51.0	109.0				
32	45.0	103.0	45.0	98.0	51.0	109.0	51.0	125.0	52.0	109.0
40S					59.0	140.0				
40	53.5	98.0	54.0	103.0	59.0	140.0	59.0	160.0	62.0	140.0
50S	66.0	133.0	67.5	133.0	67.0	160.0	67.0	180.0	68.0	140.0
50	66.5	133.0	71.0	133.0	78.5	149.0	78.5	180.0	80.0	149.0
63S	75.0	150.0	83.0	152.0	84.5	180.0	84.5	200.0	84.0	180.0
63	81.5	152.0	86.0	152.0	88.5	180.0	88.5	200.0	92.0	180.0
75S	90.0	180.0	99.0	180.0	98.0	200.0	98.0	230.0		
75	98.0	180.0	106.0	180.0	108.0	225.0	108.0	255.0		
90	118.0	180.0	118.0	180.0	118.0	225.0				

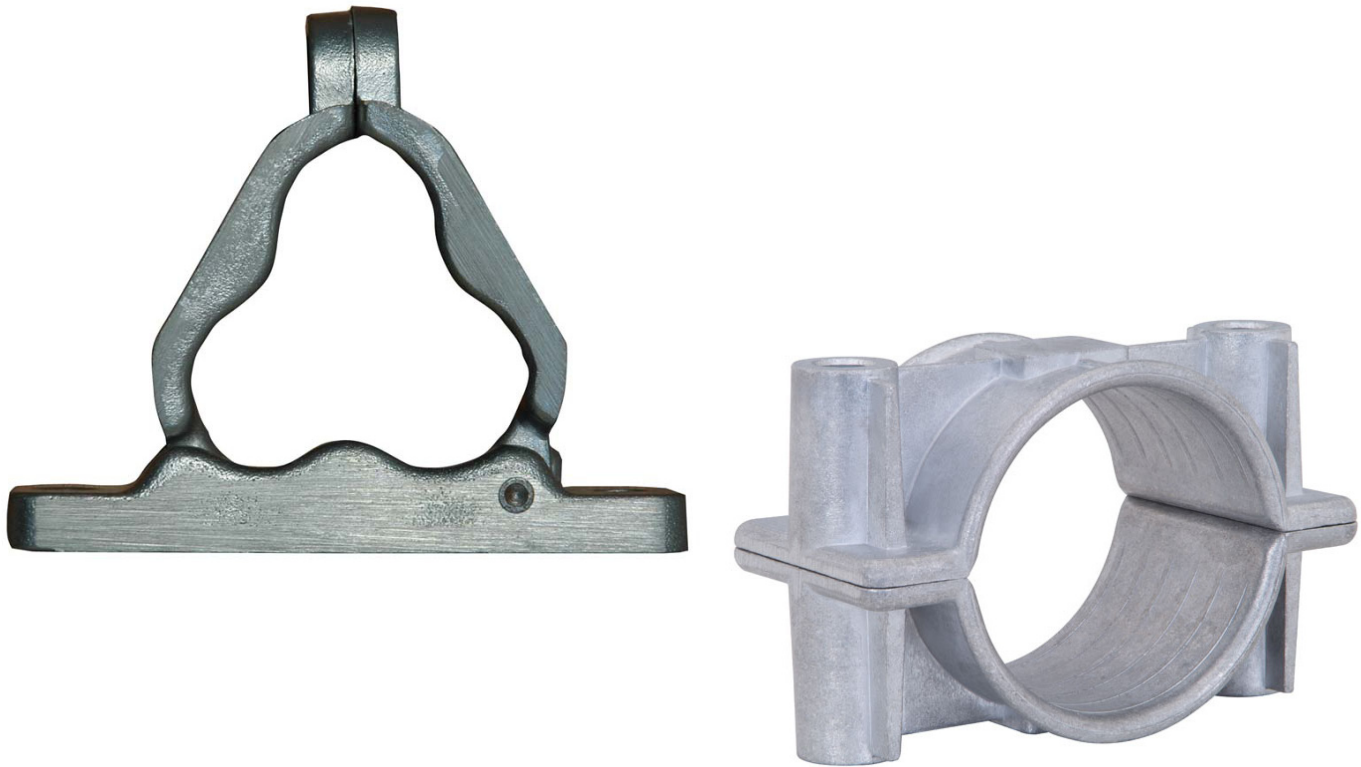

THE PURPOSE OF AFTEC CABLE CLEAT

The requirements of the IEE Wiring Regulations state that “Every cable or conductor used as a fixed wiring shall be supported in such a way that it is not exposed to undue mechanical strain, AFTEC Cable Cleats meet this requirement with the added bonus that they also enable a neat and orderly installation to be achieved.

A range of AFTEC Cable Cleats is available to fix cables to a variety of surfaces – including ladder, tray, channel, concrete or masonry. Design features include ease of installation, the ability to accept a wide range of cable diameters, compact proportions and the facility for either double or multi-stacked arrangements to save space. AFTEC Cable Cleats are made from various materials to suit the environment and to be compatible with the cable sheaths. In addition, they must be capable of resisting the mechanical loads of the system and of providing the necessary restraint if a short circuit fault were to occur within the system. Cleats satisfy all the above criteria, and items are available to suit the most hostile of environments. For example, certain cleats can withstand temperature excursions up to 1000°C for up to two hours.

All sizes of the more commonly used cables can be accommodated with most AFTEC Cable Clamps, offering a range-take capability second to none. For example, the AFTEC cleat range comprises just eight sizes, which both simplifies ordering and stocking, and also enables technicians to carry sufficient quantities of the various sizes around with them to enable the job to be completed quickly.

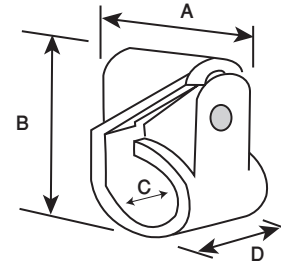

SINGLE BOLT CLEAT

Aftec single bolt cleat are one piece fixing cleat and also can be double stacked on one fixing. Its a fast, convenient way of cable installation. Cable cleats ranging from 10mm to 51mm cable dia in eight different sizes.

Technical Data

Material : Black Polypropylene
 Operating temperature : -20°C To +85°C

MODEL NO.	CABLE DIA - C (mm)		CLEAT DIMENSIONS(mm)				APPROX WEIGHT GMS
			A (mm)		B	D	
	MIN	MAX	Min	Max			
ASBC-AA	10	15	14	17	31	12	3
ASBC-AB	12	17	16	21	36	14	3.5
ASBC-AC	15	20	20	26	43	16	6
ASBC-AD	18	24	26	31	51	18	9
ASBC-AE	22	29	31	38	57	20	12.5
ASBC-AF	26	34	34	42	65	22	16.5
ASBC-AG	32	42	42	53	78	25	24.5
ASBC-AH	39	51	49	61	91	26	35.5

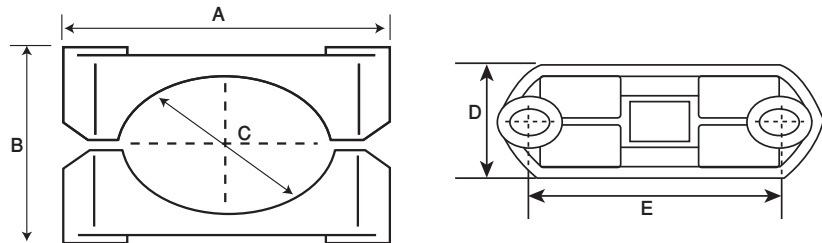

DOUBLE BOLT CLEAT

Aftec double bolt cleat are two piece fixing cleat and also can be double stacked on one fixing. Its a fast, convenient way of cable installation. Cable cleats ranging from 50mm to 94mm cable dia in seven different sizes.

Technical Data

Material : Black Polypropylene
 Operating temperature : -20°C To +85°C

MODEL NO.	CABLE DIA- C (mm)		CLEAT DIMENSIONS(mm)				APPROX WEIGHT GMS
			B	A	D	E	
	MIN	MAX					
ATBC-AA	50	59	89	103	45	80	95
ATBC-AB	55	64	92	101	45	80	100
ATBC-AC	61	70	97	114	45	92	110
ATBC-AD	68	76	103	113	50	92	135
ATBC-AE	73	81	111	127	50	104	155
ATBC-AF	79	87	119	125	50	104	160
ATBC-AG	85	93	121	136	60	114	205

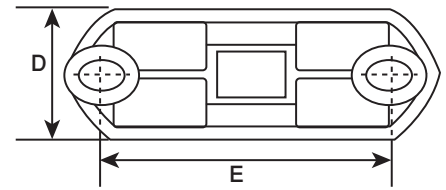
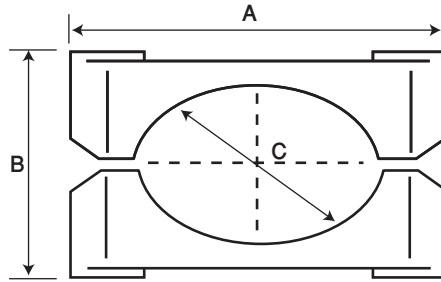

TWO BOLT ALUMINIUM CLEAT

Aftec two bolt two Aluminum cleats are manufactured from plain LM6 aluminum. Used to fix power cables in dry industrials or outdoor applications. Can be epoxy coated for use in harsh environments.

Technical Data

Material : Plain LM6 Aluminum
 Operating temperature : -40°C To +85°C

MODEL NO.	CABLE DIA- C (mm)		CLEAT DIMENSIONS(mm)				FIXING HOLE mm
	MIN	MAX	B	A	D	E	
AACC-AA	51	57	68	76	59	96	M10
AACC-AB	57	64	75	76	49	96	M10
AACC-AC	64	70	84	118	64	96	M10
AACC-AD	70	76	90	114	64	134	M10
AACC-AE	76	83	96	114	64	142	M12
AACC-AF	83	89	102	114	64	142	M12
AACC-AG	89	95	114	114	64	154	M12
AACC-AH	95	101	120	126	76	154	M12
AACC-AI	101	108	134	140	76	169	M12
AACC-AJ	108	114	140	140	76	169	M12

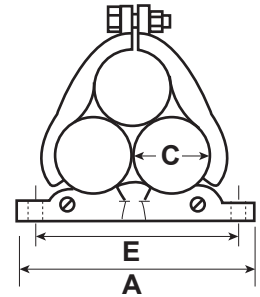
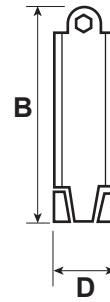
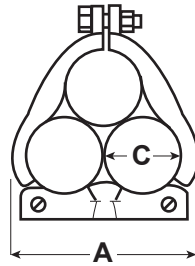

Trefoil Aluminium Cable Cleat

Aftec aluminum trefoil- cleats are manufacture from extracted aluminum to BS EN 755.

Robust to withstand harsh environment & heavy cable loads. And come with easy one bolt , two bolt holdings.

Technical Data

Material

: Plain LM6 Aluminum

Operating temperature

: -40°C To +85°C

MODEL NO SINGLE FIXING	MODEL NO DOUBLE FIXING	CABLE DIA- C (mm)		CLEAT DIMENSIONS(mm)				
		MIN	MAX	B	D	SINGLE FIXING		E
						A	A	
AATSC-AA	AATTC-AA	24	25	94	38	75	128	102
AATSC-AB	AATTC-AB	25	27	97	38	75	128	102
AATSC-AC	AATTC-AC	27	28	100	38	75	128	102
AATSC-AD	AATTC-AD	28	30	103	38	76	130	104
AATSC-AE	AATTC-AE	30	32	105	38	79	133	107
AATSC-AF	AATTC-AF	32	34	106	38	83	135	109
AATSC-AG	AATTC-AG	34	35	109	38	86	137	110
AATSC-AH	AATTC-AH	35	36	113	38	89	138	113
AATSC-AI	AATTC-AI	36	38	116	38	92	140	114
AATSC-AJ	AATTC-AJ	38	40	119	38	95	145	118
AATSC-AK	AATTC-AK	40	41	122	38	99	147	121
AATSC-AL	AATTC-AL	41	43	124	38	105	149	123
AATSC-AM	AATTC-AM	43	44	127	38	108	150	124
AATSC-AN	AATTC-AN	44	46	130	38	112	154	128
AATSC-AO	AATTC-AO	46	48	133	38	114	156	129
AATSC-AP	AATTC-AP	48	49	137	38	118	159	133
AATSC-AQ	AATTC-AQ	49	51	140	38	121	165	135
AATSC-AR	AATTC-AR	51	53	143	38	124	165	137
AATSC-AS	AATTC-AS	53	54	146	38	127	172	141
AATSC-AT	AATTC-AT	54	55.5	155	44	133	183	152
AATSC-AU	AATTC-AU	55.5	57	158	44	137	187	155
AATSC-AV	AATTC-AV	57	59	160	44	141	189	157
AATSC-AW	AATTC-AW	59	60	163	44	145	191	160
AATSC-AX	AATTC-AX	60	62	165	44	148	194	162
AATSC-AY	AATTC-AY	62	63.5	168	44	152	196	165
AATSC-AZ	AATTC-AZ	63.5	65	172	44	156	199	168
AATSC-AAA	AATTC-AAA	65	66.5	176	44	160	202	170
AATSC-ABB	AATTC-ABB	66.5	68	178	44	164	205	173
AATSC-ACC	AATTC-ACC	68	70	181	44	168	208	176
AATSC-ADD	AATTC-ADD	70	71.5	187	44	171	215	183
AATSC-AEE	AATTC-AEE	71.5	73	190	44	175	217	186
AATSC-AFF	AATTC-AFF	73	74.5	193	44	179	220	188
AATSC-AGG	AATTC-AGG	74.5	76	197	44	183	222	191



AFTEC INTERNATIONAL
P.O.Box: 146
Road Town, Tortola
British Virgin Islands
Tel : 1-284-4942434
Fax: 1-284-4943754
Email: Info@aftec.org.uk

www.aftec.org.uk